

PARTS LIST				
ITEM	QTY	PART NUMBER	DESCRIPTION	STOCK NUMBER
1	5	TB-200-595	2900 x 125 Safalog	COMTIMSAF0001
2	2	TB-200-596	2900 x 125 Safalog	COMTIMSAF0001
3	1	TB-200-597	2 X 3.6M X 125MM SAFALOG (BONDED)	COMTIMSAF0001
4	1	TB-200-598	2 X 3.425M X 125MM SAFALOG (BONDED)	COMTIMSAF0001
5	1	PE-400-083	SWING LEG COVER	COMPOL0007
6	1	SWC4 FLAT	SWING CHAIN	SUBSWISTR0001
7	1	SWC4 CRADLE	SWING CHAIN	COMSWISTRA0006
8	2	SW42 SWING FITTING	UNIVERSAL SWING FITTING	COMSWIHAN0007
9	2	SW8 SECURITY BOLT	SECURITY BOLT	COMSWIHAN0009
10	4	SW29 SWING FITTING	UNIVERSAL SWING FITTING	SUBSW29
11	1	BASKET SEAT	1000 STOCK BASKET SWING	COMSWISEA0007
12	1	FLAT SWING SEAT	LARGE SWING SEAT	COMSWISEA0001
13	1	CRADLE SWING SEAT	SW22 CRADLE SEAT	COMSWISEA0004
14	7	ART. 1500 1000 GROUND POST	GROUND SHOE	COMSTEMIS0020
15	14	M12 X 150 COACH BOLT	M10 X 150 (DIN 603)	COMHARSTA0013
16	7	M12 X 180 COACH SCREW	M12 X 180 COACH SCREW	COMSTASCR180
17	3	M12 X 220 COACH BOLT	M12 X 220 (DIN 603)	COMA2CBM12X220
18	2	M12 X 240 COACH BOLT	M12 x 240 (DIN 603)	COMA2CBM12X240
19	1	M12 X 430 T-BAR	430MM THREADED BAR	COMHARTHSTA001
20	32	M12 WASHER	M12 WASHER (DIN 125)	COMA2FWM12
21	25	M12 NYLOC NUT	M12 NYLOC NUT (DIN 985)	COMA2NNM12
22	4	M16 WASHER	M16 WASHER (DIN 125)	COMA2FWM16
23	4	M16 NYLOC NUT	M16 NYLOC NUT (DIN 985)	COMA2NNM16
24	12	30MM BOLT COVER	30MM BLACK CAP	COMPLACAP0001
25	8	38MM BOLT COVER	38MM CAP	COMPLACAP0016
26	16	2 PART CAP (BLACK)	TWO PART CAP	COMPLACAP0028
27	7	400 x 800 x 400	0.128M³ CONCRETE FOUNDATION	

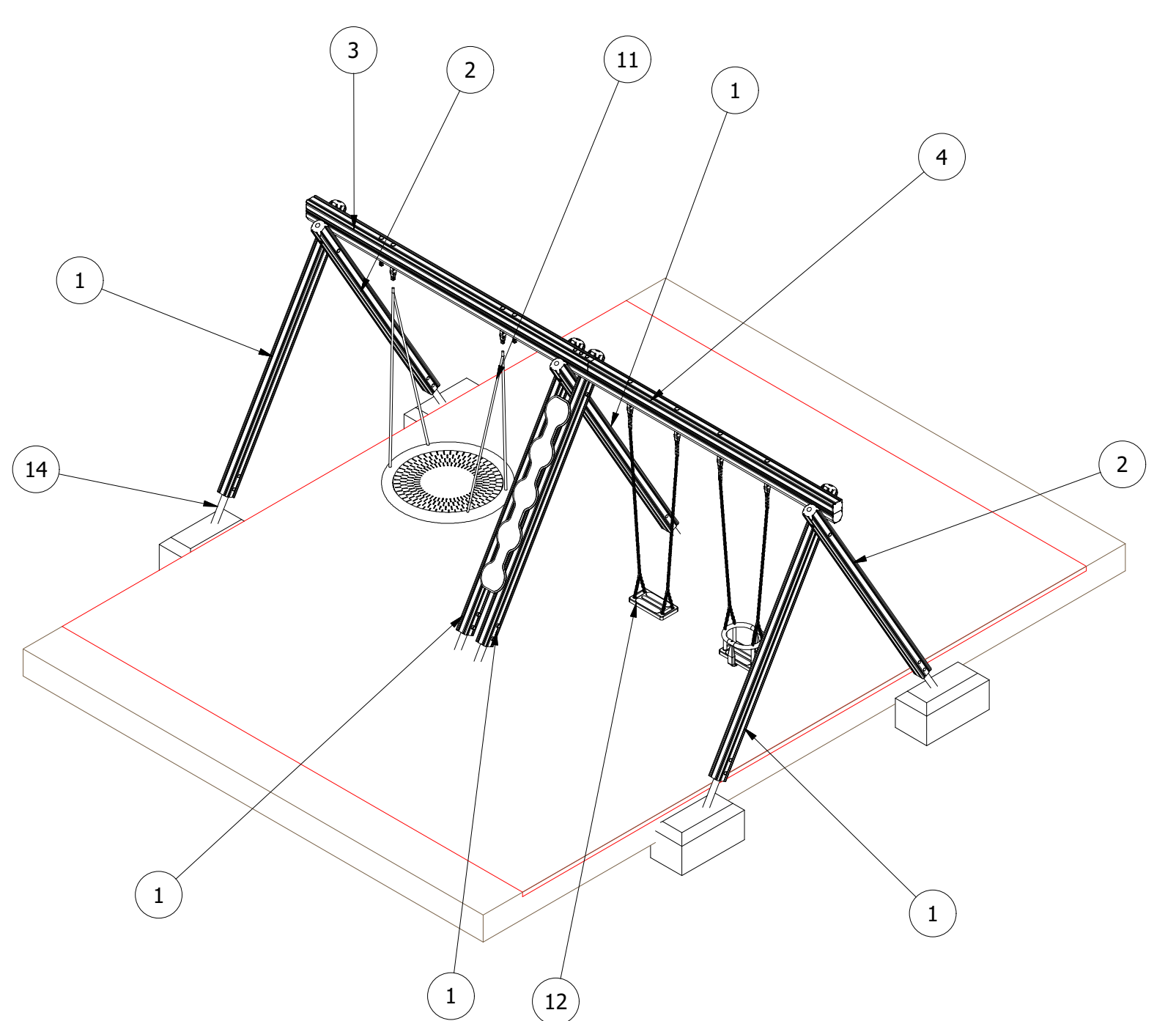
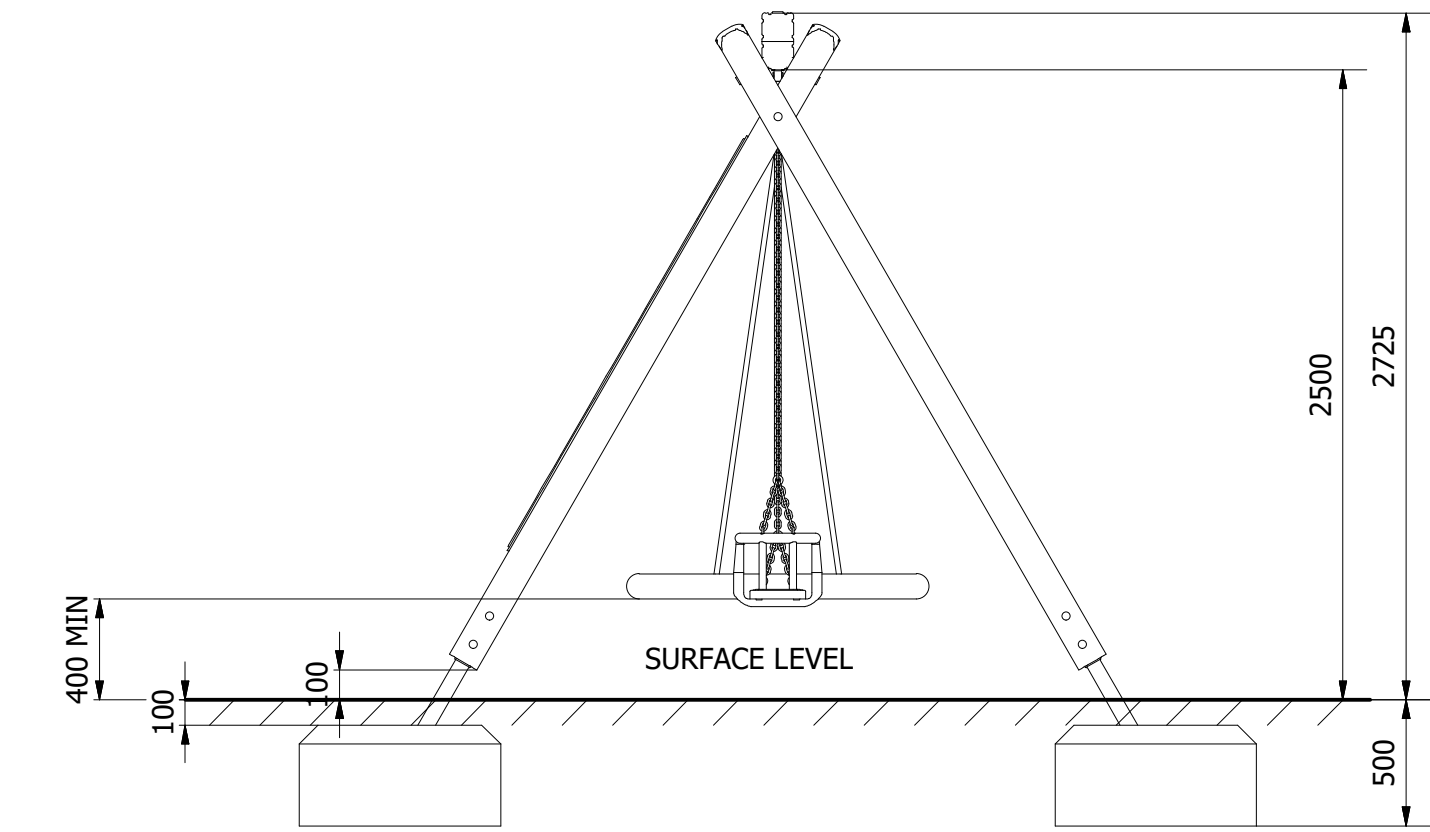

UNLESS OTHERWISE SPECIFIED:
DIMENSIONS ARE IN MILLIMETERS
TOLERANCES:
LINEAR: ±2MM
1 DECIMAL PLACE: ±0.5MM
ANGULAR: ±1°

PROPRIETARY AND CONFIDENTIAL
THE INFORMATION CONTAINED IN THIS
DRAWING IS THE SOLE PROPERTY OF
FENLAND LEISURE PRODUCTS. ANY
REPRODUCTION IN PART OR AS A WHOLE
WITHOUT THE WRITTEN PERMISSION
OF FENLAND
LEISURE PRODUCTS IS PROHIBITED.

Title: PRO-500-127 BASKET & FLAT SEAT SWING (MLF25)

Product Range: PLAYGROUND EQUIPMENT

<1.5M FFH

DO NOT SCALE FROM DRAWING

Tel: 01354 638359 www.onlineplaygrounds.co.uk

Date: 15/08/2019

Page: A3

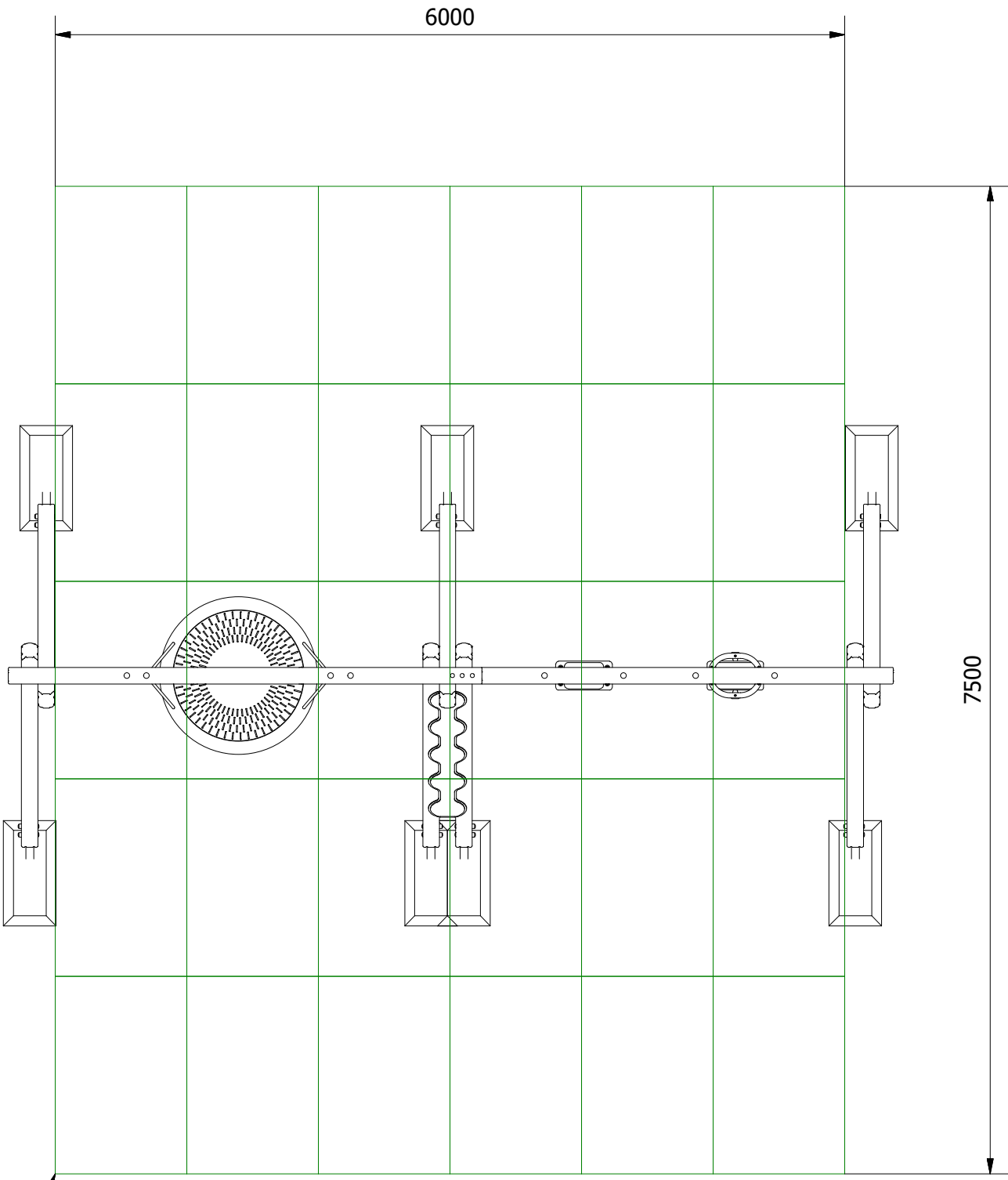
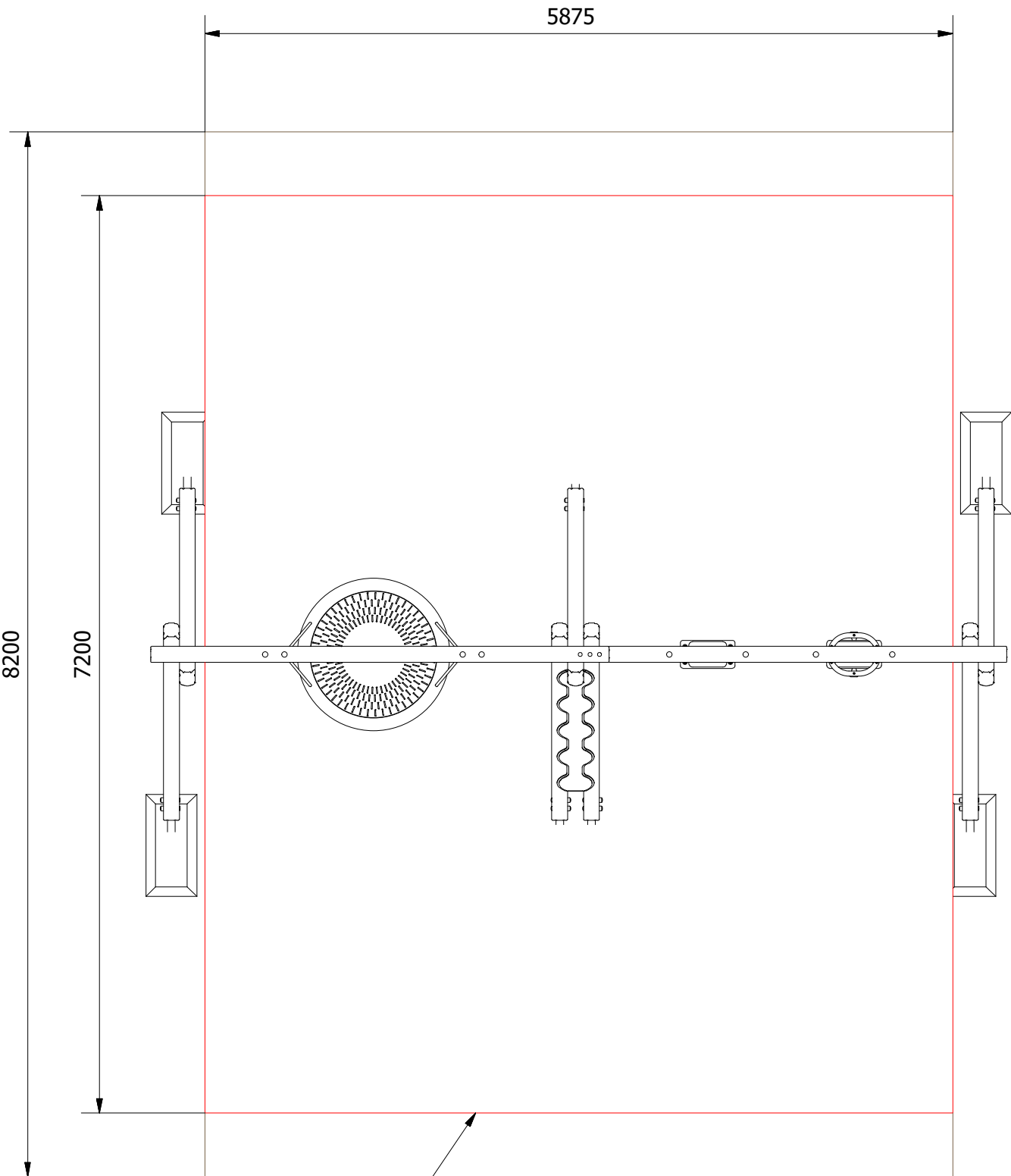

30 SAFAGRASS TILES (1.5M X 1.0M)

WETPOUR SURFACING
AREA = 42.2M²
PERIMETER = 26.2 L/M

LOOSEFILL SURFACING
AREA = 48.2M²
PERIMETER = 28.2 L/M

UNLESS OTHERWISE SPECIFIED: DIMENSIONS ARE IN MILLIMETERS TOLERANCES: LINEAR: ±2MM 1 DECIMAL PLACE: ±0.5MM ANGULAR: ±1°		PROPRIETARY AND CONFIDENTIAL THE INFORMATION CONTAINED IN THIS DRAWING IS THE SOLE PROPERTY OF FENLAND LEISURE PRODUCTS. ANY REPRODUCTION IN PART OR AS A WHOLE WITHOUT THE WRITTEN PERMISSION OF FENLAND LEISURE PRODUCTS IS PROHIBITED.		Title: PRO-500-127 BASKET & FLAT SEAT SWING (MLF25)	
		Product Range: PLAYGROUND EQUIPMENT		Date:	15/08/2019
		DO NOT SCALE FROM DRAWING		Page:	A3
				Tel: 01354 638359 www.onlineplaygrounds.co.uk	

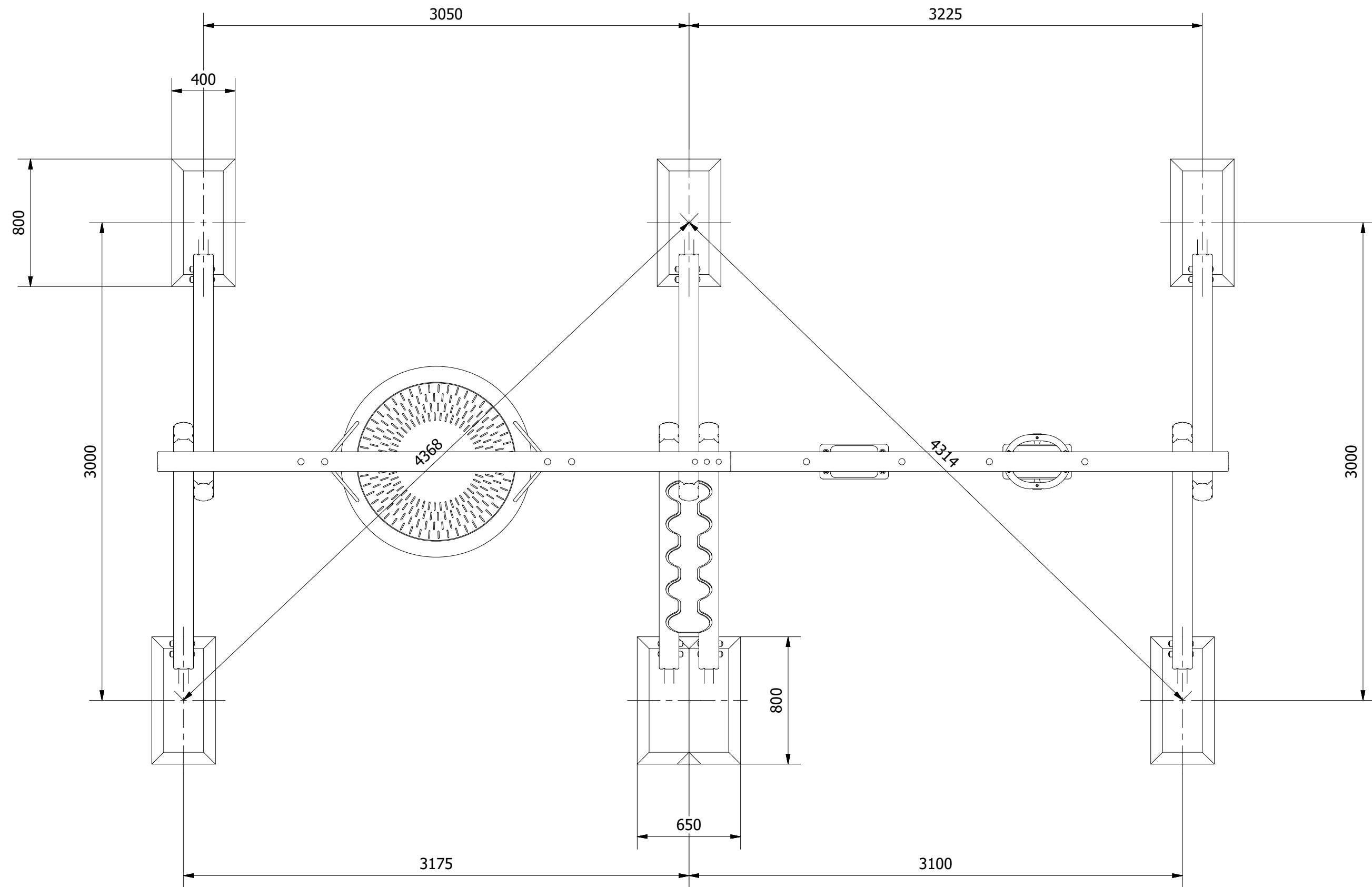

UNLESS OTHERWISE SPECIFIED: DIMENSIONS ARE IN MILLIMETERS TOLERANCES: LINEAR: ±2MM 1 DECIMAL PLACE: ±0.5MM ANGULAR: ±1°		PROPRIETARY AND CONFIDENTIAL THE INFORMATION CONTAINED IN THIS DRAWING IS THE SOLE PROPERTY OF FENLAND LEISURE PRODUCTS. ANY REPRODUCTION IN PART OR AS A WHOLE WITHOUT THE WRITTEN PERMISSION OF FENLAND LEISURE PRODUCTS IS PROHIBITED.		Title: PRO-500-127 BASKET & FLAT SEAT SWING (MLF25)	
		Product Range: PLAYGROUND EQUIPMENT		Date:	15/08/2019
		DO NOT SCALE FROM DRAWING		Page:	A3
				Tel: 01354 638359 www.onlineplaygrounds.co.uk	

ALL FOUNDATIONS 400 X 800 X 500 DEEP UNLESS OTHERWISE SPECIFIED

1. CREATE THE TWO SWING A-FRAMES USING THE SUPPLIED FIXINGS AS ILLUSTRATED BELOW.

NOTE: TO REDUCE THE RISK OF STEEL GALLING, USE LUBRICANT ON ALL STAINLESS STEEL FIXINGS

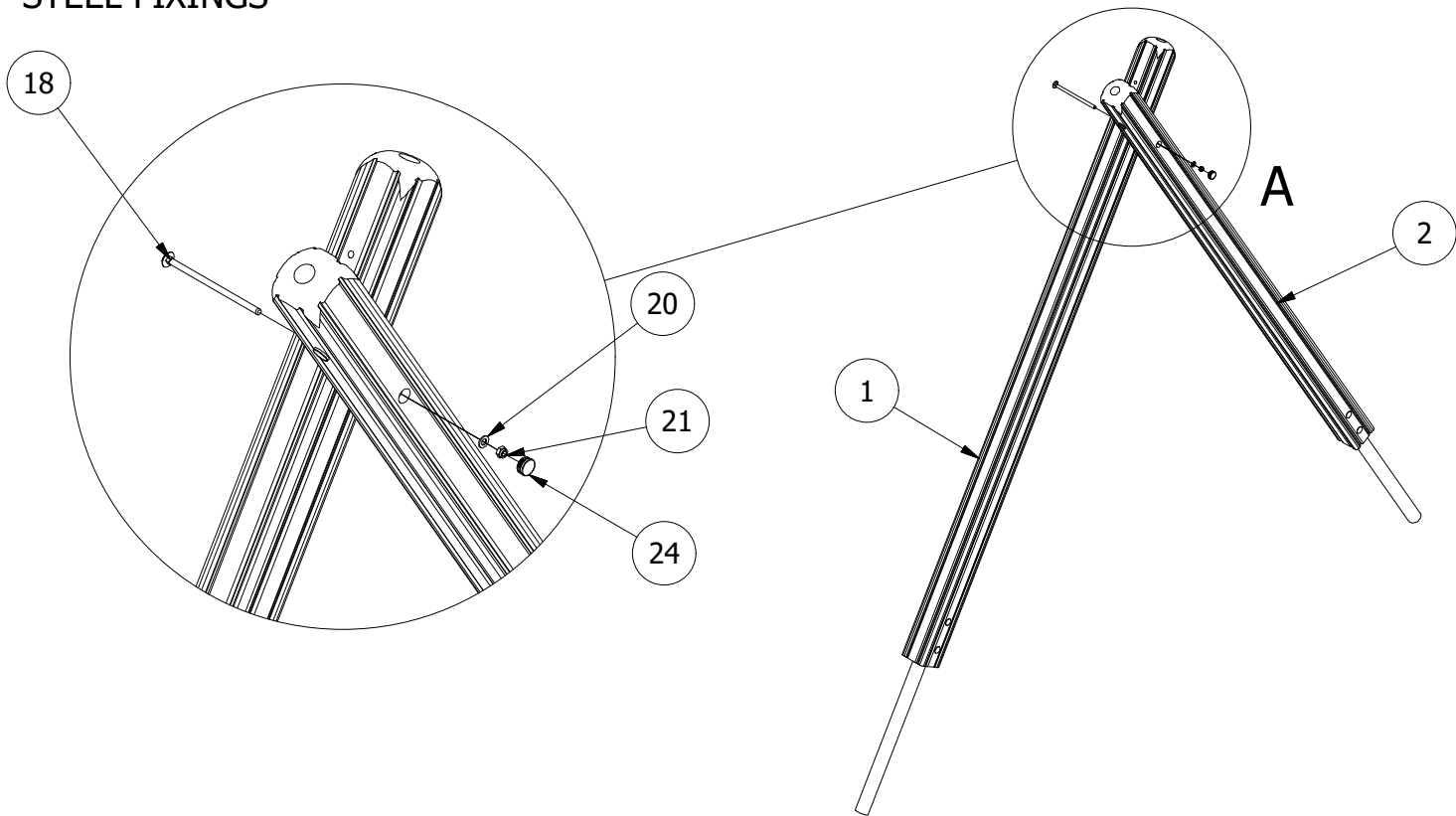

2. POSITION THE A-FRAMES INTO THE FOUNDATION HOLES AND BRACE. (TAKE NOTE OF THE POSITION OF THE POSTS AS SHOWN IN FIG 1) POSITION THE TOP BAR ONTO THE A-FRAMES AND SECURE IN PLACE.

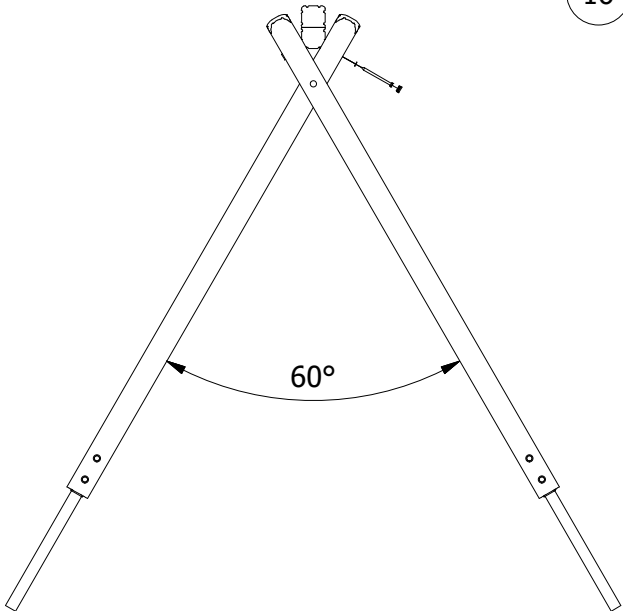
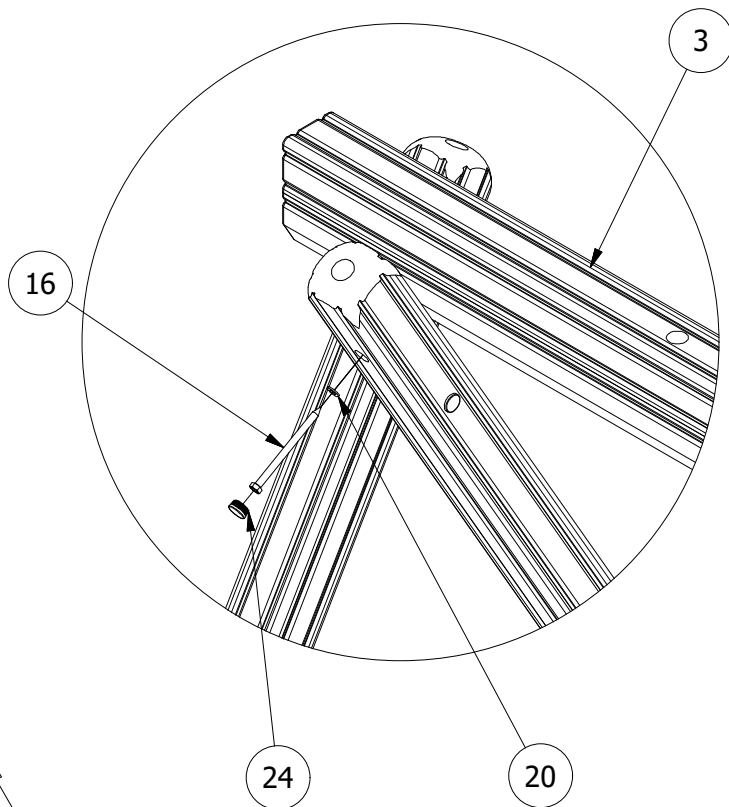

3. AS ILLUSTRATED BELOW, THE TOP CROSSBAR IS SUPPLIED IN TWO PARTS. SECURE THE TWO PARTS TOGETHER AND ATTACH BOTH END A-FRAMES.

FOR THE CENTRAL SUPPORT A-FRAME, USE THE BELOW ILLUSTRATION TO BUILD THE CENTRAL SECTION, POSITION IN PLACE AND SECURE TO THE TOP BEAM.

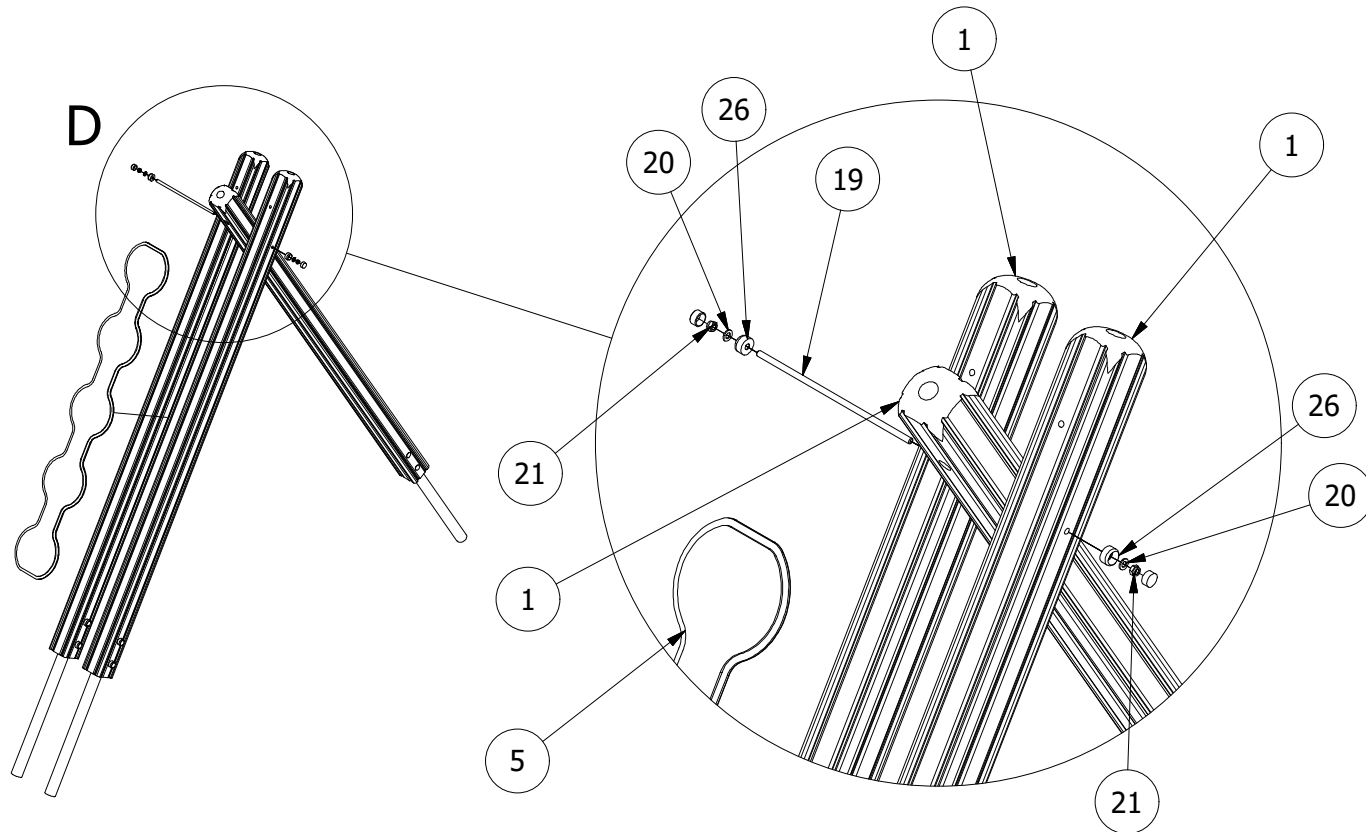
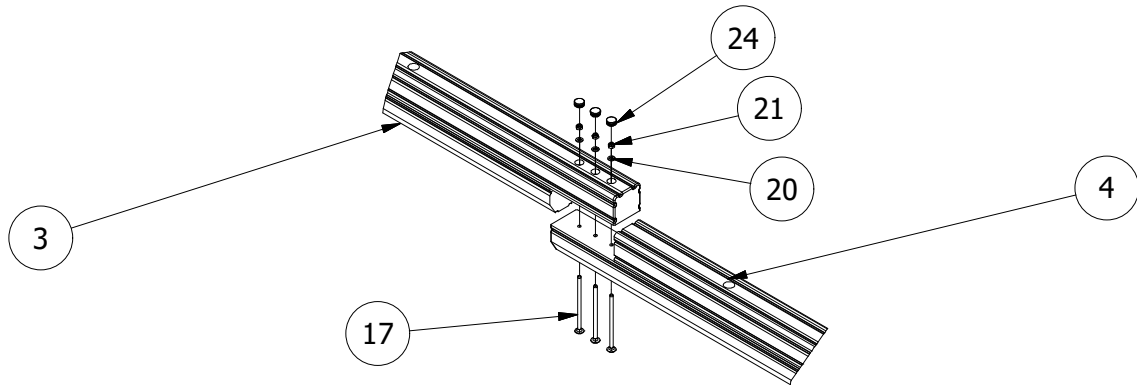
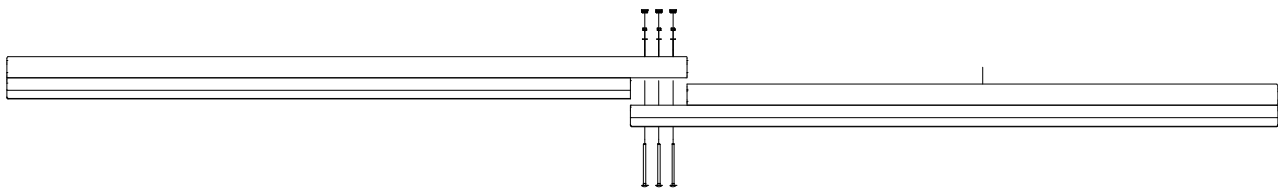

UNLESS OTHERWISE SPECIFIED:
DIMENSIONS ARE IN MILLIMETERS
TOLERANCES:
LINEAR: $\pm 2\text{MM}$
1 DECIMAL PLACE: $\pm 0.5\text{MM}$
ANGULAR: $\pm 1^\circ$

PROPRIETARY AND CONFIDENTIAL
THE INFORMATION CONTAINED IN THIS
DRAWING IS THE SOLE PROPERTY OF
FENLAND LEISURE PRODUCTS. ANY
REPRODUCTION IN PART OR AS A WHOLE
WITHOUT THE WRITTEN PERMISSION
OF FENLAND
LEISURE PRODUCTS IS PROHIBITED.

Title: PRO-500-127 BASKET & FLAT SEAT SWING (MLF25)

Product Range: PLAYGROUND EQUIPMENT

Date:
15/08/2019

Page:

A3

DO NOT SCALE FROM DRAWING

Tel: 01354 638359 www.onlineplaygrounds.co.uk



4. AS ILLUSTRATED, SECURE THE SWING HANGER AND THE SECURITY HANGER TO THE UNDERSIDE OF THE TOP BAR (ENSURE THE SECURITY SAFETY HANGER IS SECURED ON THE OUTER SIDE)

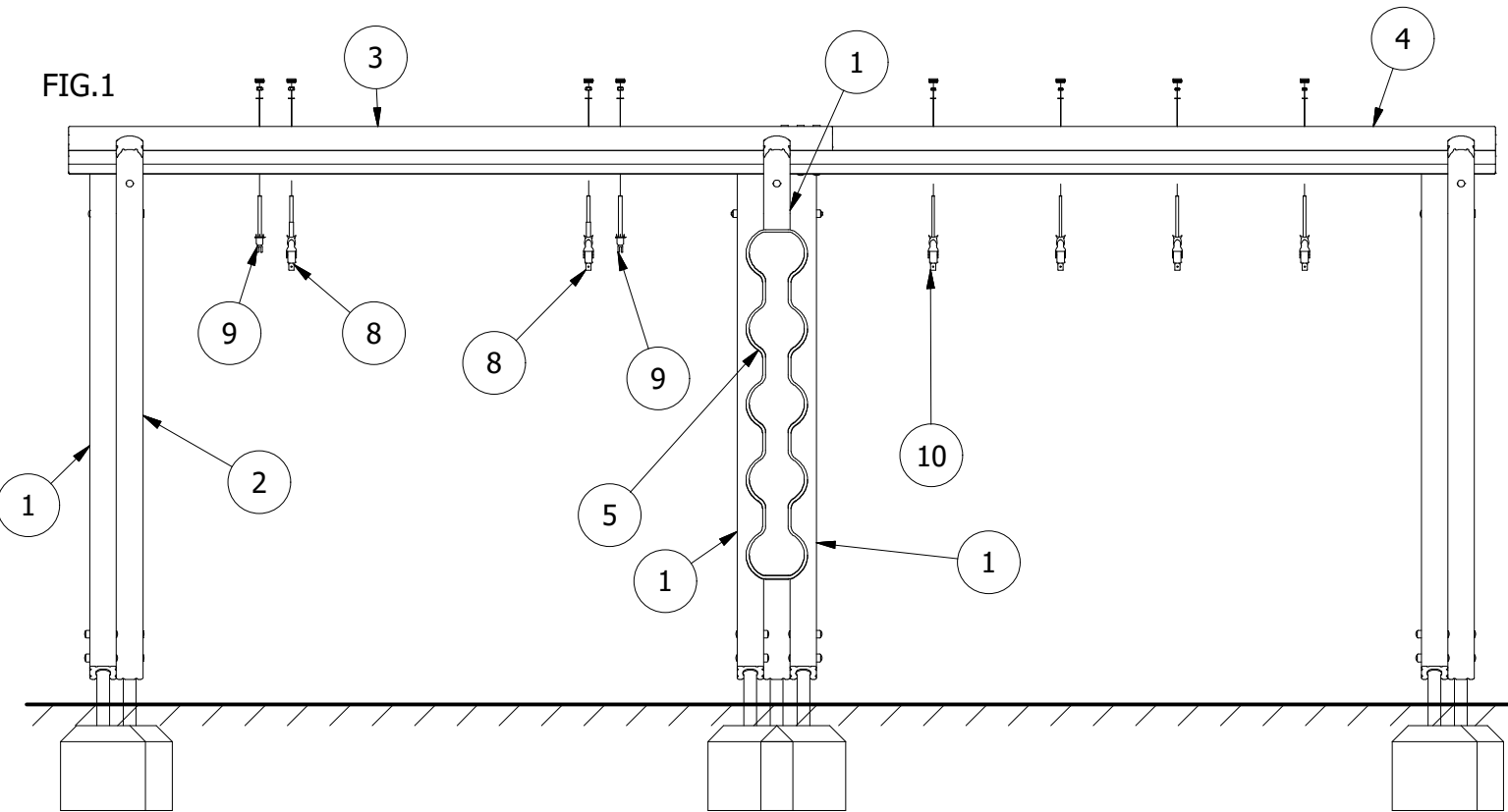

5. HANG THE BIRDS NEST SWING ATTACHING THE SWING CHAIN TO THE SWING HANGERS AND THE SECURITY CHAIN TO THE SWING CHAIN. ENSURE THE SEAT SITS A MINIMUM OF 400MM FROM FINISHED SURFACE LEVEL TO UNDERSIDE OF THE BASKET SEAT/SWING SEATS.

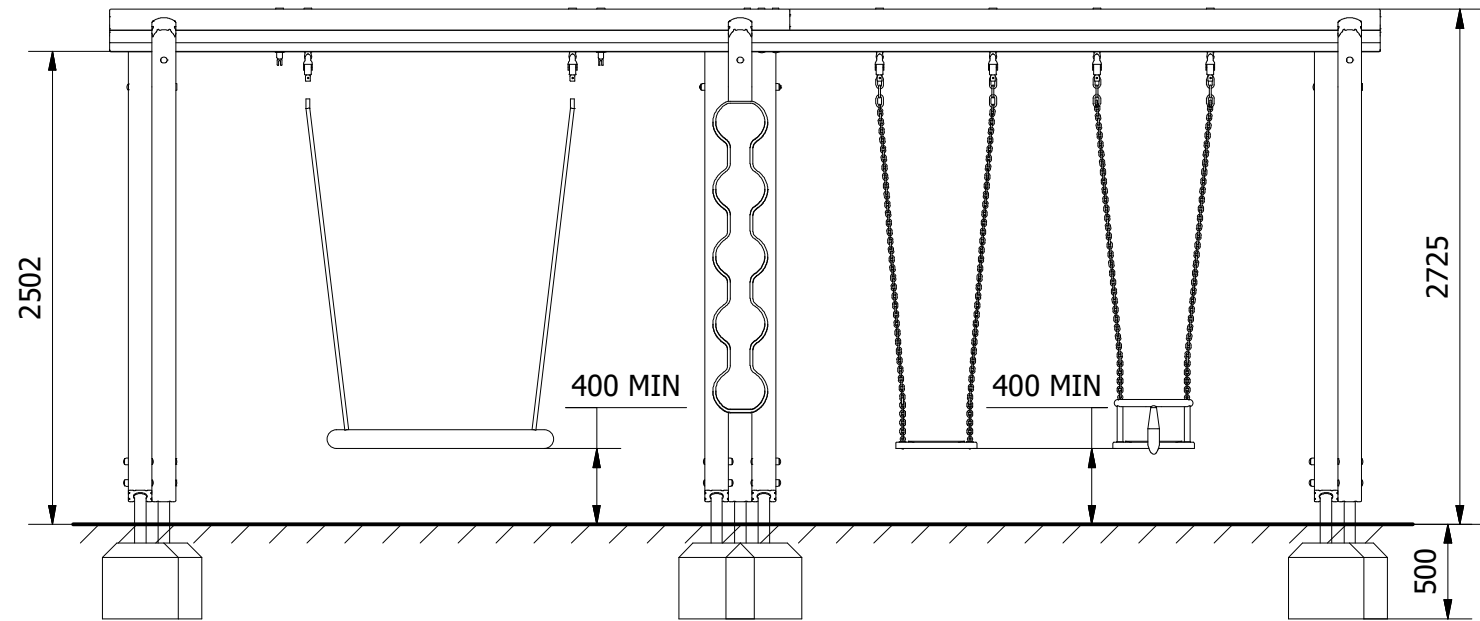

6. ALL POSTS WILL BE SUPPLIED WITH THE GROUND FOOT PRE-ATTACHED. IF NOT, PLEASE SEE THE DETAIL BELOW ON SECURING THE FOOT TO THE UNDERIDE OF THE UPRIGHT POSTS.

7. FINALLY, ENSURE UNIT IS LEVEL AND PLUMB, ALL FIXINGS HAVE BEEN TIGHTENED AND PROTECTIVE CAPS IN PLACE. ADD CONCRETE TO EACH FOUNDATION HOLE AND LEAVE FOR 48 HOURS

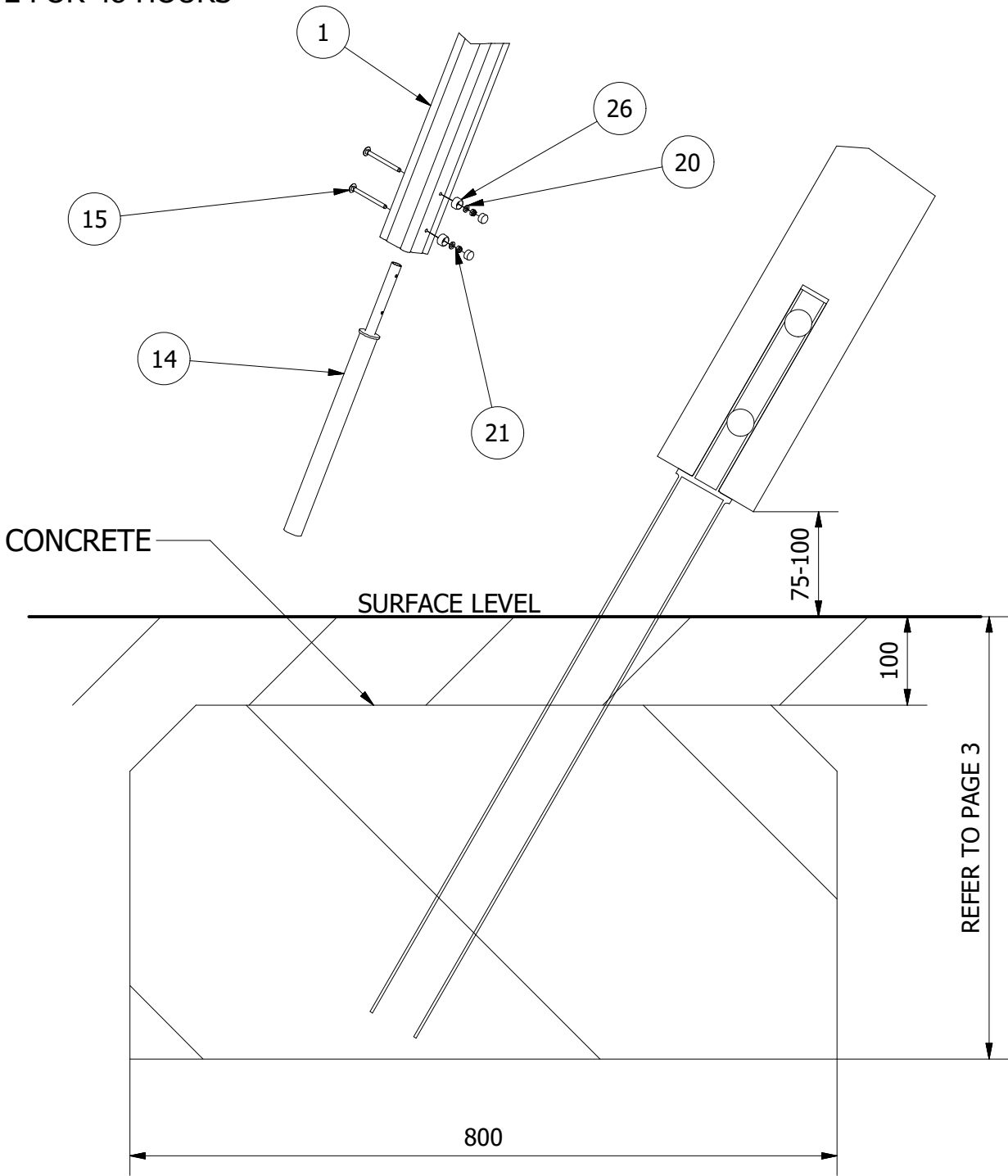

UNLESS OTHERWISE SPECIFIED:
DIMENSIONS ARE IN MILLIMETERS
TOLERANCES:
LINEAR: $\pm 2\text{MM}$
1 DECIMAL PLACE: $\pm 0.5\text{MM}$
ANGULAR: $\pm 1^\circ$

PROPRIETARY AND CONFIDENTIAL
THE INFORMATION CONTAINED IN THIS
DRAWING IS THE SOLE PROPERTY OF
FENLAND LEISURE PRODUCTS. ANY
REPRODUCTION IN PART OR AS A WHOLE
WITHOUT THE WRITTEN PERMISSION
OF FENLAND
LEISURE PRODUCTS IS PROHIBITED.

Title: PRO-500-127 BASKET & FLAT SEAT SWING (MLF25)

Product Range: PLAYGROUND EQUIPMENT

Date: 15/08/2019

Page: A3

DO NOT SCALE FROM DRAWING

Tel: 01354 638359 www.onlineplaygrounds.co.uk

