



Group Fitness Station : PRO-500-180

Description : The Group Fitness Station combines an inclined bench and horizontal press up bench, all manufactured in ACQ pressure treated timbers with stainless steel bars.

Surfacing Requirements : Perimeter L/M: 22m Wetpour/ Fibrefall M²: 18, Safagrass Mats M²: 18

Minimum User Height : 1400mm

Critical Fall Height : 1000mm

Dimensions of Largest Part : 3000x125x125mm

Weight of Heaviest Part : Approx 25.8 kg

This product complies to : BS EN 11630

This product is for outdoor use only and must not be installed indoors. Children using the equipment must be supervised at all times.

For spare parts and other inquiries please contact us using the contact information below.

Additional information about this product and all the other products we offer can be found on our website www.onlineplaygrounds.co.uk



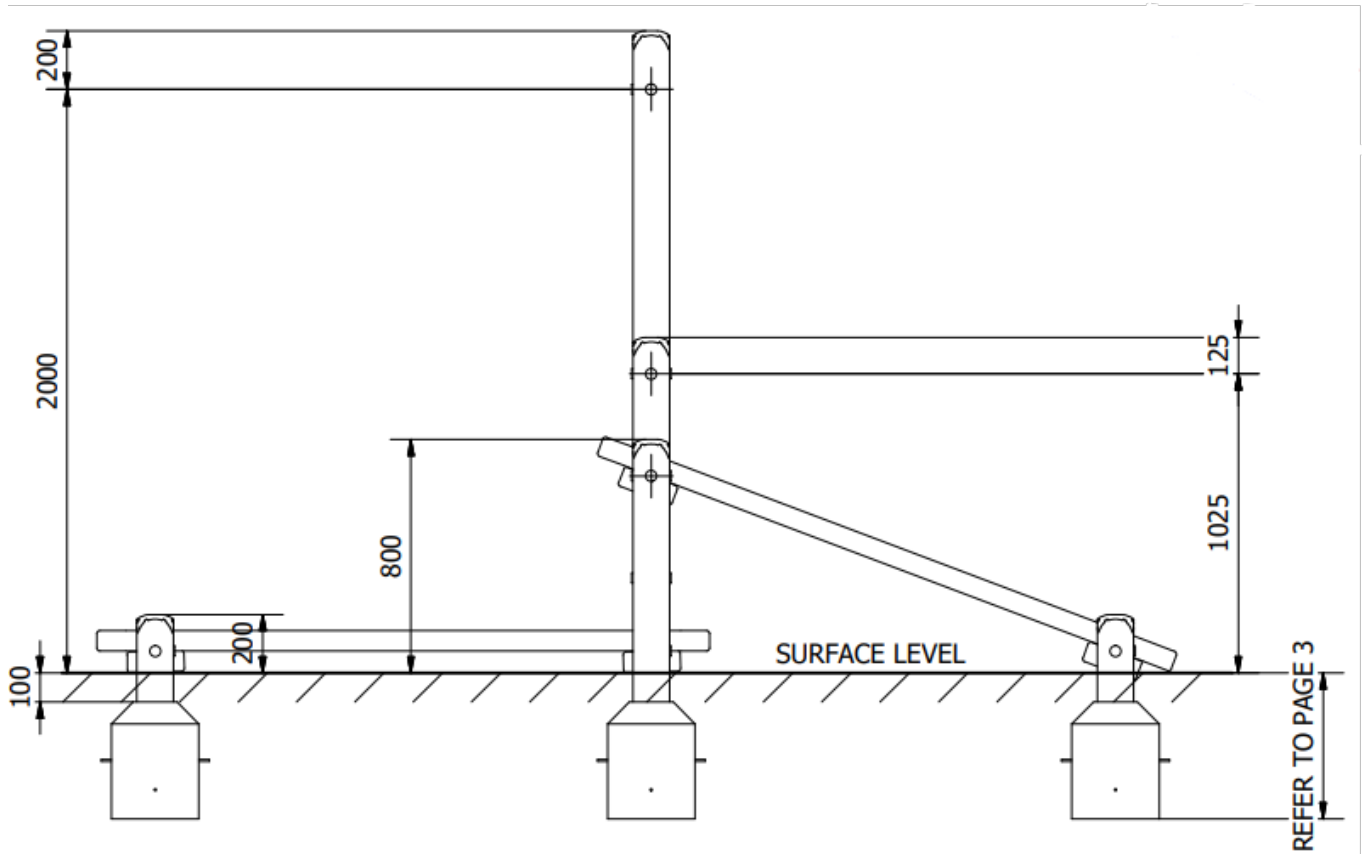

Side Elevation