

PARTS LIST				
ITEM	QTY	PART NUMBER	DESCRIPTION	STOCK NUMBER
1	4	TB-200-1069	2900MM X 125MM (POST FOOT)	COMTIMSAF0001
2	4	TB-200-1070	2900MM X 125MM (POST FOOT)	COMTIMSAF0001
3	2	TB-200-1071	2 X 2.5M X 125MM SAFALOG (BONDED)	COMTIMSAF0001
4	2	TB-200-1072	3900MM X 125MM (POST FOOT)	COMTIMSAF0001
5	1	RS-100-089	2000MM X 160MM 4 SIDED, PLAITED PP ROPE	
6	5	RS-100-090	SNAKE SWING SUPPORT	
7	8	MT-300-032	POST FOOT	
8	24	M12 X 160 COACH BOLT	M12 X 160 (DIN 603)	COMA2CBM12X160
9	8	M12 X 180 COACH SCREW	M12 X 180 COACH SCREW	COMA2CSM12X180
10	4	M16 X 190 T-BAR	190MM THREADED BAR	COMA2THRM16
11	4	M16 X 280 T-BAR	280MM THREADED BAR	COMA2THRM16
12	42	M12 WASHER	M12 WASHER (DIN 125)	COMA2FWM12
13	34	M12 NYLOC NUT	M12 NYLOC NUT (DIN 985)	COMA2NNM12
14	16	M16 NYLOC NUT	M16 NYLOC NUT (DIN 985)	COMA2NNM16
15	16	M16 HDWASHER	M16 HDWASHER (DIN 7439)	COMA2HDWASM16
16	24	2 PART CAP (BLACK)	TWO PART CAP	COMPLACAP0028
17	16	38MM BOLT COVER	38MM CAP	COMPLACAP0016
18	18	30MM BOLT COVER	30MM BLACK CAP	COMPLACAP0001
19	4	1000 x 700 x 400	0.28M³ CONCRETE FOUNDATION	
20	2	2000 x 700 x 400	0.56M³ CONCRETE FOUNDATION	

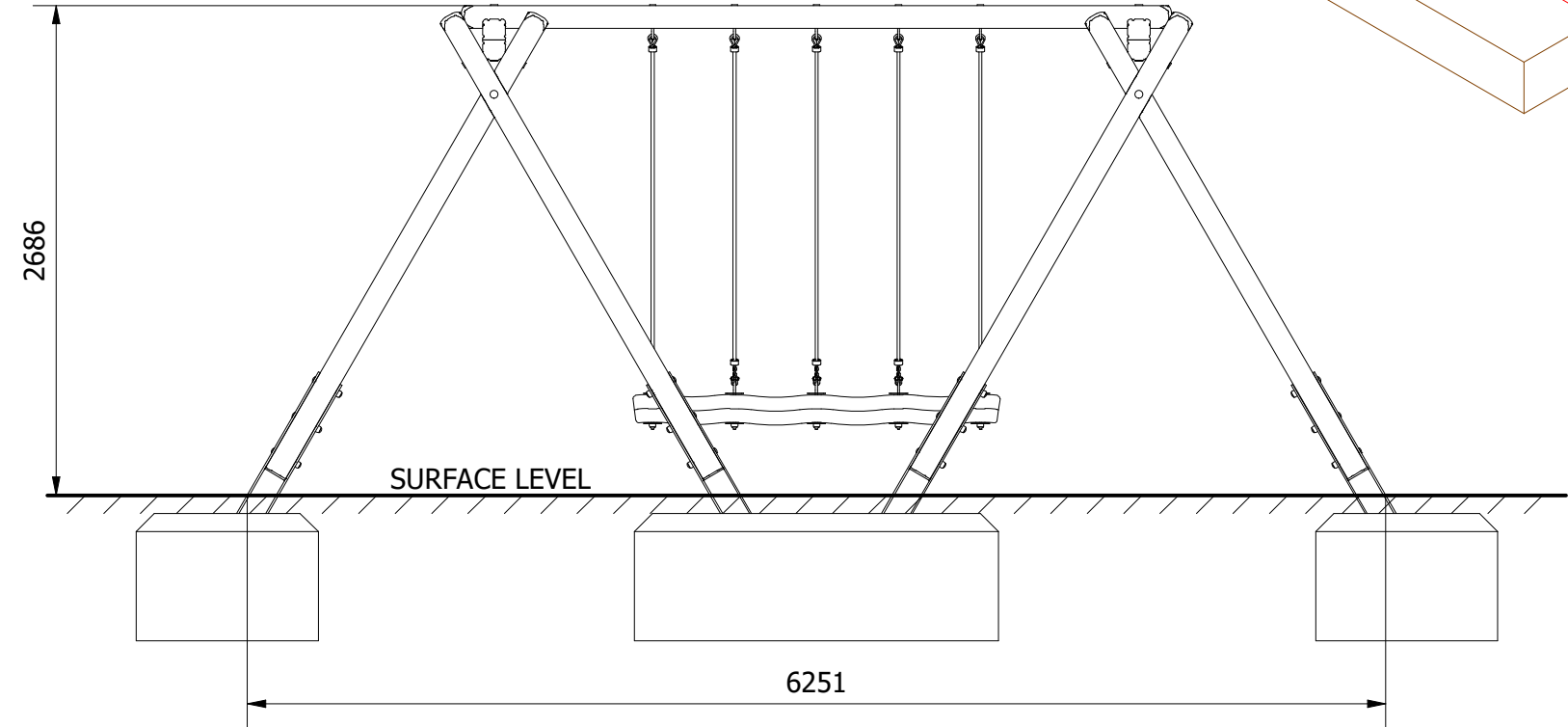

UNLESS OTHERWISE SPECIFIED:
DIMENSIONS ARE IN MILLIMETERS
TOLERANCES:
LINEAR: ±2MM
1 DECIMAL PLACE: ±0.5MM
ANGULAR: ±1°

PROPRIETARY AND CONFIDENTIAL
THE INFORMATION CONTAINED IN THIS
DRAWING IS THE SOLE PROPERTY OF
FENLAND LEISURE PRODUCTS. ANY
REPRODUCTION IN PART OR AS A WHOLE
WITHOUT THE WRITTEN PERMISSION
OF FENLAND
LEISURE PRODUCTS IS PROHIBITED.

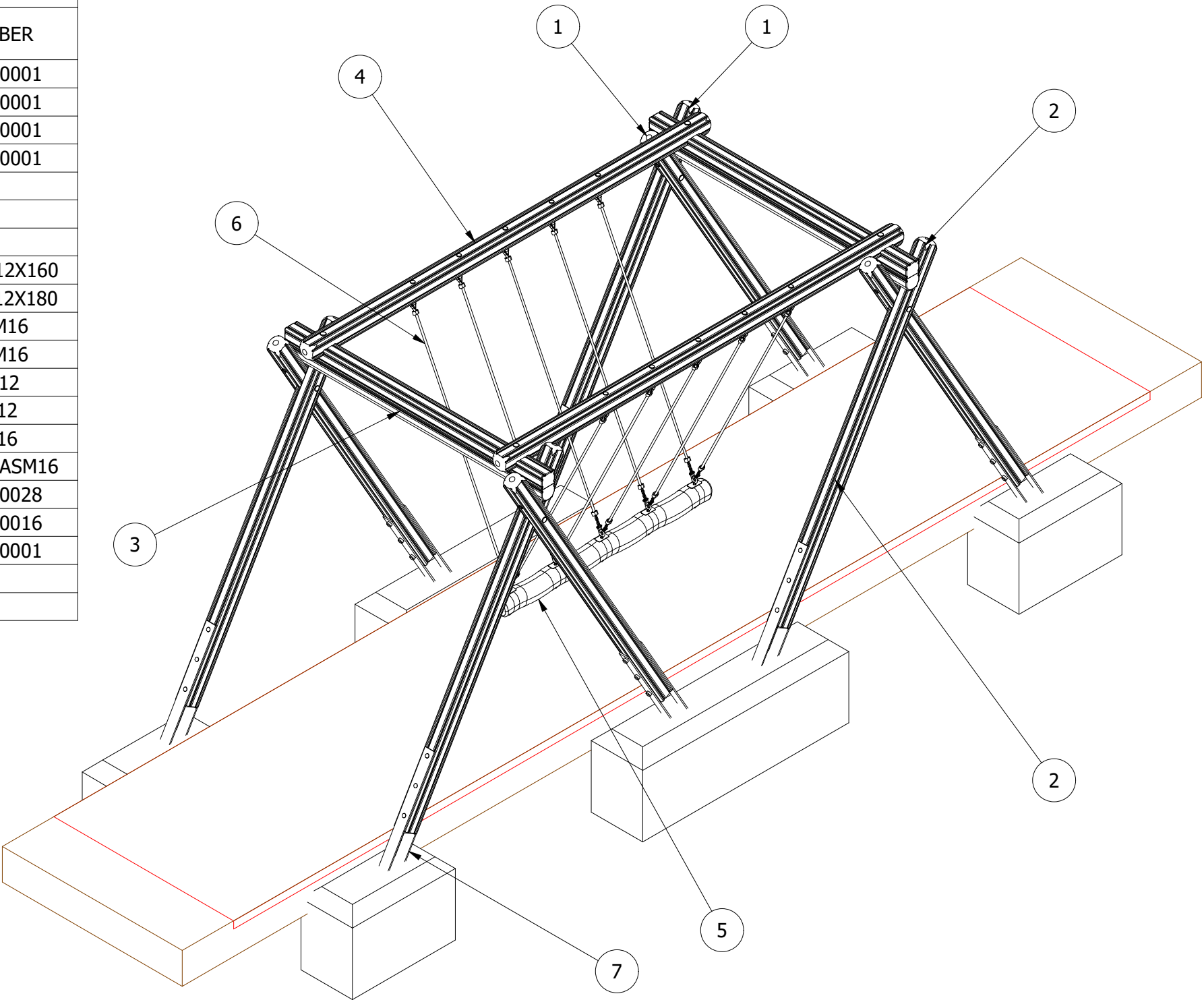

Title: PRO-500-242 SNAKE SWING	
Product Range: PLAYGROUND EQUIPMENT	
<1.6M FFH	Date: 01/04/2022
	Page: 1
	A3
DO NOT SCALE FROM DRAWING	
Tel: 01354 638359 www.onlineplaygrounds.co.uk	

LOOSEFILL SURFACING
AREA = 17.4M²
PERIMETER = 23.3 L/M

WETPOUR SURFACING
AREA = 15.6M²
PERIMETER = 21.3 L/M

14 SAFAGRASS TILES (1.5M X 1.0M)

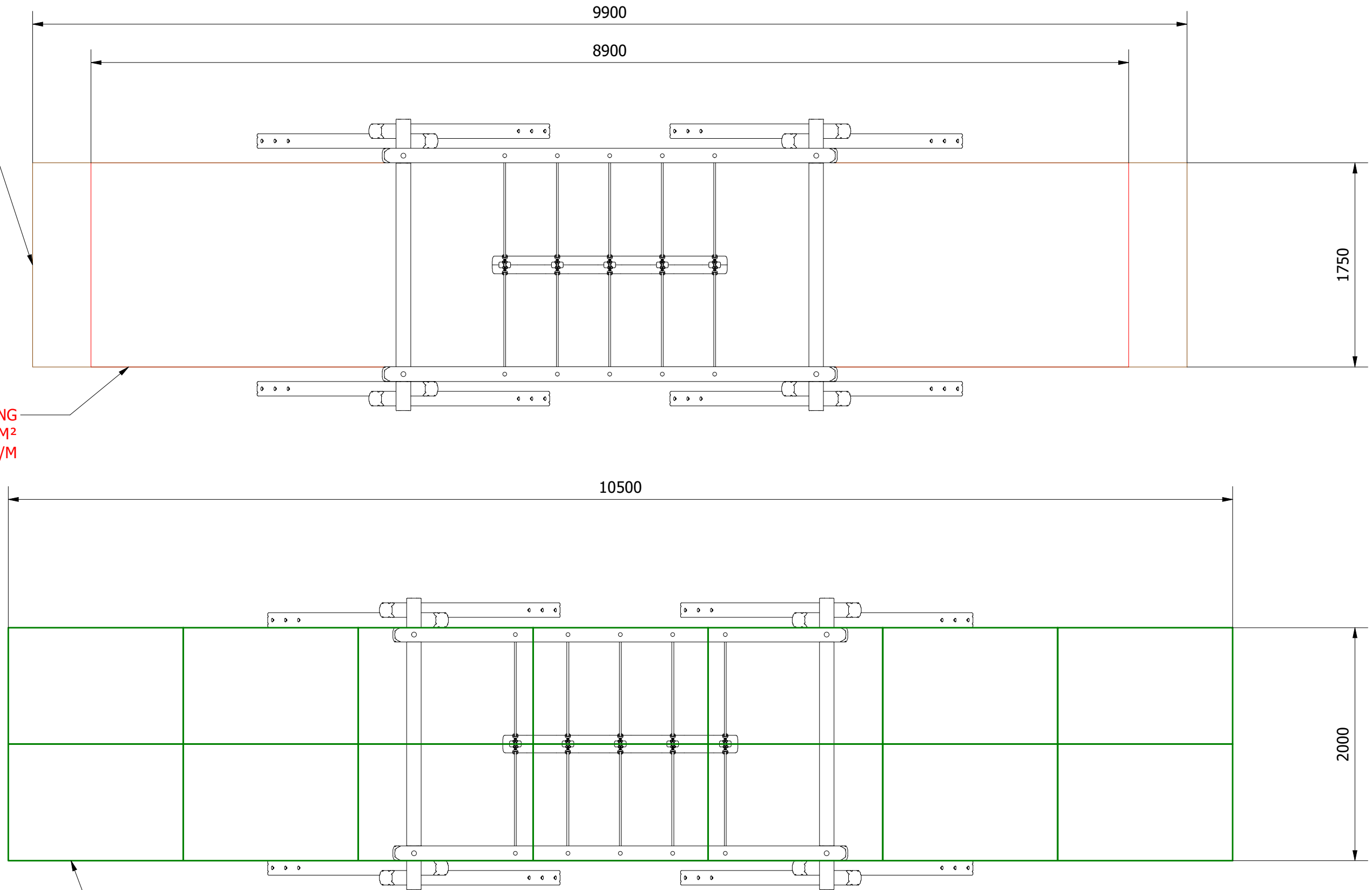

UNLESS OTHERWISE SPECIFIED:
DIMENSIONS ARE IN MILLIMETERS
TOLERANCES:
LINEAR: ±2MM
1 DECIMAL PLACE: ±0.5MM
ANGULAR: ±1°

PROPRIETARY AND CONFIDENTIAL
THE INFORMATION CONTAINED IN THIS
DRAWING IS THE SOLE PROPERTY OF
FENLAND LEISURE PRODUCTS. ANY
REPRODUCTION IN PART OR AS A WHOLE
WITHOUT THE WRITTEN PERMISSION
OF FENLAND
LEISURE PRODUCTS IS PROHIBITED.



Title: PRO-500-242 SNAKE SWING	
Product Range: PLAYGROUND EQUIPMENT	
DO NOT SCALE FROM DRAWING Tel: 01354 638359 www.onlineplaygrounds.co.uk	Date: 01/04/2022
	Page: 2
	A3

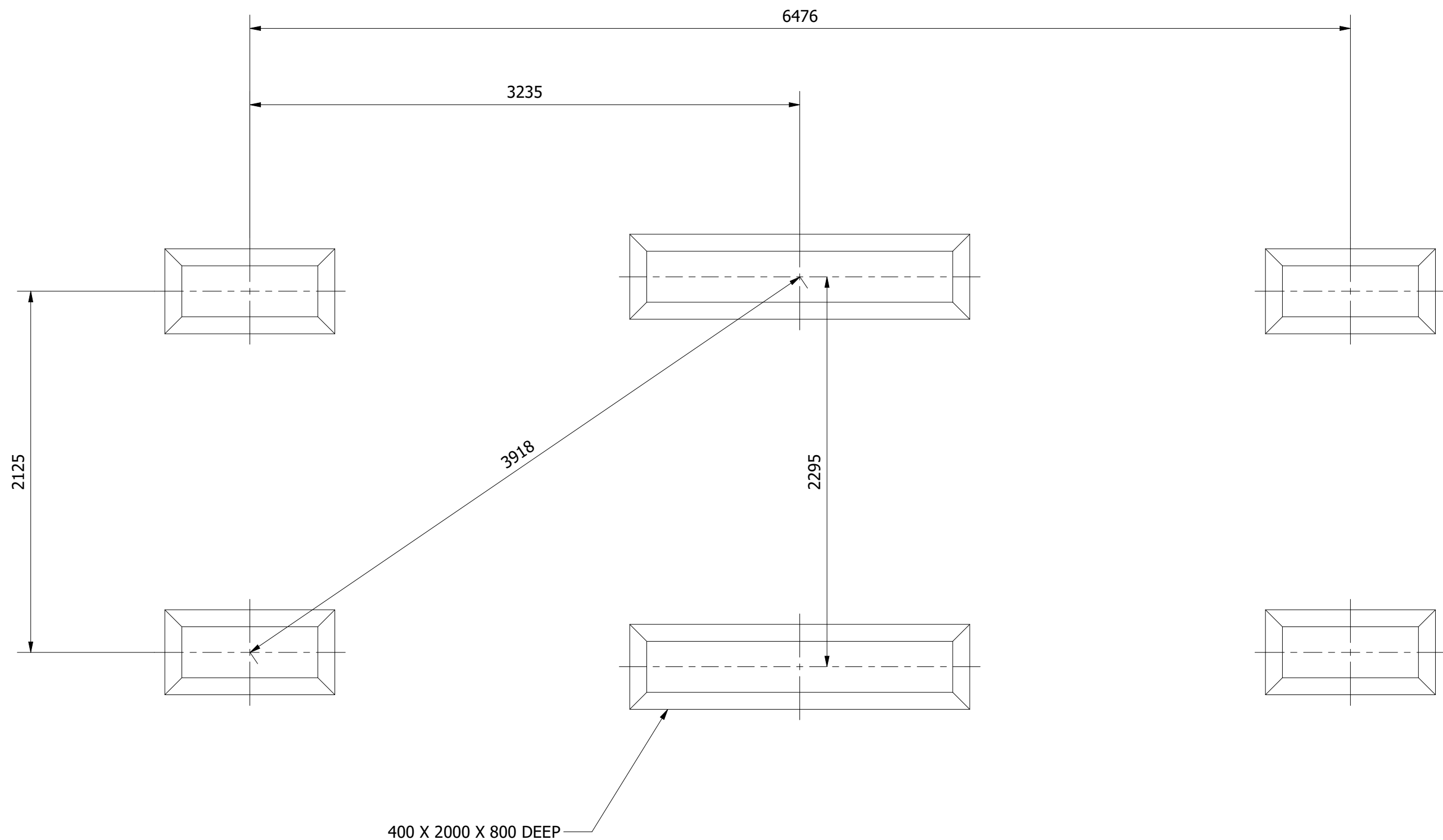

ALL FOUNDATIONS 400 X 1000 X 800 DEEP UNLESS OTHERWISE SPECIFIED

<p>UNLESS OTHERWISE SPECIFIED: DIMENSIONS ARE IN MILLIMETERS TOLERANCES:</p> <p>LINEAR: ±2MM 1 DECIMAL PLACE: ±0.5MM ANGULAR: ±1°</p>	<p>PROPRIETARY AND CONFIDENTIAL</p> <p>THE INFORMATION CONTAINED IN THIS DRAWING IS THE SOLE PROPERTY OF FENLAND LEISURE PRODUCTS. ANY REPRODUCTION IN PART OR AS A WHOLE WITHOUT THE WRITTEN PERMISSION OF FENLAND LEISURE PRODUCTS IS PROHIBITED.</p>	Title: PRO-500-242 SNAKE SWING	
		Product Range: PLAYGROUND EQUIPMENT	
			Date: 01/04/2022
			Page: 3
			A3
		DO NOT SCALE FROM DRAWING	
Tel: 01354 638359 www.onlineplaygrounds.co.uk			

1. CREATE THE TWO SWING A-FRAMES USING THE SUPPLIED FIXINGS AS ILLUSTRATED BELOW.

NOTE: TO REDUCE THE RISK OF STEEL GALLING, USE LUBRICANT ON ALL STAINLESS STEEL FIXINGS

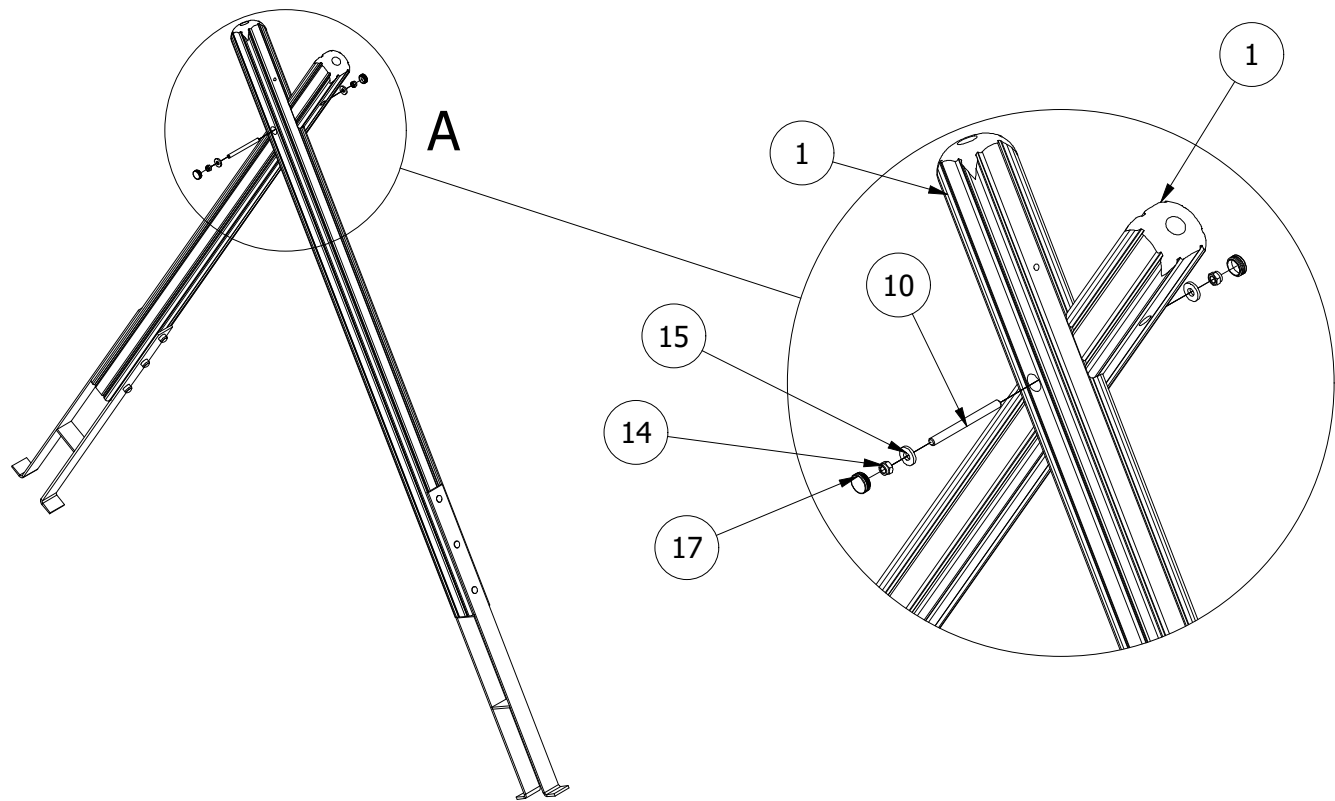

2. POSITION THE A-FRAMES INTO THE FOUNDATION HOLES AND BRACE. (TAKE NOTE OF THE POSITION OF THE POSTS AS SHOWN IN FIG 1) POSITION THE TOP BAR ONTO THE A-FRAMES AND SECURE IN PLACE.

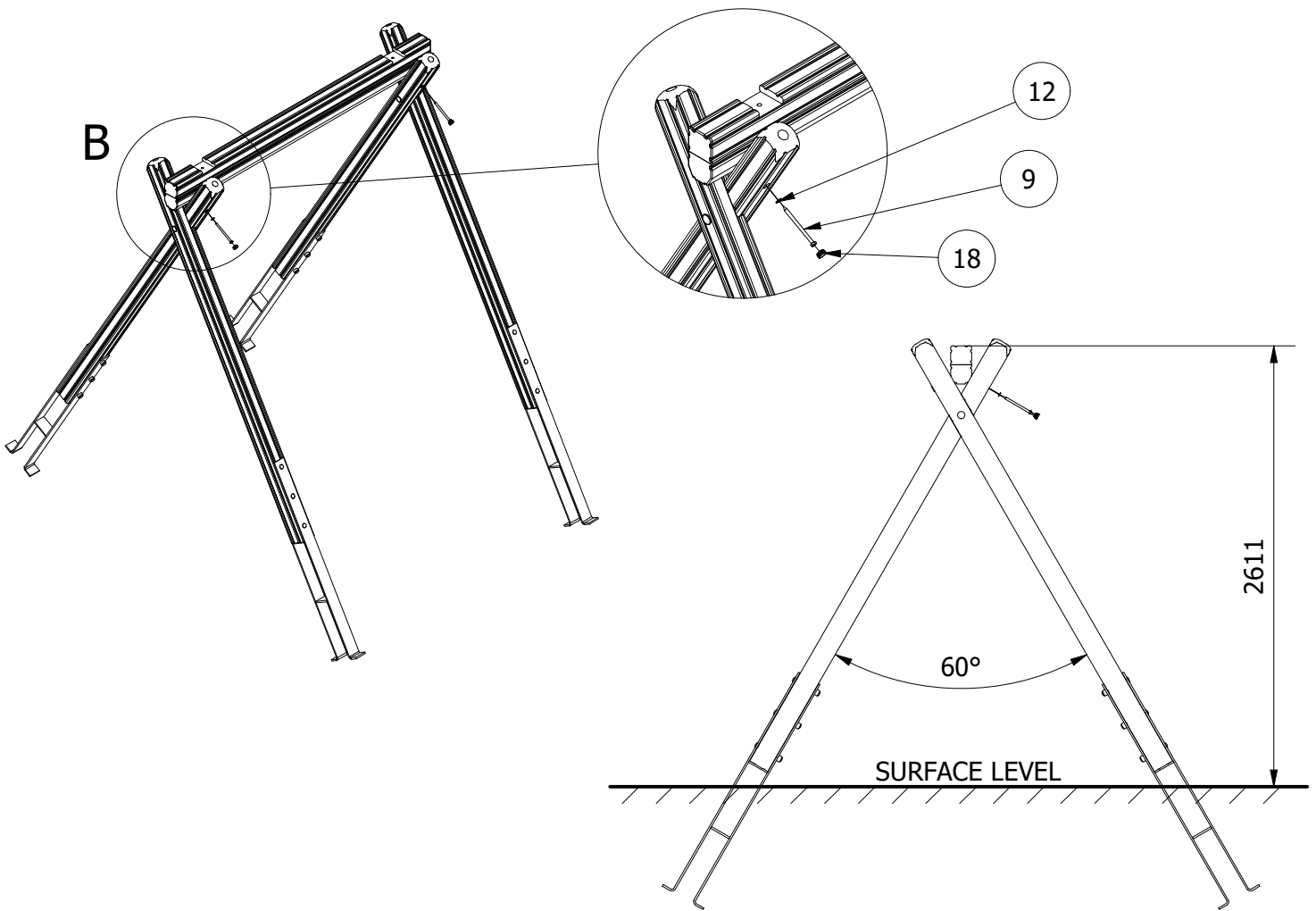

3. WITH BOTH FRAMES POSITIONED AND PROPPED IN THE FOUNDATION HOLES, POSITION THE MAIN SWING BEAM ONTO THE TOP A-FRAME BAR. USE THE SUPPLIED BOLTS TO SECURE.

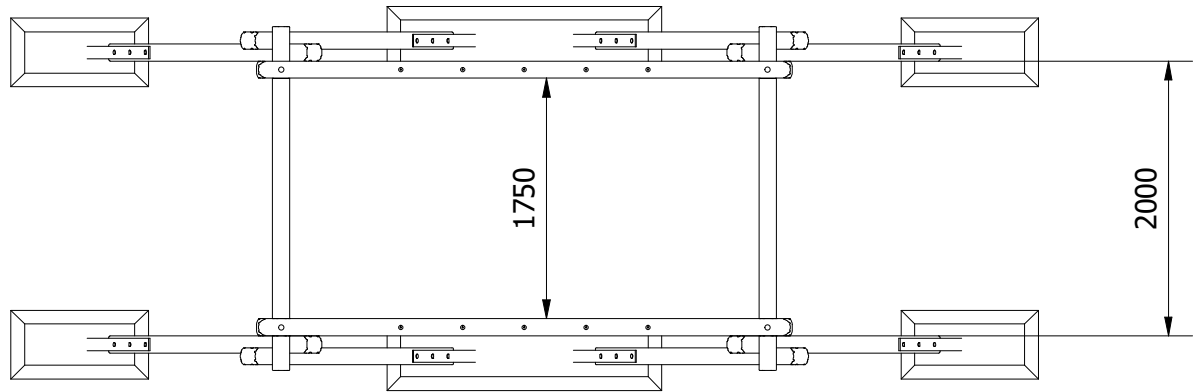
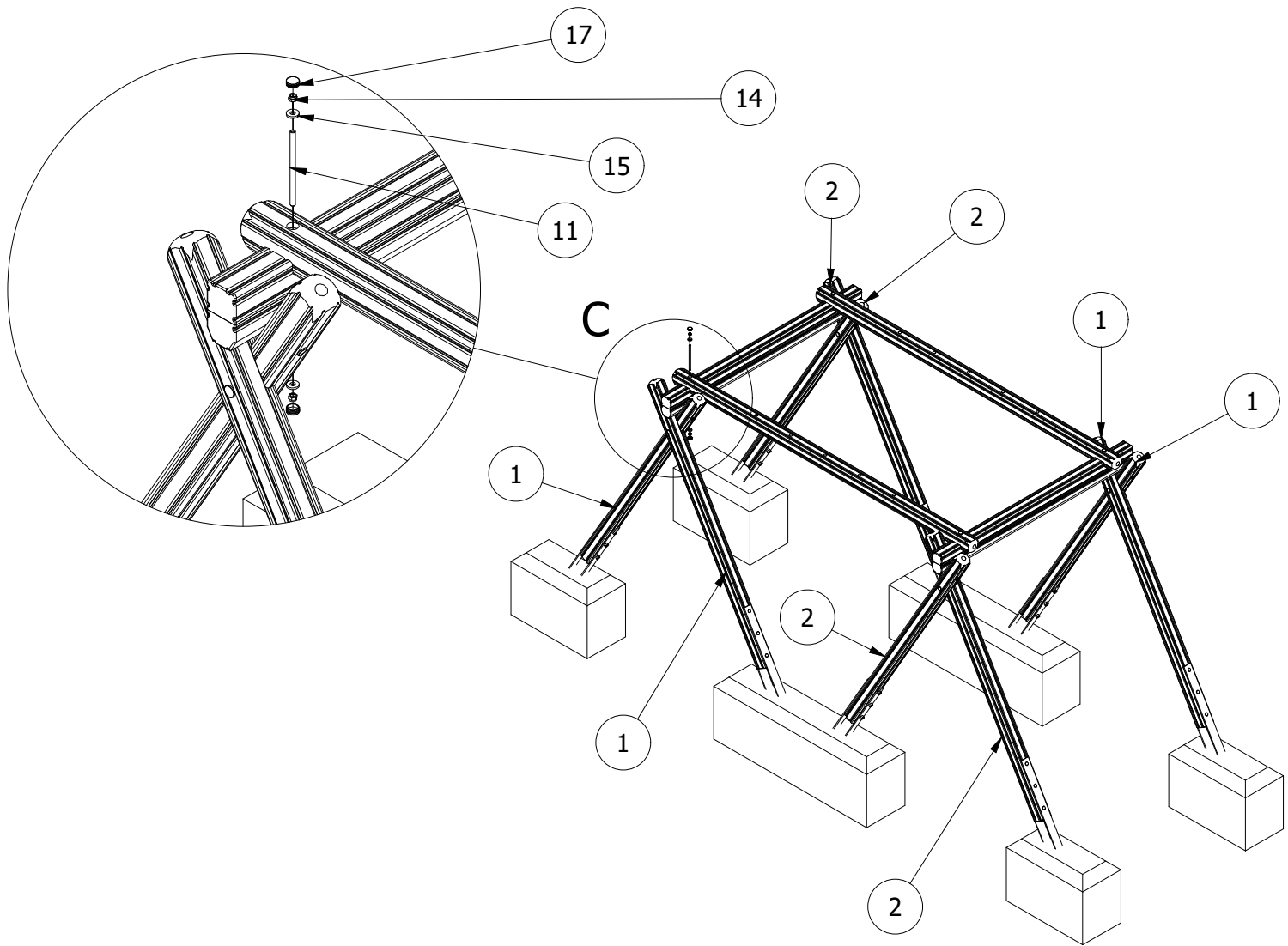

UNLESS OTHERWISE SPECIFIED:
DIMENSIONS ARE IN MILLIMETERS
TOLERANCES:
LINEAR: ±2MM
1 DECIMAL PLACE: ±0.5MM
ANGULAR: ±1°

PROPRIETARY AND CONFIDENTIAL
THE INFORMATION CONTAINED IN THIS
DRAWING IS THE SOLE PROPERTY OF
FENLAND LEISURE PRODUCTS. ANY
REPRODUCTION IN PART OR AS A WHOLE
WITHOUT THE WRITTEN PERMISSION
OF FENLAND
LEISURE PRODUCTS IS PROHIBITED.



Title: PRO-500-242 SNAKE SWING	
Product Range: PLAYGROUND EQUIPMENT	
DO NOT SCALE FROM DRAWING Tel: 01354 638359 www.onlineplaygrounds.co.uk	Date: 01/04/2022
	Page: 4
	A3

4. ENSURE UNIT IS LEVEL AND PLUMB, ALL FIXINGS HAVE BEEN TIGHTENED AND PROTECTIVE CAPS IN PLACE. ADD CONCRETE TO EACH FOUNDATION HOLE AND LEAVE FOR 48 HOURS.
5. WITH THE FRAME SECURE, HANG THE ROPE: ATTACH EACH SNAKE SWING SUPPORT (ITEM 6). POSITION THE SNAKE SWING UNDERNEATH THE HANGING ROPES AND SECURE AS ILLUSTRATED BELOW.

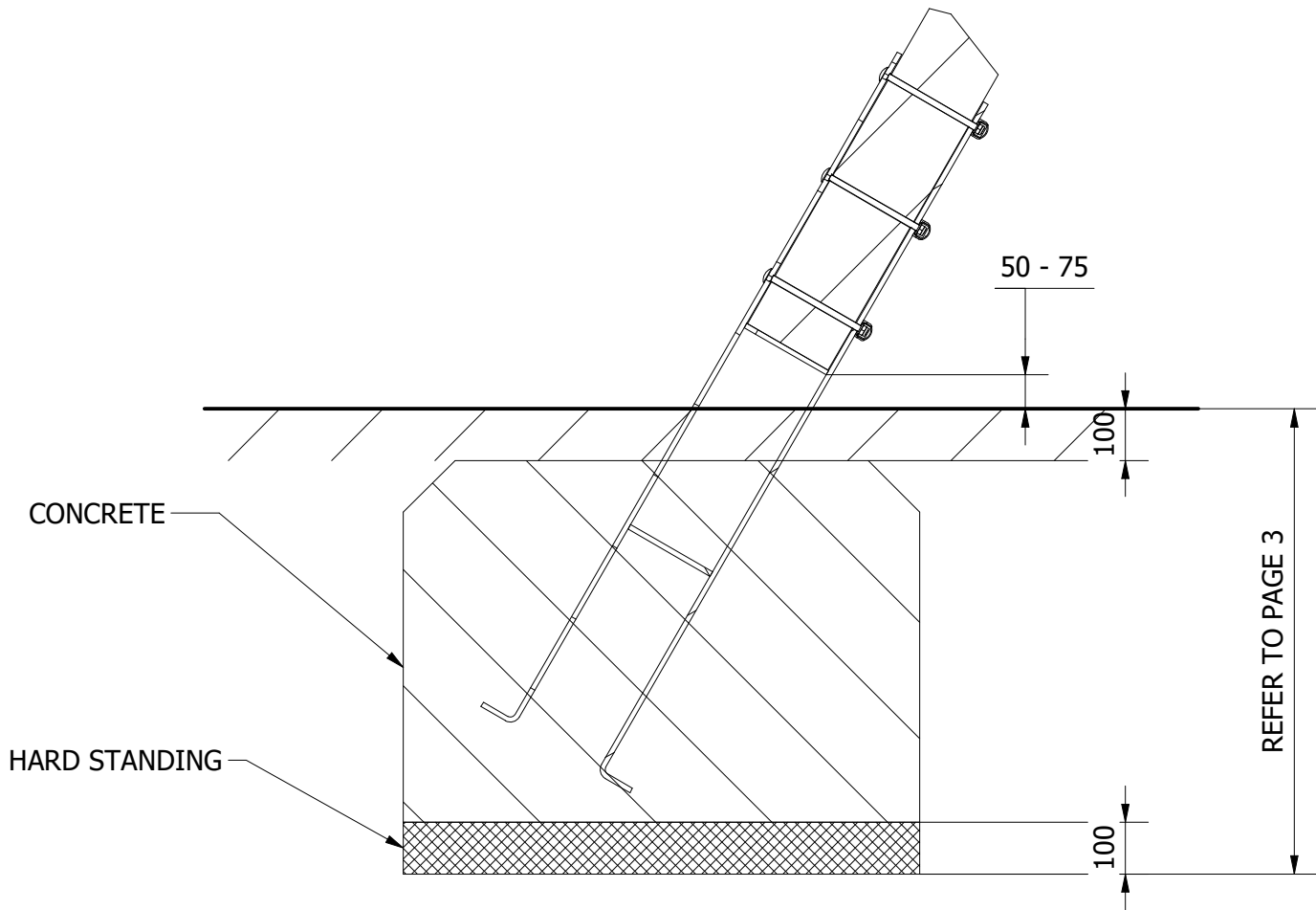
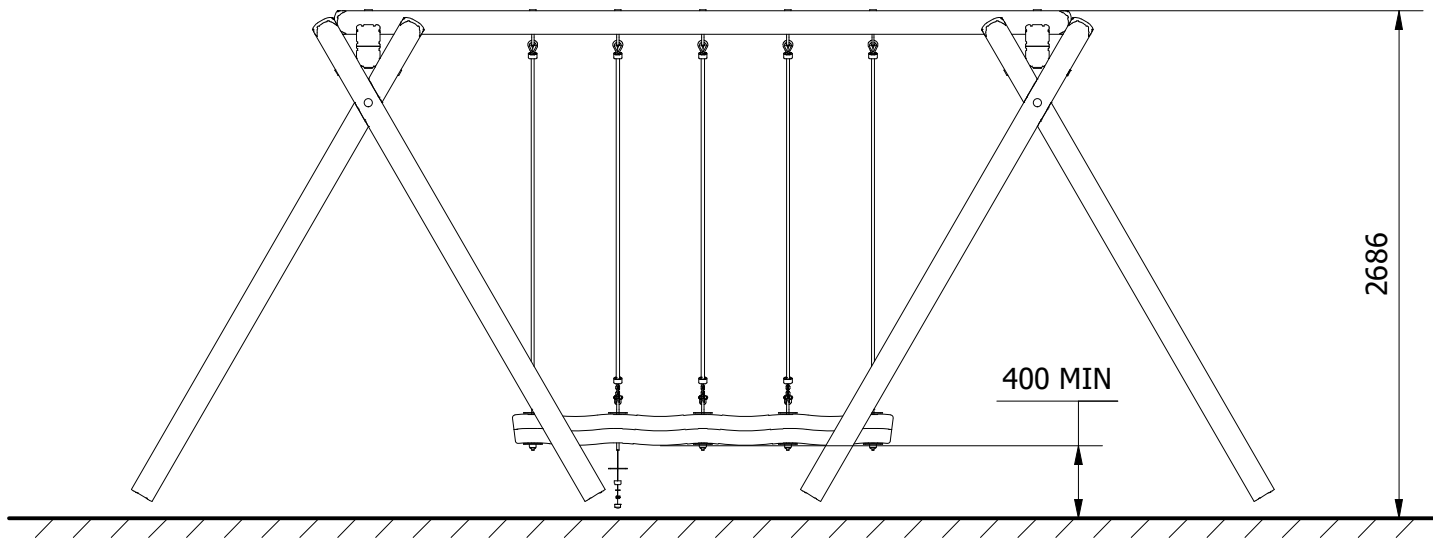
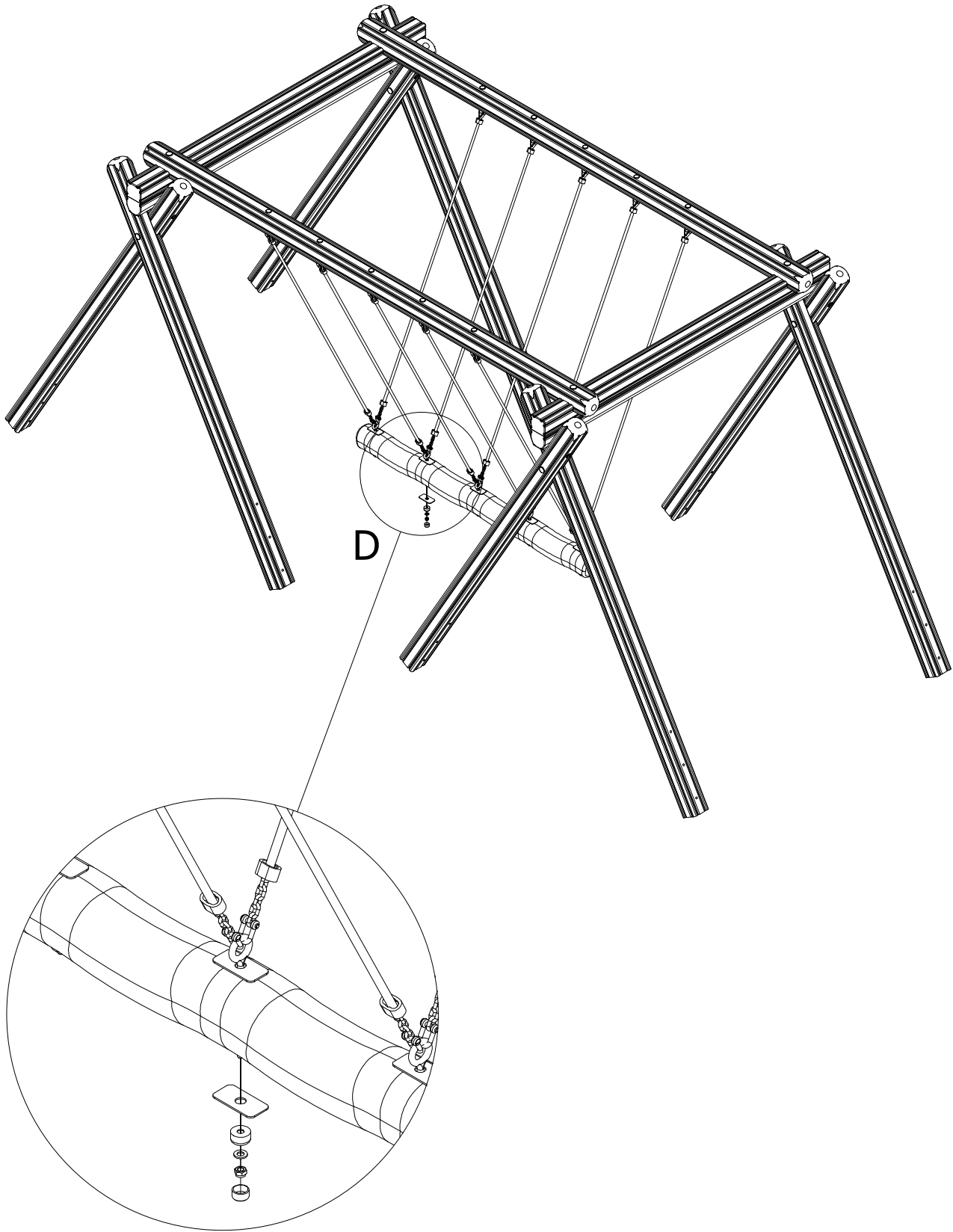

UNLESS OTHERWISE SPECIFIED:
DIMENSIONS ARE IN MILLIMETERS
TOLERANCES:
LINEAR: $\pm 2\text{MM}$
1 DECIMAL PLACE: $\pm 0.5\text{MM}$
ANGULAR: $\pm 1^\circ$

PROPRIETARY AND CONFIDENTIAL
THE INFORMATION CONTAINED IN THIS
DRAWING IS THE SOLE PROPERTY OF
FENLAND LEISURE PRODUCTS. ANY
REPRODUCTION IN PART OR AS A WHOLE
WITHOUT THE WRITTEN PERMISSION
OF FENLAND
LEISURE PRODUCTS IS PROHIBITED.



Title: PRO-500-195 SUPER SNAKE SWING	
Product Range: PLAYGROUND EQUIPMENT	
DO NOT SCALE FROM DRAWING Tel: 01354 638359 www.onlineplaygrounds.co.uk	Date: 01/04/2022
	Page: 5
	A3