

PARTS LIST				
ITEM	QTY	PART NUMBER	DESCRIPTION	STOCK NUMBER
1	5	TB-200-595	2900 x 125 Safalog	COMTIMSAF0001
2	2	TB-200-596	2900 x 125 Safalog	COMTIMSAF0001
3	1	TB-200-597	2 X 3.6M X 125MM SAFALOG (BONDED)	COMTIMSAF0001
4	1	TB-200-598	2 X 3.425M X 125MM SAFALOG (BONDED)	COMTIMSAF0001
5	1	PE-400-083	SWING LEG COVER	COMHDPEGNBGGN19
6	2	SWC4 FLAT	SWING CHAIN	SUBSWISTR0001
7	2	SW42 SWING FITTING	UNIVERSAL SWING FITTING	COMSWIHAN0007
8	2	SW8 SECURITY BOLT	SECURITY BOLT	COMSWIHAN0009
9	4	SW29 SWING FITTING	UNIVERSAL SWING FITTING	SUBSW29
10	1	BASKET SEAT	1M BIRDS NEST SWING SEAT	COMSWISEA0007
11	2	FLAT SWING SEAT	LARGE SWING SEAT	COMSWISEA0001
12	7	MOD-600-121 GROUND FOOT (125)	GROUND FOOT (125)	SUBSTEMIS0006
13	10	M6 X 50 TORX WOODSCREW	50MM TORX WOODSCREW	COMA2WS6X50
14	7	M12 X 180 COACH SCREW	M12 X 180 COACH SCREW	COMA2CSM12X180
15	3	M12 X 220 COACH BOLT	M12 X 220 (DIN 603)	COMA2CBM12X220
16	2	M12 X 240 COACH BOLT	M12 x 240 (DIN 603)	COMA2CBM12X240
17	1	M12 X 430 T-BAR	430MM THREADED BAR	COMHARTHRSTA001
18	18	M12 WASHER	M12 WASHER (DIN 125)	COMA2FWM12
19	11	M12 NYLOC NUT	M12 NYLOC NUT (DIN 985)	COMA2NNM12
20	2	M16 WASHER	M16 WASHER (DIN 125)	COMA2FWM16
21	2	M16 HDWASHER	M16 HDWASHER (DIN 7439)	COMA2HDWASM16
22	4	M16 NYLOC NUT	M16 NYLOC NUT (DIN 985)	COMA2NNM16
23	12	30MM BOLT COVER	30MM BLACK CAP	COMPLACAP0001
24	6	38MM BOLT COVER	38MM CAP	COMPLACAP0016
25	2	45MM BOLT COVER	45MM CAP	COMPLACAP0017
26	2	2 PART CAP (BLACK)	TWO PART CAP	COMPLACAP0028
27	7	400 x 800 x 400	0.128M³ CONCRETE FOUNDATION	

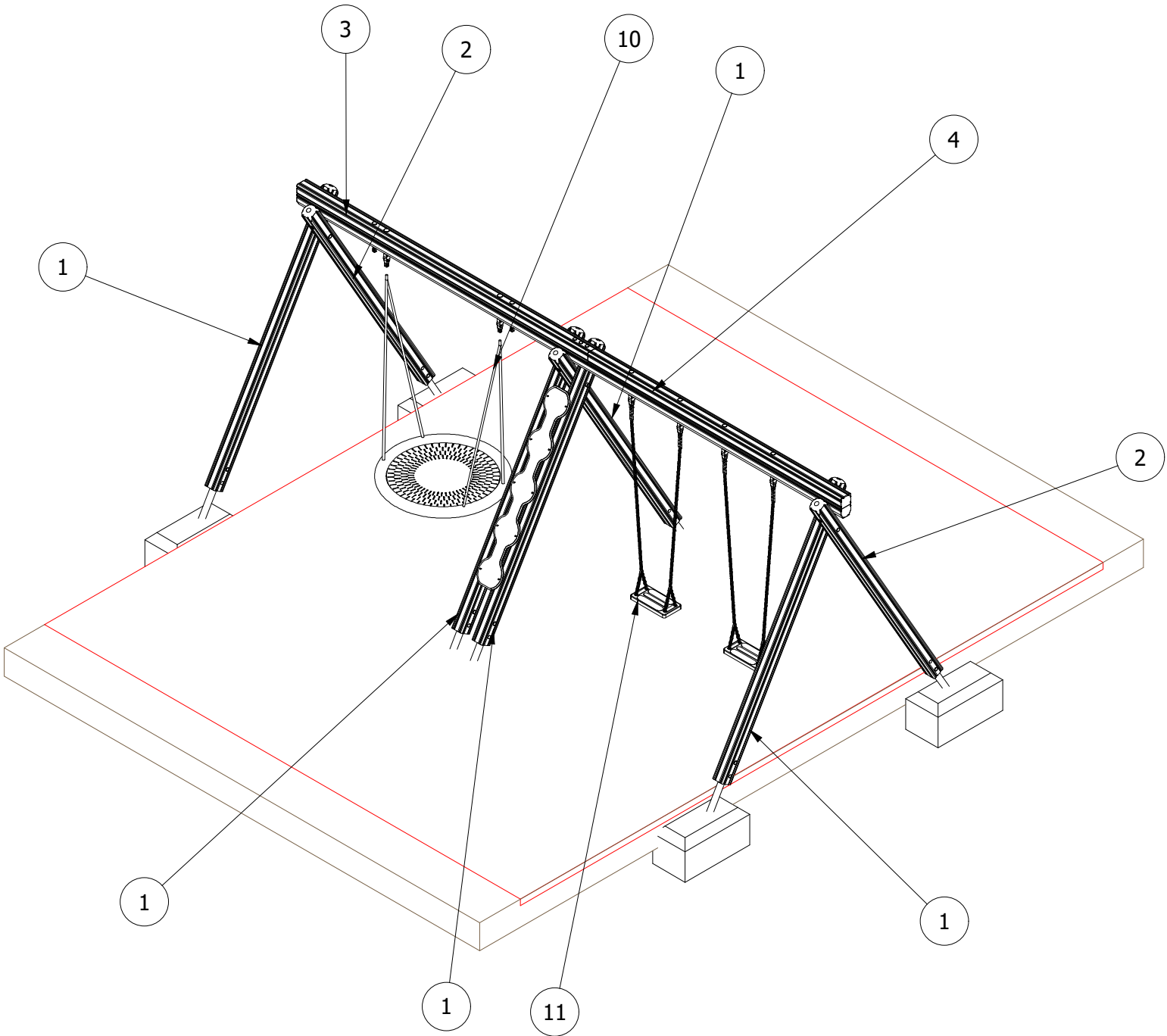

UNLESS OTHERWISE SPECIFIED:
DIMENSIONS ARE IN MILLIMETERS
TOLERANCES:
LINEAR: ±2MM
1 DECIMAL PLACE: ±0.5MM
ANGULAR: ±1°

PROPRIETARY AND CONFIDENTIAL
THE INFORMATION CONTAINED IN THIS
DRAWING IS THE SOLE PROPERTY OF
FENLAND LEISURE PRODUCTS. ANY
REPRODUCTION IN PART OR AS A WHOLE
WITHOUT THE WRITTEN PERMISSION
OF FENLAND
LEISURE PRODUCTS IS PROHIBITED.

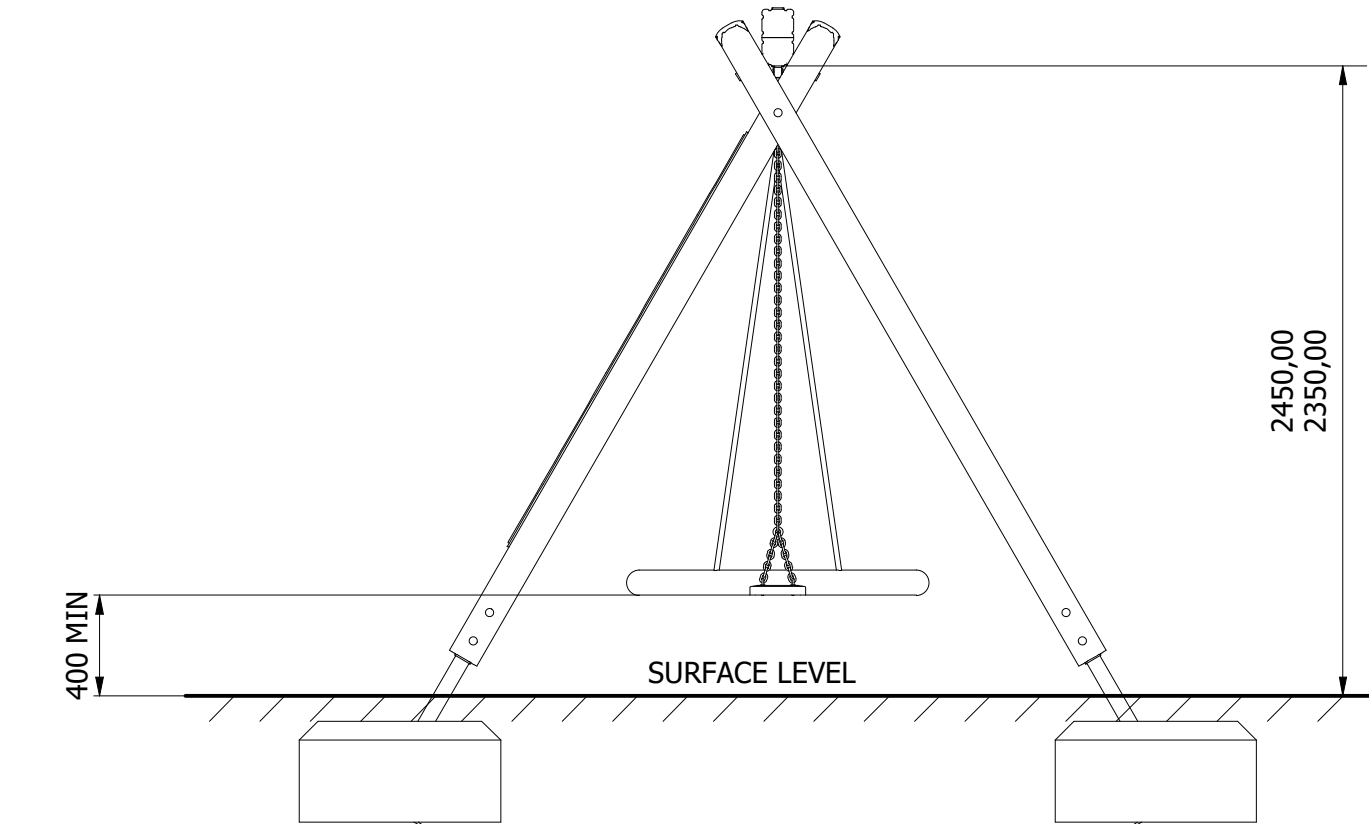

Title: PRO-500-133 BASKET & FLAT SEAT SWING_PF (MLF25)	
Product Range: PLAYGROUND EQUIPMENT	
<1.5M FFH	Date: 25/10/2019
	Page: 1
	A3
DO NOT SCALE FROM DRAWING	
Tel: 01354 638359 www.onlineplaygrounds.co.uk	

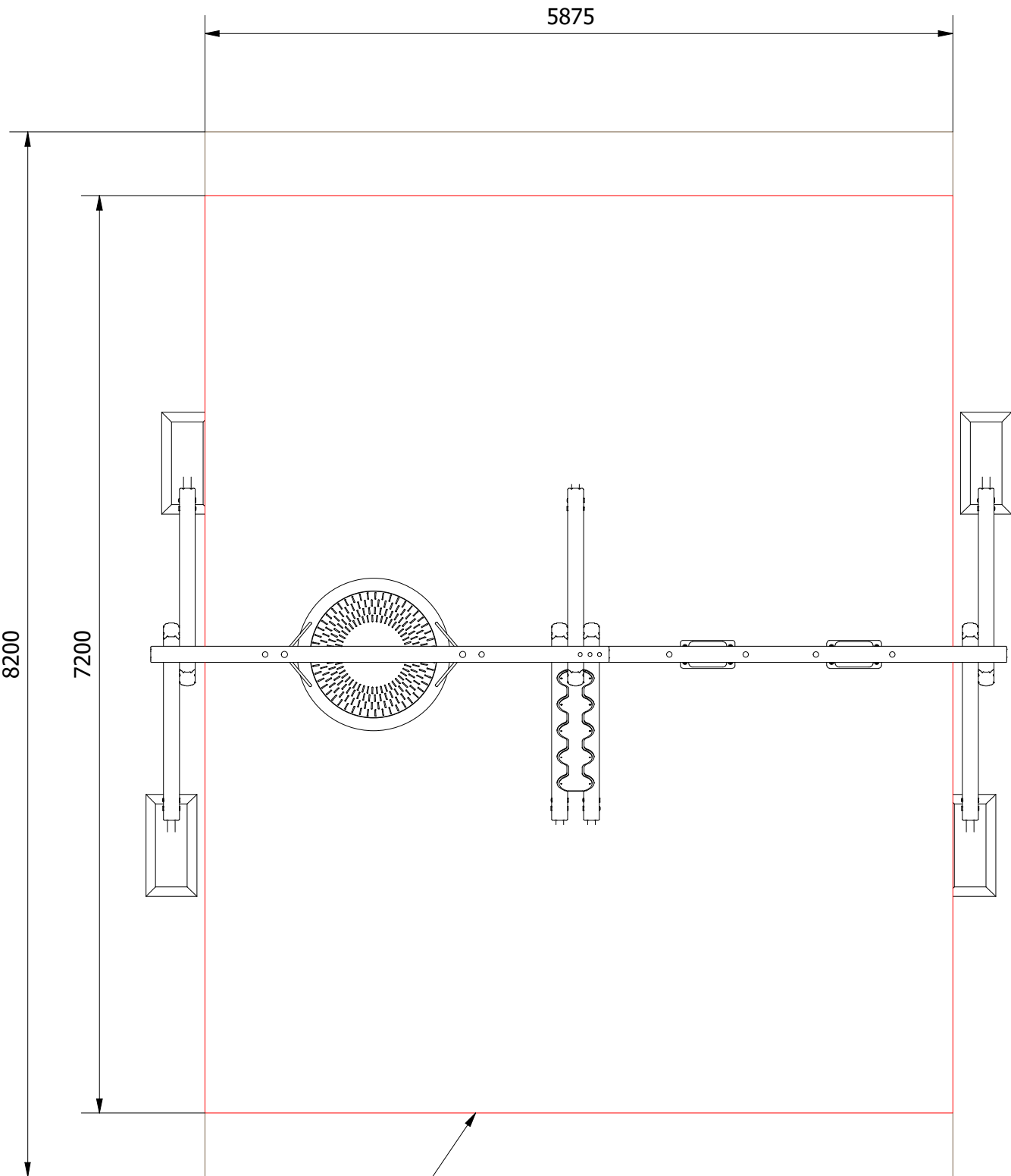

WETPOUR SURFACING
AREA = 42.2M²
PERIMETER = 26.2 L/M

LOOSEFILL SURFACING
AREA = 48.2M²
PERIMETER = 28.2 L/M

30 SAFAGRASS TILES (1.5M X 1.0M)

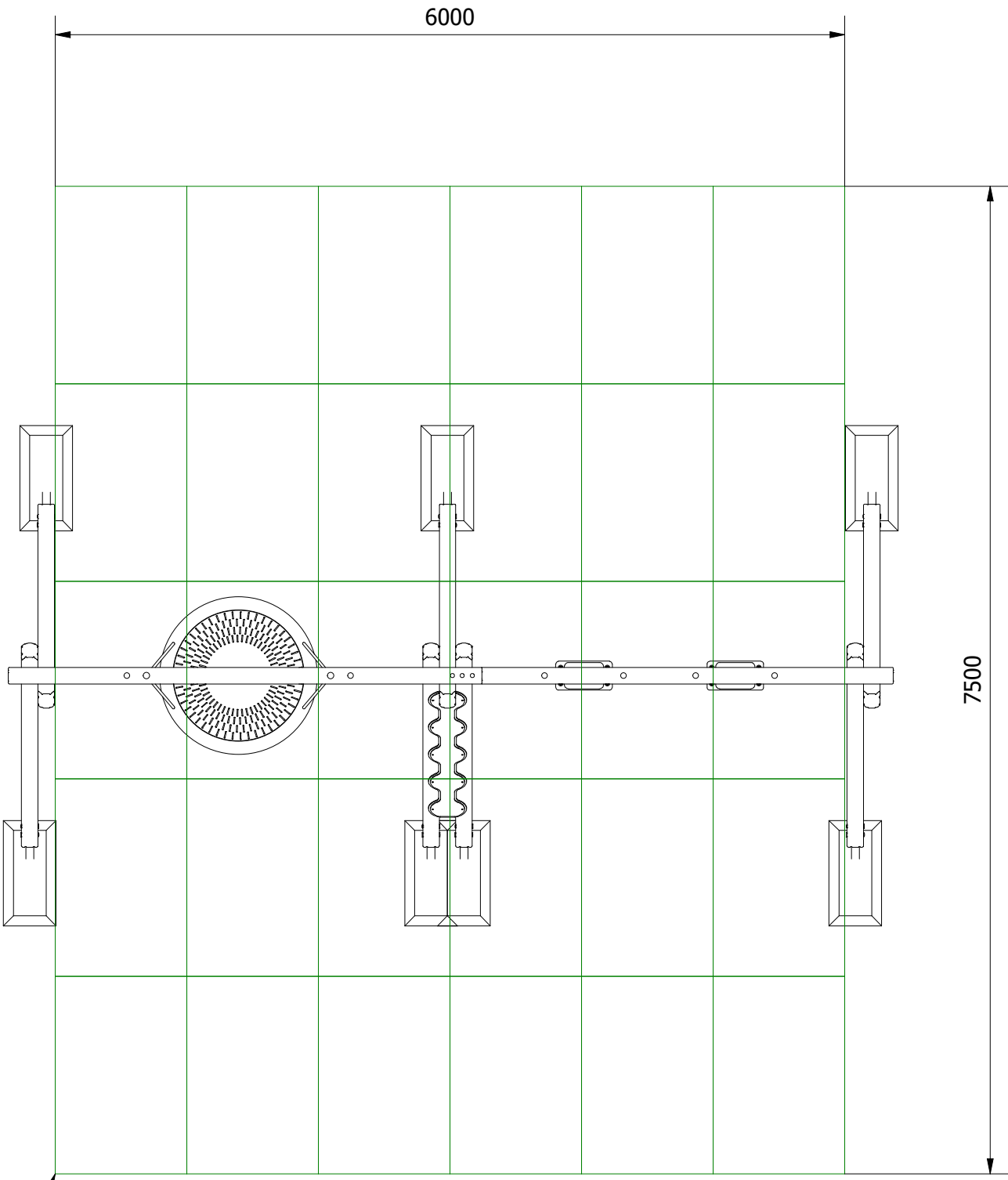

UNLESS OTHERWISE SPECIFIED: DIMENSIONS ARE IN MILLIMETERS TOLERANCES: LINEAR: ±2MM 1 DECIMAL PLACE: ±0.5MM ANGULAR: ±1°		PROPRIETARY AND CONFIDENTIAL THE INFORMATION CONTAINED IN THIS DRAWING IS THE SOLE PROPERTY OF FENLAND LEISURE PRODUCTS. ANY REPRODUCTION IN PART OR AS A WHOLE WITHOUT THE WRITTEN PERMISSION OF FENLAND LEISURE PRODUCTS IS PROHIBITED.		Title: PRO-500-133 BASKET & FLAT SEAT SWING_PF (MLF25)	
		Product Range: PLAYGROUND EQUIPMENT		Date:	25/10/2019
		DO NOT SCALE FROM DRAWING		Page:	2
					A3
		Tel: 01354 638359 www.onlineplaygrounds.co.uk			

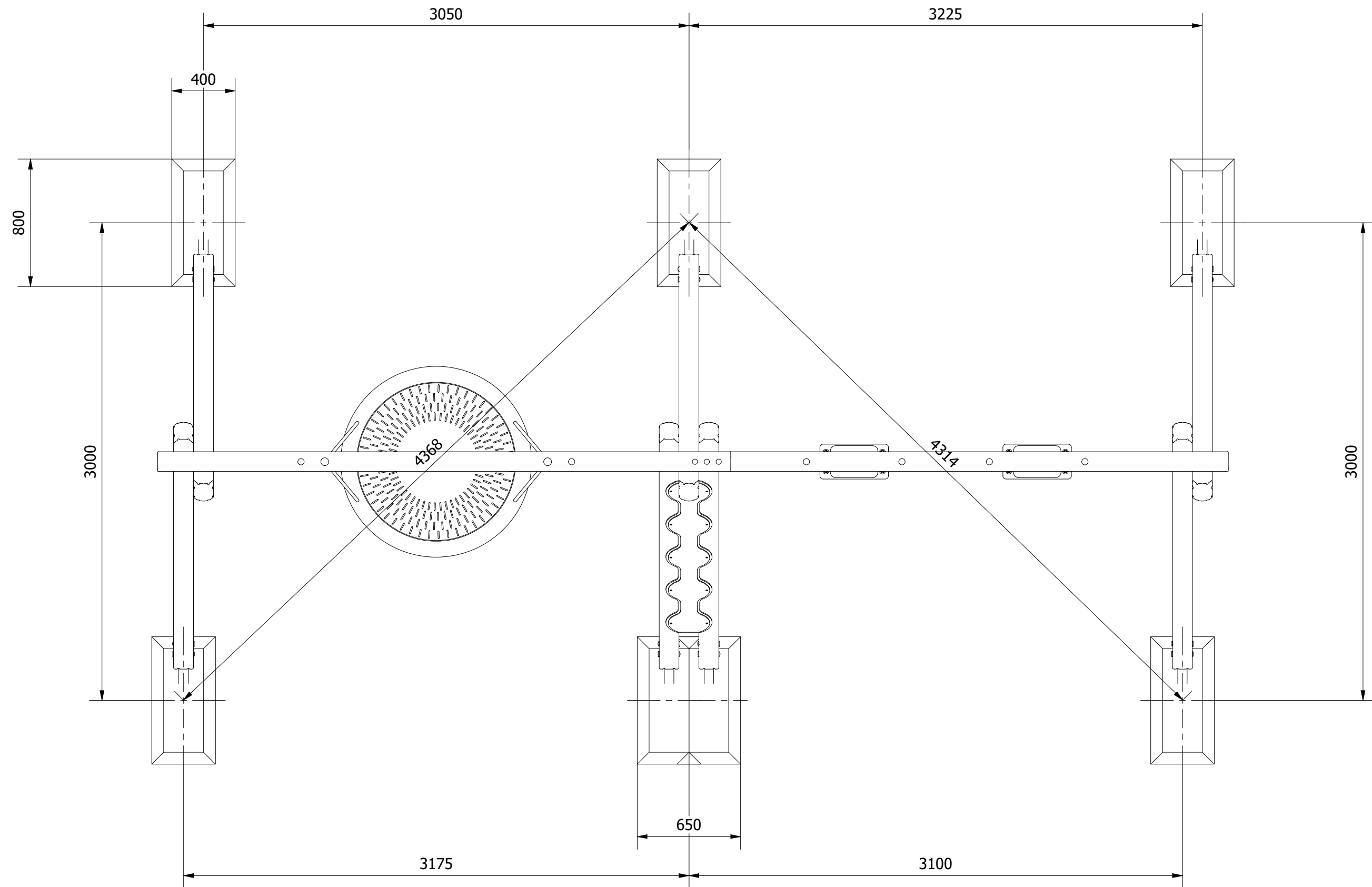

UNLESS OTHERWISE SPECIFIED: DIMENSIONS ARE IN MILLIMETERS TOLERANCES: LINEAR: ±2MM 1 DECIMAL PLACE: ±0.5MM ANGULAR: ±1°		PROPRIETARY AND CONFIDENTIAL THE INFORMATION CONTAINED IN THIS DRAWING IS THE SOLE PROPERTY OF FENLAND LEISURE PRODUCTS. ANY REPRODUCTION IN PART OR AS A WHOLE WITHOUT THE WRITTEN PERMISSION OF FENLAND LEISURE PRODUCTS IS PROHIBITED.		Title: PRO-500-133 BASKET & FLAT SEAT SWING_PF (MLF25)	
		Product Range:		PLAYGROUND EQUIPMENT	
		DO NOT SCALE FROM DRAWING		Date:	25/10/2019
				Page:	3
					A3
		Tel: 01354 638359 www.onlineplaygrounds.co.uk			

ALL FOUNDATIONS 400 X 800 X 600 DEEP UNLESS OTHERWISE SPECIFIED

1. CREATE THE TWO SWING A-FRAMES USING THE SUPPLIED FIXINGS AS ILLUSTRATED BELOW.

NOTE: TO REDUCE THE RISK OF STEEL GALLING, USE LUBRICANT ON ALL STAINLESS STEEL FIXINGS

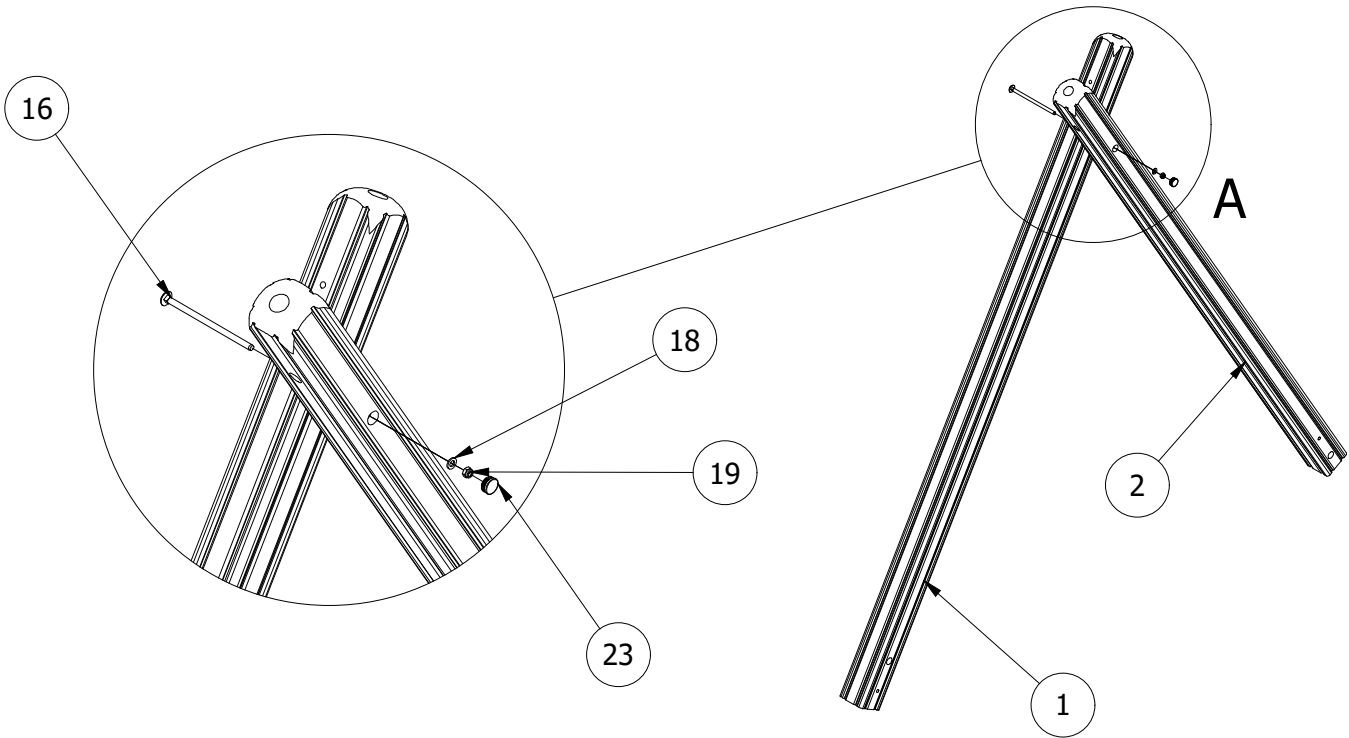

2. POSITION THE A-FRAMES INTO THE FOUNDATION HOLES AND BRACE. (TAKE NOTE OF THE POSITION OF THE POSTS AS SHOWN IN FIG 1) POSITION THE TOP BAR ONTO THE A-FRAMES AND SECURE IN PLACE.

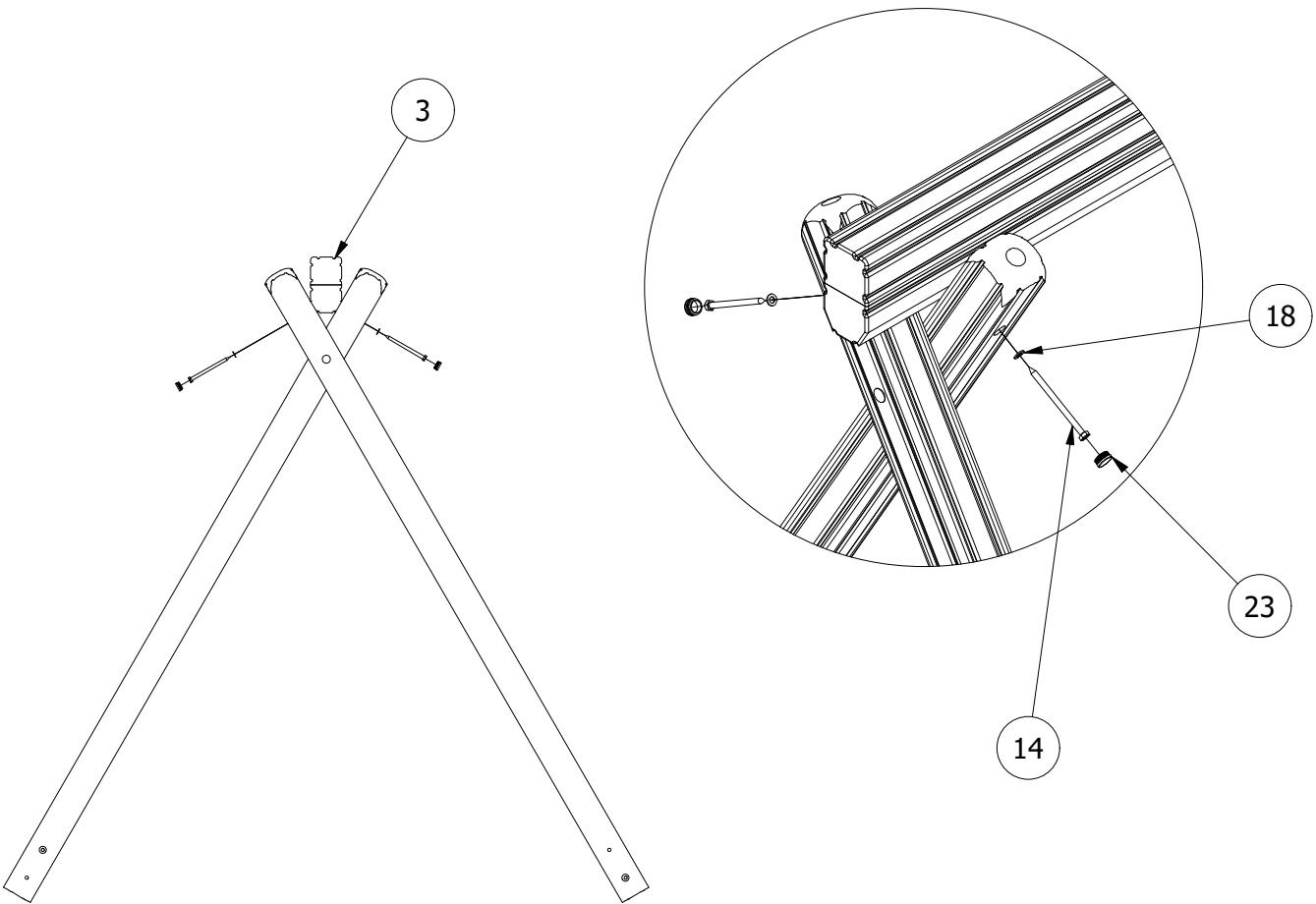

3. AS ILLUSTRATED BELOW, THE TOP CROSSBAR IS SUPPLIED IN TWO PARTS. SECURE THE TWO PARTS TOGETHER AND ATTACH BOTH END A-FRAMES.

FOR THE CENTRAL SUPPORT A-FRAME, USE THE BELOW ILLUSTRATION TO BUILD THE CENTRAL SECTION, POSITION IN PLACE AND SECURE TO THE TOP BEAM.

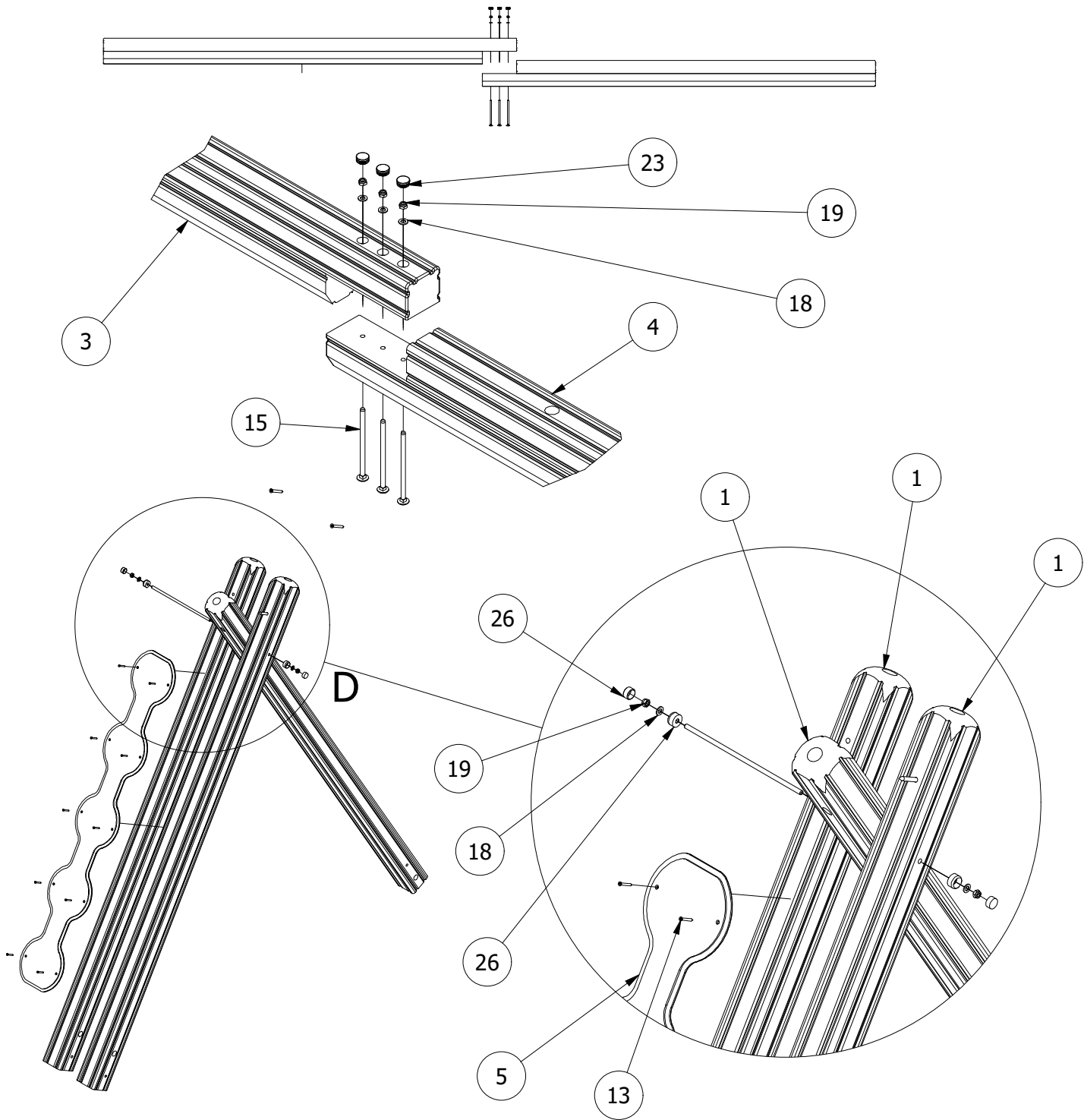

UNLESS OTHERWISE SPECIFIED:
DIMENSIONS ARE IN MILLIMETERS
TOLERANCES:
LINEAR: $\pm 2\text{MM}$
1 DECIMAL PLACE: $\pm 0.5\text{MM}$
ANGULAR: $\pm 1^\circ$

PROPRIETARY AND CONFIDENTIAL
THE INFORMATION CONTAINED IN THIS
DRAWING IS THE SOLE PROPERTY OF
FENLAND LEISURE PRODUCTS. ANY
REPRODUCTION IN PART OR AS A WHOLE
WITHOUT THE WRITTEN PERMISSION
OF FENLAND
LEISURE PRODUCTS IS PROHIBITED.

Title: PRO-500-133 BASKET & FLAT SEAT SWING_PF (MLF25)

Product Range: PLAYGROUND EQUIPMENT

Date:
25/10/2019

Page: 4

A3



DO NOT SCALE FROM DRAWING

Tel: 01354 638359 www.onlineplaygrounds.co.uk

4. AS ILLUSTRATED, SECURE THE SWING HANGER AND THE SECURITY HANGER TO THE UNDERSIDE OF THE TOP BAR (ENSURE THE SECURITY SAFETY HANGER IS SECURED ON THE OUTER SIDE)

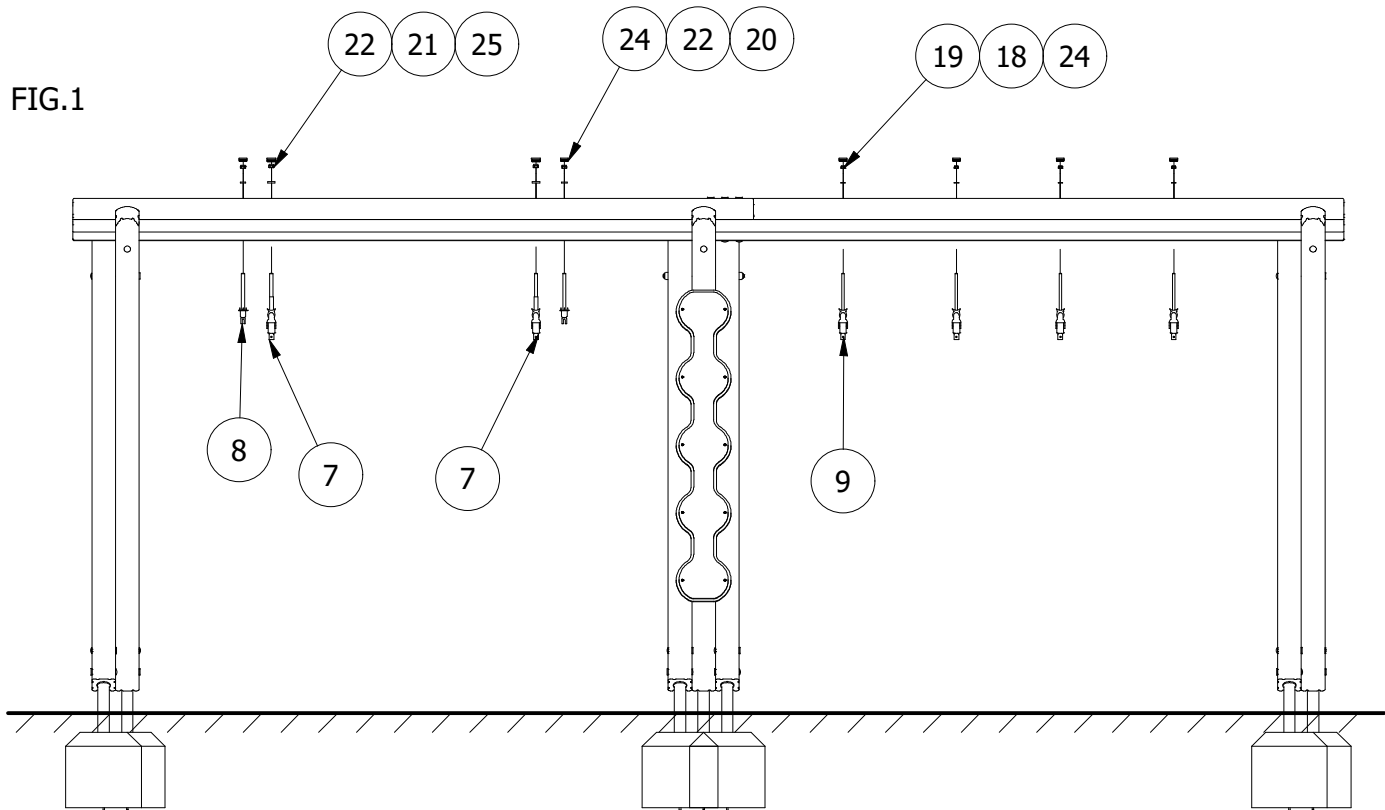

5. HANG THE BIRDS NEST SWING ATTACHING THE SWING CHAIN TO THE SWING HANGERS AND THE SECURITY CHAIN TO THE SWING CHAIN. ENSURE THE SEAT SITS A MINIMUM OF 400MM FROM FINISHED SURFACE LEVEL TO UNDERSIDE OF THE BASKET SEAT/SWING SEATS.

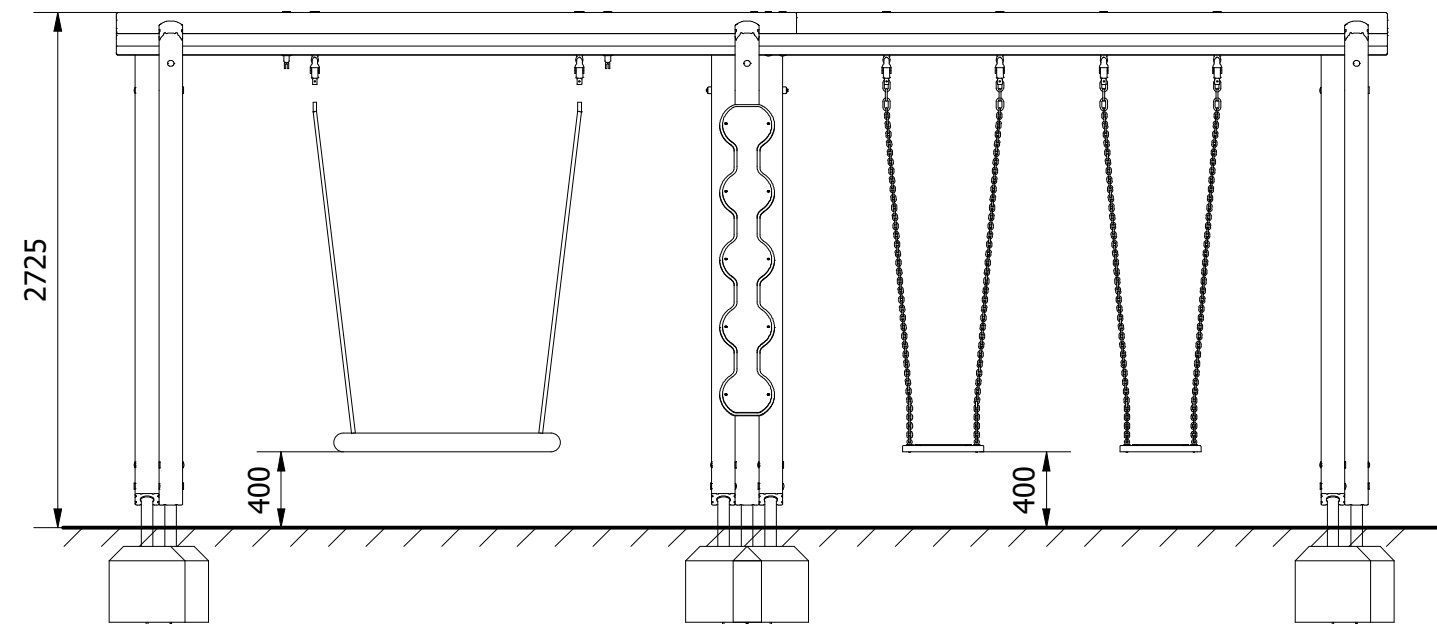

6. ALL POSTS WILL BE SUPPLIED WITH THE GROUND FOOT PRE-ATTACHED. IF NOT, PLEASE SEE THE DETAIL BELOW ON SECURING THE FOOT TO THE UNDERIDE OF THE UPRIGHT POSTS.

7. FINALLY, ENSURE UNIT IS LEVEL AND PLUMB, ALL FIXINGS HAVE BEEN TIGHTENED AND PROTECTIVE CAPS IN PLACE. ADD CONCRETE TO EACH FOUNDATION HOLE AND LEAVE FOR 48 HOURS

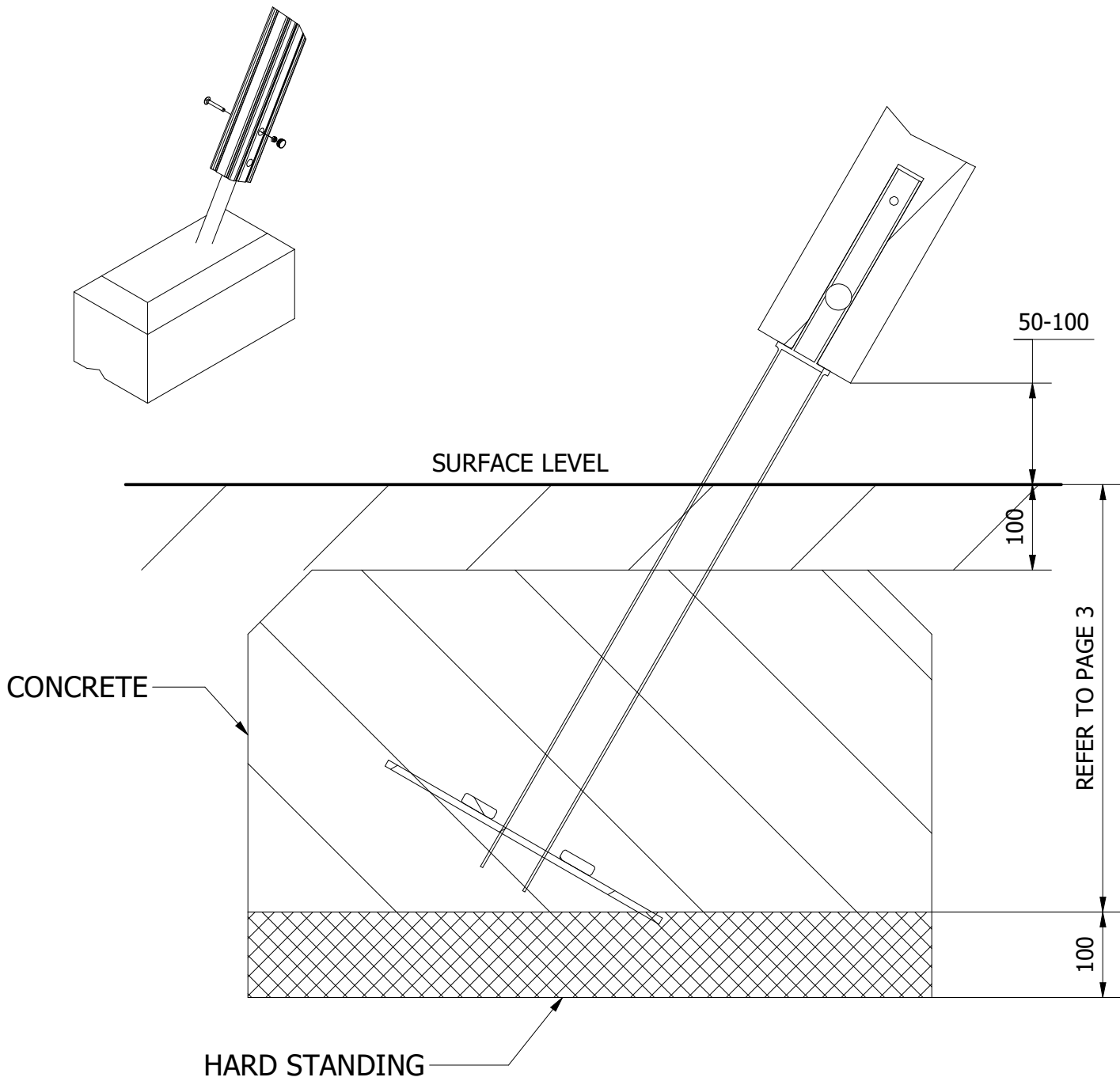

<div>UNLESS OTHERWISE SPECIFIED: DIMENSIONS ARE IN MILLIMETERS TOLERANCES: LINEAR: ±2MM 1 DECIMAL PLACE: ±0.5MM ANGULAR: ±1°</div> <div></div>	<div>PROPRIETARY AND CONFIDENTIAL</div> <div>THE INFORMATION CONTAINED IN THIS DRAWING IS THE SOLE PROPERTY OF FENLAND LEISURE PRODUCTS. ANY REPRODUCTION IN PART OR AS A WHOLE WITHOUT THE WRITTEN PERMISSION OF FENLAND LEISURE PRODUCTS IS PROHIBITED.</div>	Title: PRO-500-133 BASKET & FLAT SEAT SWING_PF (MLF25)	
		Product Range: PLAYGROUND EQUIPMENT	
			Date: 25/10/2019
			Page: 5
		DO NOT SCALE FROM DRAWING	A3
Tel: 01354 638359 www.onlineplaygrounds.co.uk			