

PARTS LIST				
ITEM	QTY	PART NUMBER	DESCRIPTION	STOCK NUMBER
1	5	TB-200-595	2900 x 125 Safalog	COMTIMSAF0001
2	2	TB-200-596	2900 x 125 Safalog	COMTIMSAF0001
3	1	TB-200-597	2 X 3.6M X 125MM SAFALOG (BONDED)	COMTIMSAF0001
4	1	TB-200-598	2 X 3.425M X 125MM SAFALOG (BONDED)	COMTIMSAF0001
5	1	PE-400-083	SWING LEG COVER	COMHDPEGNBGGN19
6	1	SWC4 FLAT	SWING CHAIN	SUBSWISTR0001
7	1	SWC4 CRADLE	SWING CHAIN	COMSWISTRA0006
8	2	SW42 SWING FITTING	UNIVERSAL SWING FITTING	COMSWIHAN0007
9	2	SW8 SECURITY BOLT	SECURITY BOLT	COMSWIHAN0009
10	4	SW29 SWING FITTING	UNIVERSAL SWING FITTING	SUBSW29
11	1	BASKET SEAT	1M BIRDS NEST SWING SEAT	COMSWISEA0007
12	1	FLAT SWING SEAT	LARGE SWING SEAT	COMSWISEA0001
13	1	CRADLE SWING SEAT	SW22 CRADLE SEAT	COMSWISEA0004
14	7	MOD-600-121 GROUND FOOT (125)	GROUND FOOT (125)	SUBSTEMIS0006
15	6	M12 X 180 COACH SCREW	M12 X 180 COACH SCREW	COMA2CSM12X180
16	3	M12 X 220 COACH BOLT	M12 X 220 (DIN 603)	COMA2CBM12X220
17	2	M12 X 240 COACH BOLT	M12 x 240 (DIN 603)	COMA2CBM12X240
18	1	M12 X 430 T-BAR	430MM THREADED BAR	COMHARTHRESTA001
19	17	M12 WASHER	M12 WASHER (DIN 125)	COMA2FWM12
20	11	M12 NYLOC NUT	M12 NYLOC NUT (DIN 985)	COMA2NNM12
21	2	M16 WASHER	M16 WASHER (DIN 125)	COMA2FWM16
22	2	M16 HDWASHER	M16 HDWASHER (DIN 7439)	COMA2HDWASM16
23	4	M16 NYLOC NUT	M16 NYLOC NUT (DIN 985)	COMA2NNM16
24	11	30MM BOLT COVER	30MM BLACK CAP	COMPLACAP0001
25	6	38MM BOLT COVER	38MM CAP	COMPLACAP0016
26	2	45MM BOLT COVER	45MM CAP	COMPLACAP0017
27	2	2 PART CAP (BLACK)	TWO PART CAP	COMPLACAP0028
28	7	400 x 800 x 400	0.128M³ CONCRETE FOUNDATION	

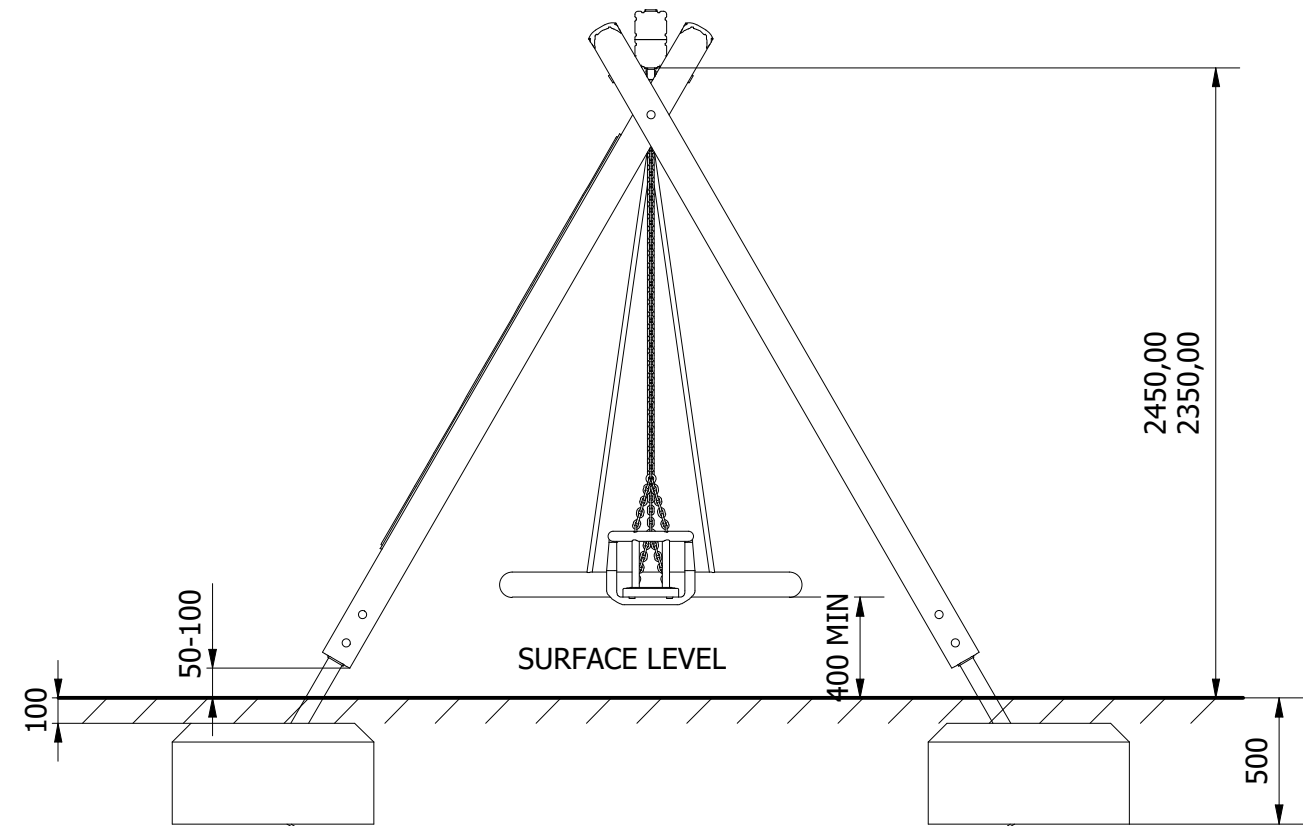

UNLESS OTHERWISE SPECIFIED:  
DIMENSIONS ARE IN MILLIMETERS  
TOLERANCES:  
LINEAR: ±2MM  
1 DECIMAL PLACE: ±0.5MM  
ANGULAR: ±1°

**PROPRIETARY AND CONFIDENTIAL**  
THE INFORMATION CONTAINED IN THIS  
DRAWING IS THE SOLE PROPERTY OF  
FENLAND LEISURE PRODUCTS. ANY  
REPRODUCTION IN PART OR AS A WHOLE  
WITHOUT THE WRITTEN PERMISSION  
OF FENLAND  
LEISURE PRODUCTS IS PROHIBITED.

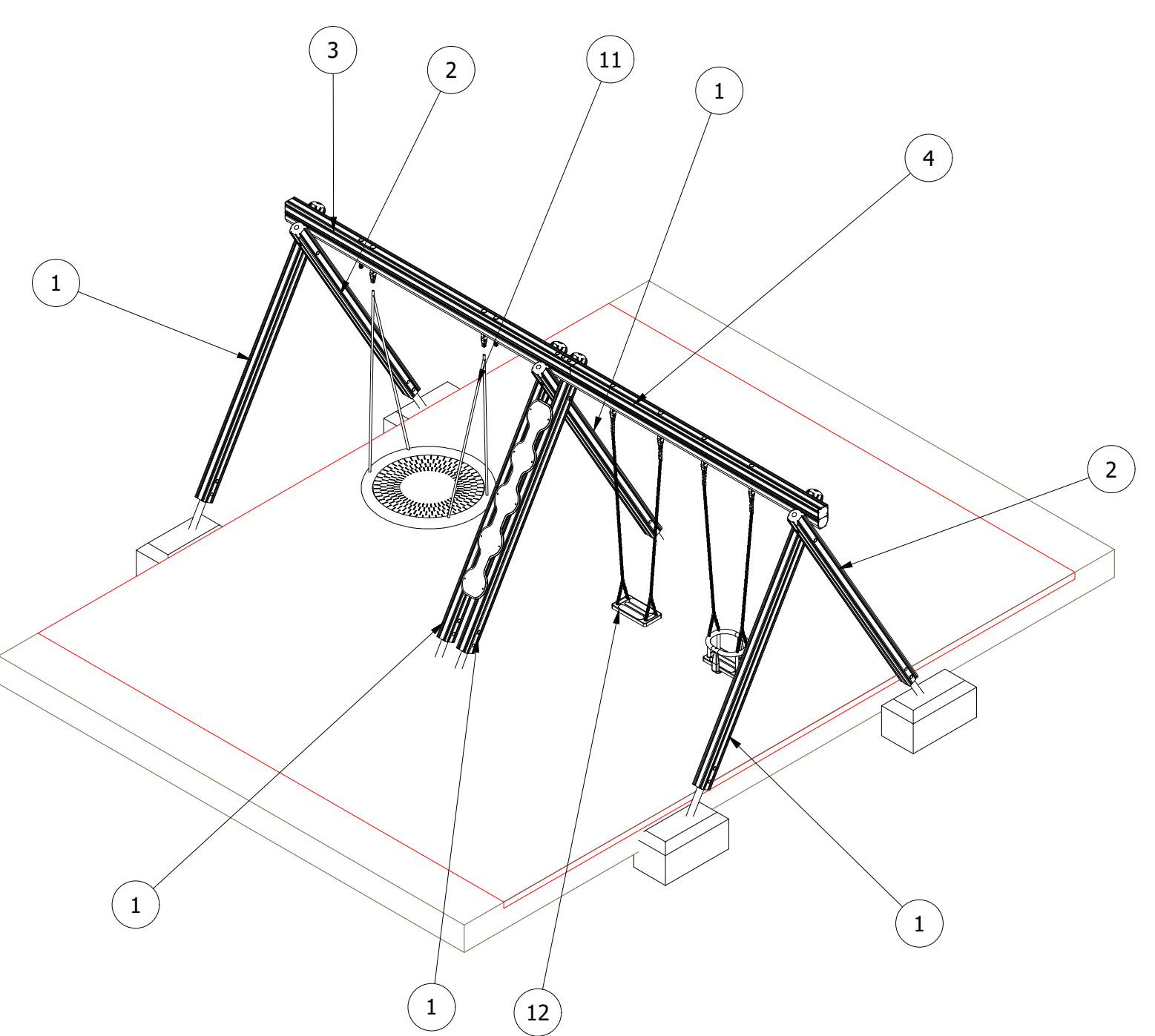

Title: PRO-500-127 BASKET & FLAT SEAT SWING (MLF25)	
Product Range: PLAYGROUND EQUIPMENT	
<1.5M FFH	Date: 16/08/2019
	Page: 1
	A3
DO NOT SCALE FROM DRAWING	
Tel: 01354 638359 www.onlineplaygrounds.co.uk	

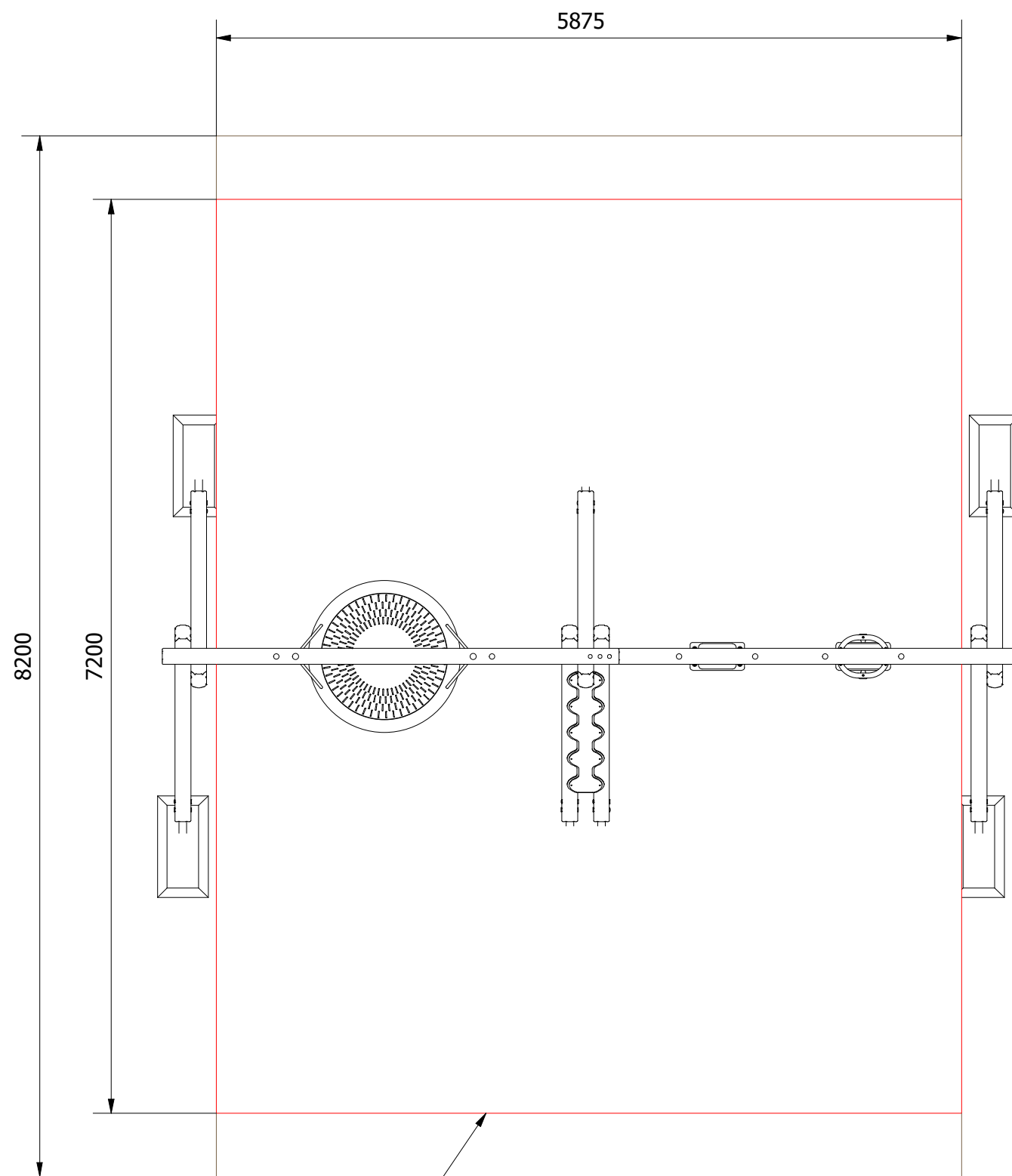

WETPOUR SURFACING  
AREA = 42.3M<sup>2</sup>  
PERIMETER = 26.2 L/M

LOOSEFILL SURFACING  
AREA = 48.2M<sup>2</sup>  
PERIMETER = 28.2 L/M

30 SAFAGRASS TILES (1.5M X 1.0M)

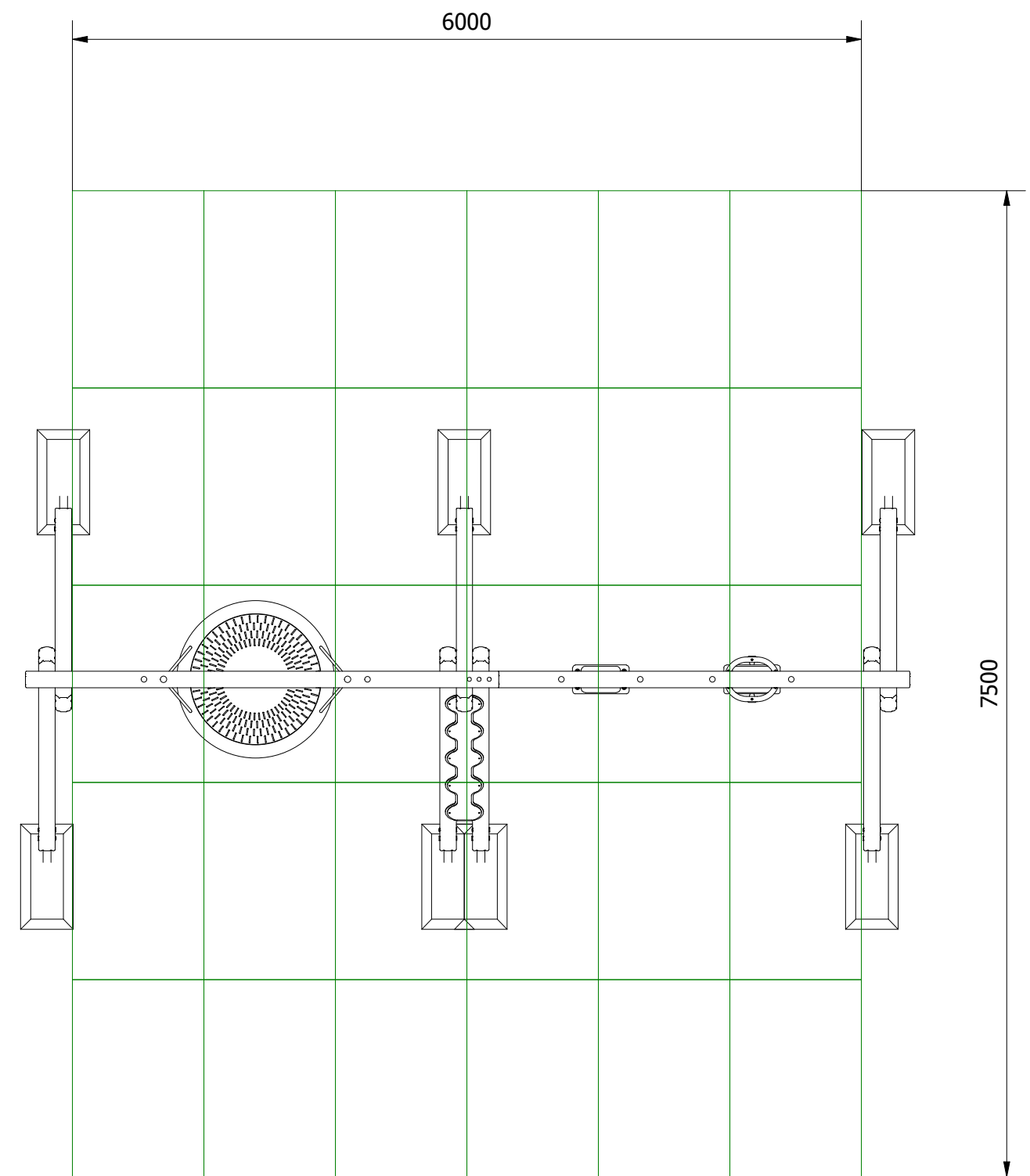

<p>UNLESS OTHERWISE SPECIFIED: DIMENSIONS ARE IN MILLIMETERS</p> <p>TOLERANCES:</p> <p>LINEAR: ±2MM</p> <p>1 DECIMAL PLACE: ±0.5MM</p> <p>ANGULAR: ±1°</p>		<p><b>PROPRIETARY AND CONFIDENTIAL</b></p> <p>THE INFORMATION CONTAINED IN THIS DRAWING IS THE SOLE PROPERTY OF FENLAND LEISURE PRODUCTS. ANY REPRODUCTION IN PART OR AS A WHOLE WITHOUT THE WRITTEN PERMISSION OF FENLAND LEISURE PRODUCTS IS PROHIBITED.</p>		<p>Title: PRO-500-127 BASKET &amp; FLAT SEAT SWING (MLF25)</p>	
				<p>Product Range: PLAYGROUND EQUIPMENT</p>	
				<p>Date: 16/08/2019</p>	
				<p>Page: 2</p>	
				<p>A3</p>	
				<p>DO NOT SCALE FROM DRAWING</p>	
				<p>Tel: 01354 638359 www.onlineplaygrounds.co.uk</p>	

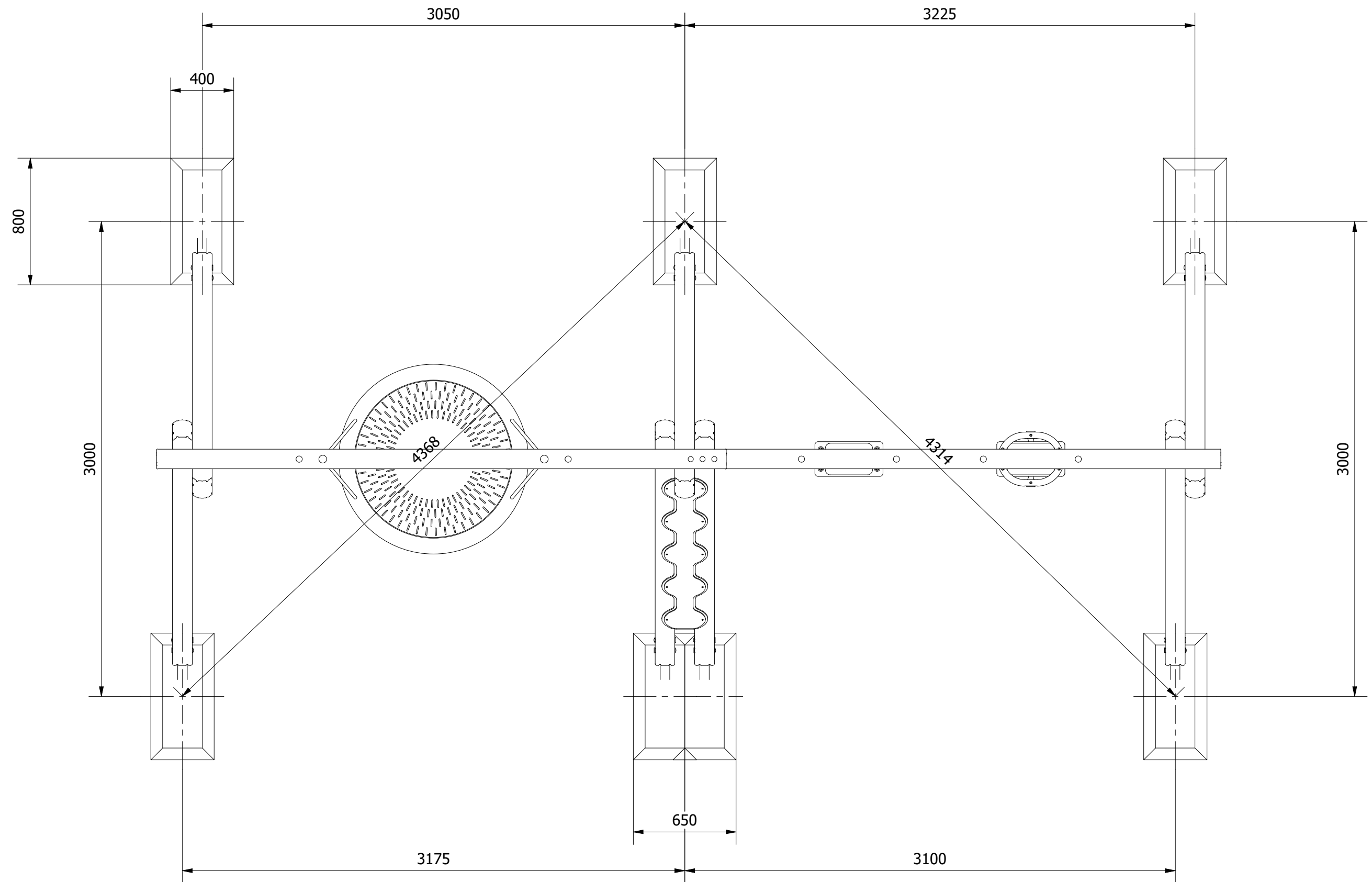

<p>UNLESS OTHERWISE SPECIFIED: DIMENSIONS ARE IN MILLIMETERS TOLERANCES:     LINEAR:           ±2MM     1 DECIMAL PLACE: ±0.5MM     ANGULAR:         ±1°</p>		<p>PROPRIETARY AND CONFIDENTIAL</p> <p>THE INFORMATION CONTAINED IN THIS DRAWING IS THE SOLE PROPERTY OF FENLAND LEISURE PRODUCTS. ANY REPRODUCTION IN PART OR AS A WHOLE WITHOUT THE WRITTEN PERMISSION OF FENLAND LEISURE PRODUCTS IS PROHIBITED.</p>		<p>Title:                    <b>PRO-500-127 BASKET &amp; FLAT SEAT SWING (MLF25)</b></p>		
<div></div>				<p>Product Range:                               <b>PLAYGROUND EQUIPMENT</b></p>		
				<p>DO NOT SCALE FROM DRAWING</p> <p>Tel: 01354 638359   www.onlineplaygrounds.co.uk</p>		
						<p>Date:</p> <p>16/08/2019</p>
						<p>Page: 3</p>
				<p>A3</p>		

ALL FOUNDATIONS 400 X 800 X 600 DEEP UNLESS OTHERWISE SPECIFIED

1. CREATE THE TWO SWING A-FRAMES USING THE SUPPLIED FIXINGS AS ILLUSTRATED BELOW.

**NOTE:** TO REDUCE THE RISK OF STEEL GALLING, USE LUBRICANT ON ALL STAINLESS STEEL FIXINGS

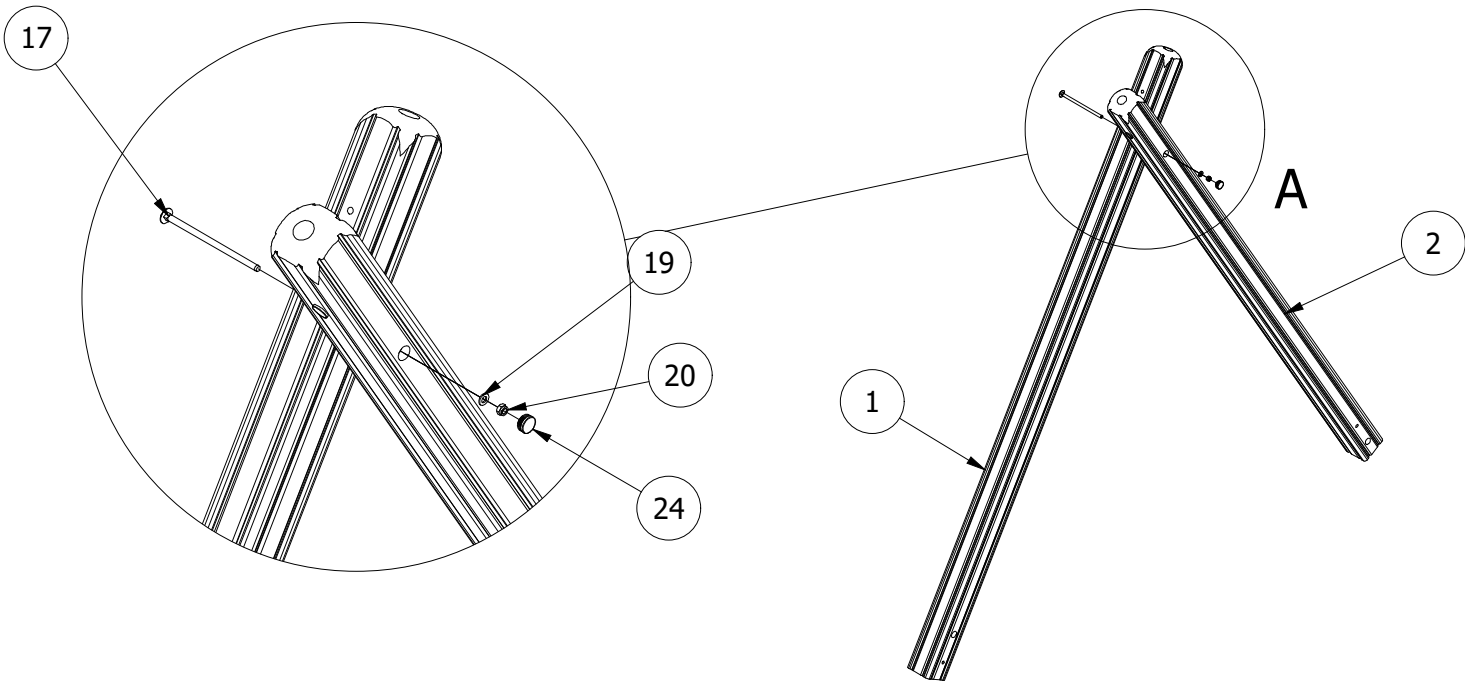

2. POSITION THE A-FRAMES INTO THE FOUNDATION HOLES AND BRACE. (TAKE NOTE OF THE POSITION OF THE POSTS AS SHOWN IN FIG 1) POSITION THE TOP BAR ONTO THE A-FRAMES AND SECURE IN PLACE.

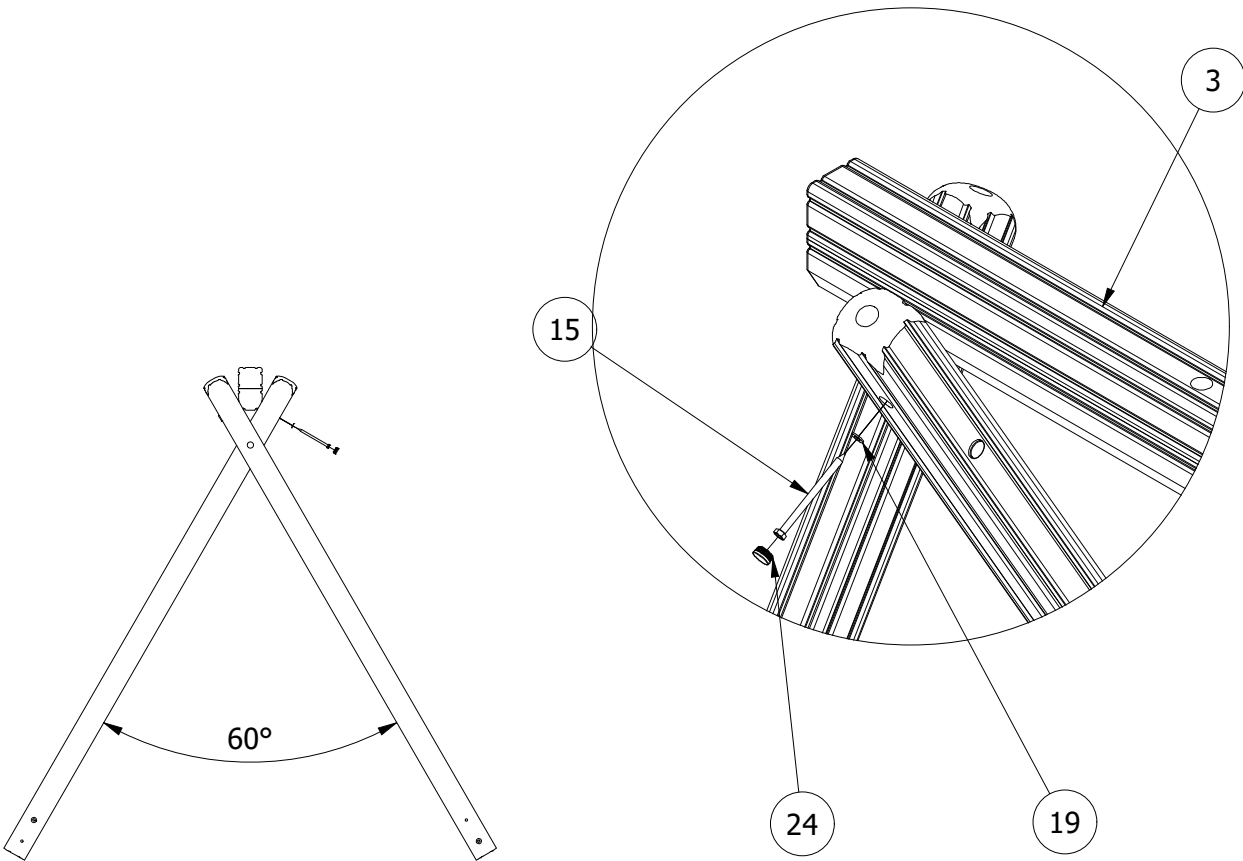

3. AS ILLUSTRATED BELOW, THE TOP CROSSBAR IS SUPPLIED IN TWO PARTS. SECURE THE TWO PARTS TOGETHER AND ATTACH BOTH END A-FRAMES.

FOR THE CENTRAL SUPPORT A-FRAME, USE THE BELOW ILLUSTRATION TO BUILD THE CENTRAL SECTION, POSITION IN PLACE AND SECURE TO THE TOP BEAM.

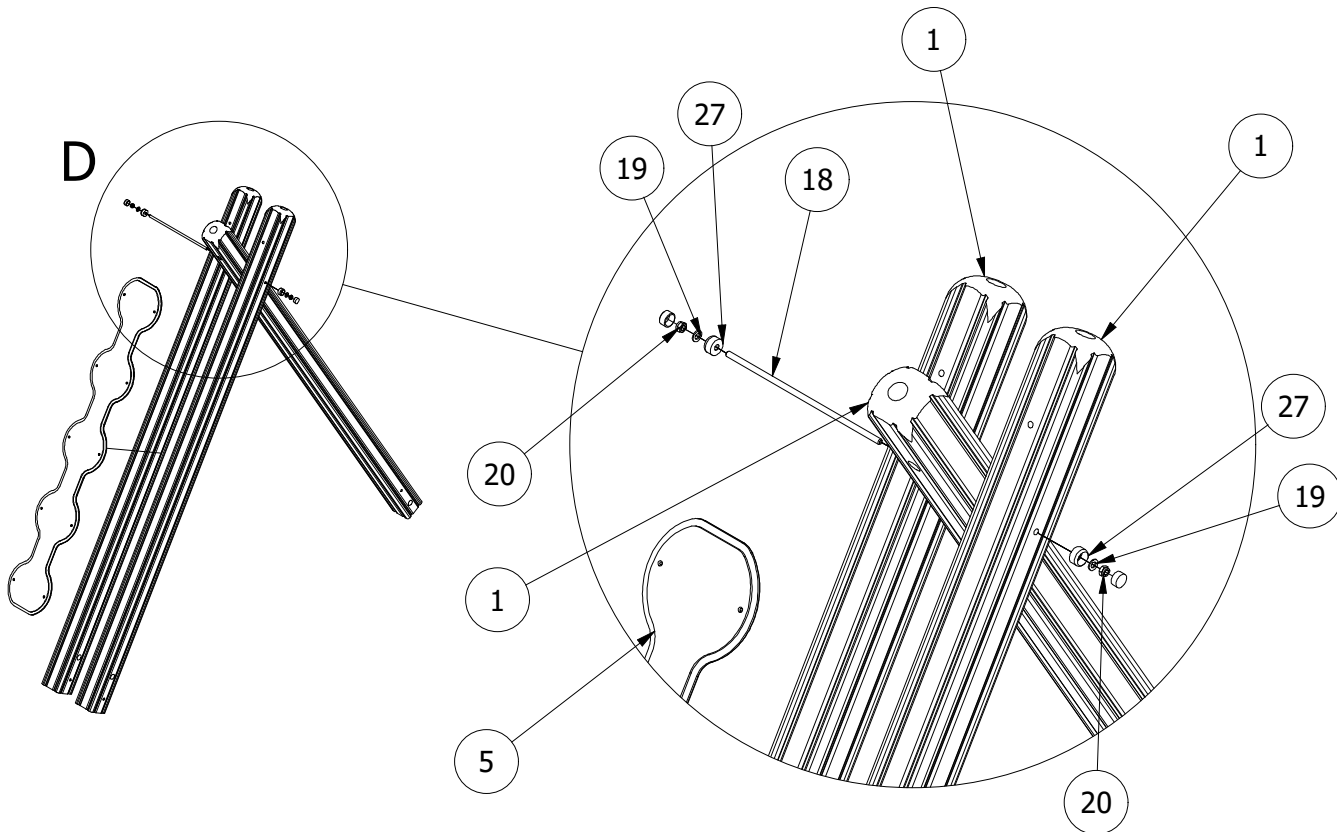
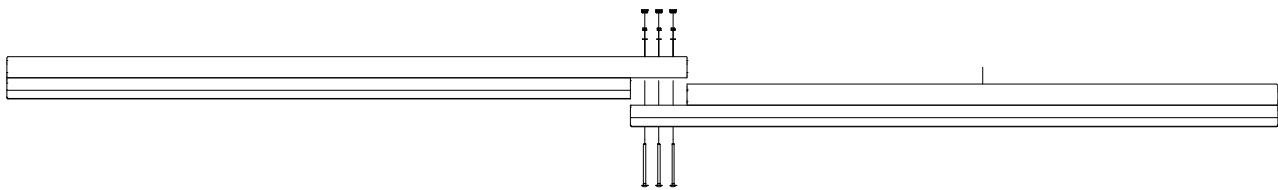

UNLESS OTHERWISE SPECIFIED:  
DIMENSIONS ARE IN MILLIMETERS  
TOLERANCES:  
LINEAR:  $\pm 2\text{MM}$   
1 DECIMAL PLACE:  $\pm 0.5\text{MM}$   
ANGULAR:  $\pm 1^\circ$

**PROPRIETARY AND CONFIDENTIAL**  
THE INFORMATION CONTAINED IN THIS  
DRAWING IS THE SOLE PROPERTY OF  
FENLAND LEISURE PRODUCTS. ANY  
REPRODUCTION IN PART OR AS A WHOLE  
WITHOUT THE WRITTEN PERMISSION  
OF FENLAND  
LEISURE PRODUCTS IS PROHIBITED.

Title: PRO-500-127 BASKET & FLAT SEAT SWING (MLF25)

Product Range: PLAYGROUND EQUIPMENT

Date:  
16/08/2019

Page: 4

A3



DO NOT SCALE FROM DRAWING

Tel: 01354 638359 www.onlineplaygrounds.co.uk

4. AS ILLUSTRATED, SECURE THE SWING HANGER AND THE SECURITY HANGER TO THE UNDERSIDE OF THE TOP BAR (ENSURE THE SECURITY SAFETY HANGER IS SECURED ON THE OUTER SIDE)

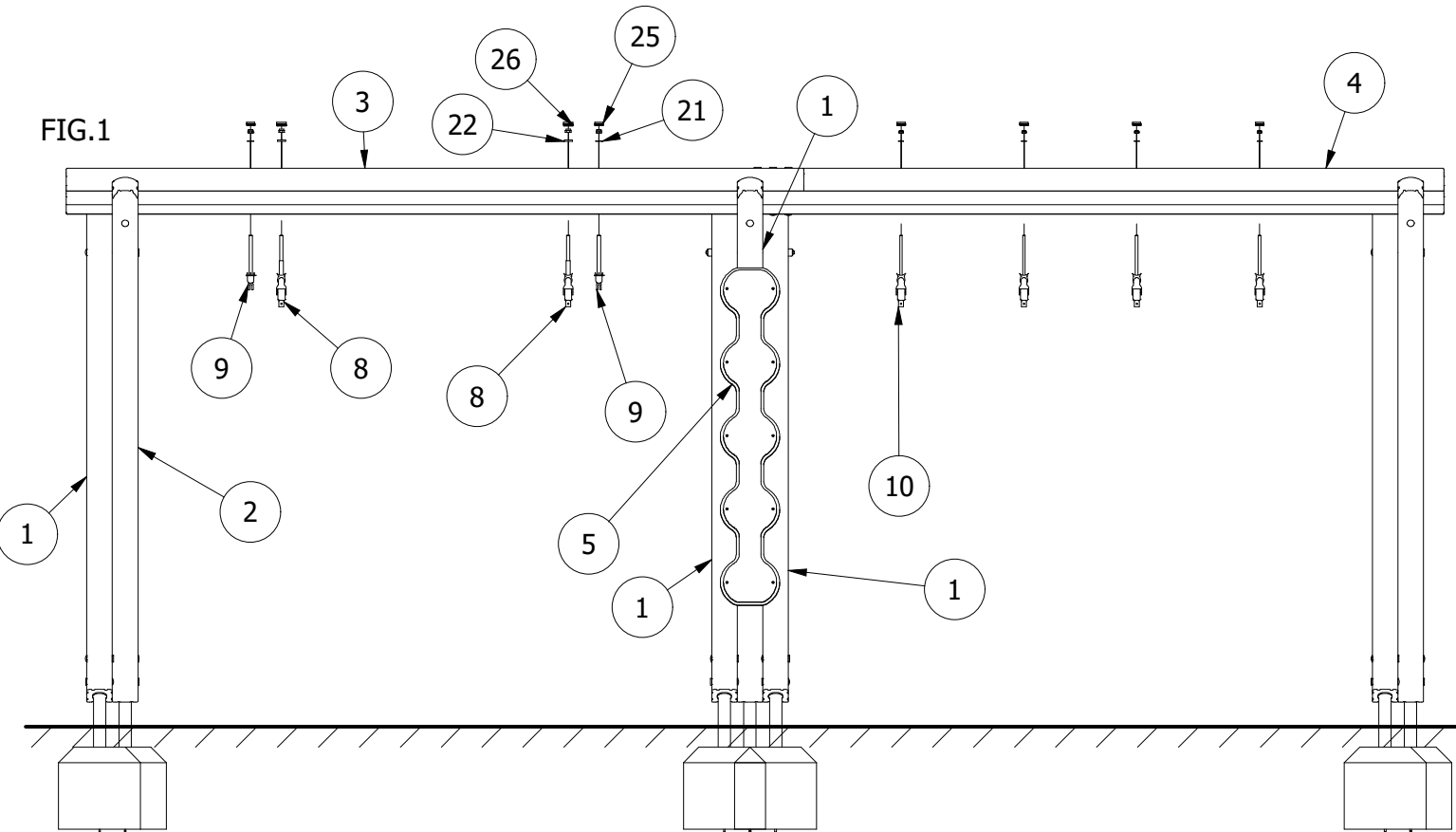

5. HANG THE BIRDS NEST SWING ATTACHING THE SWING CHAIN TO THE SWING HANGERS AND THE SECURITY CHAIN TO THE SWING CHAIN. ENSURE THE SEAT SITS A MINIMUM OF 400MM FROM FINISHED SURFACE LEVEL TO UNDERSIDE OF THE BASKET SEAT/SWING SEATS.

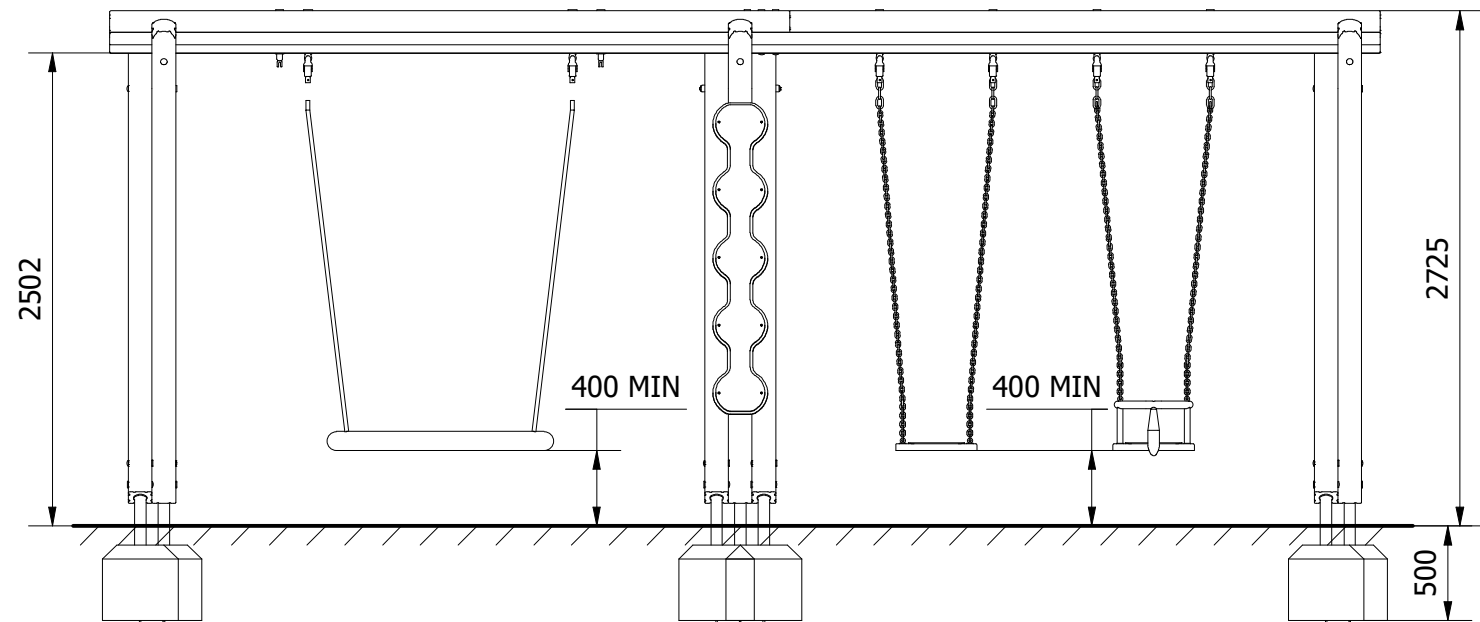

6. ALL POSTS WILL BE SUPPLIED WITH THE GROUND FOOT PRE-ATTACHED. IF NOT, PLEASE SEE THE DETAIL BELOW ON SECURING THE FOOT TO THE UNDERIDE OF THE UPRIGHT POSTS.

7. FINALLY, ENSURE UNIT IS LEVEL AND PLUMB, ALL FIXINGS HAVE BEEN TIGHTENED AND PROTECTIVE CAPS IN PLACE. ADD CONCRETE TO EACH FOUNDATION HOLE AND LEAVE FOR 48 HOURS

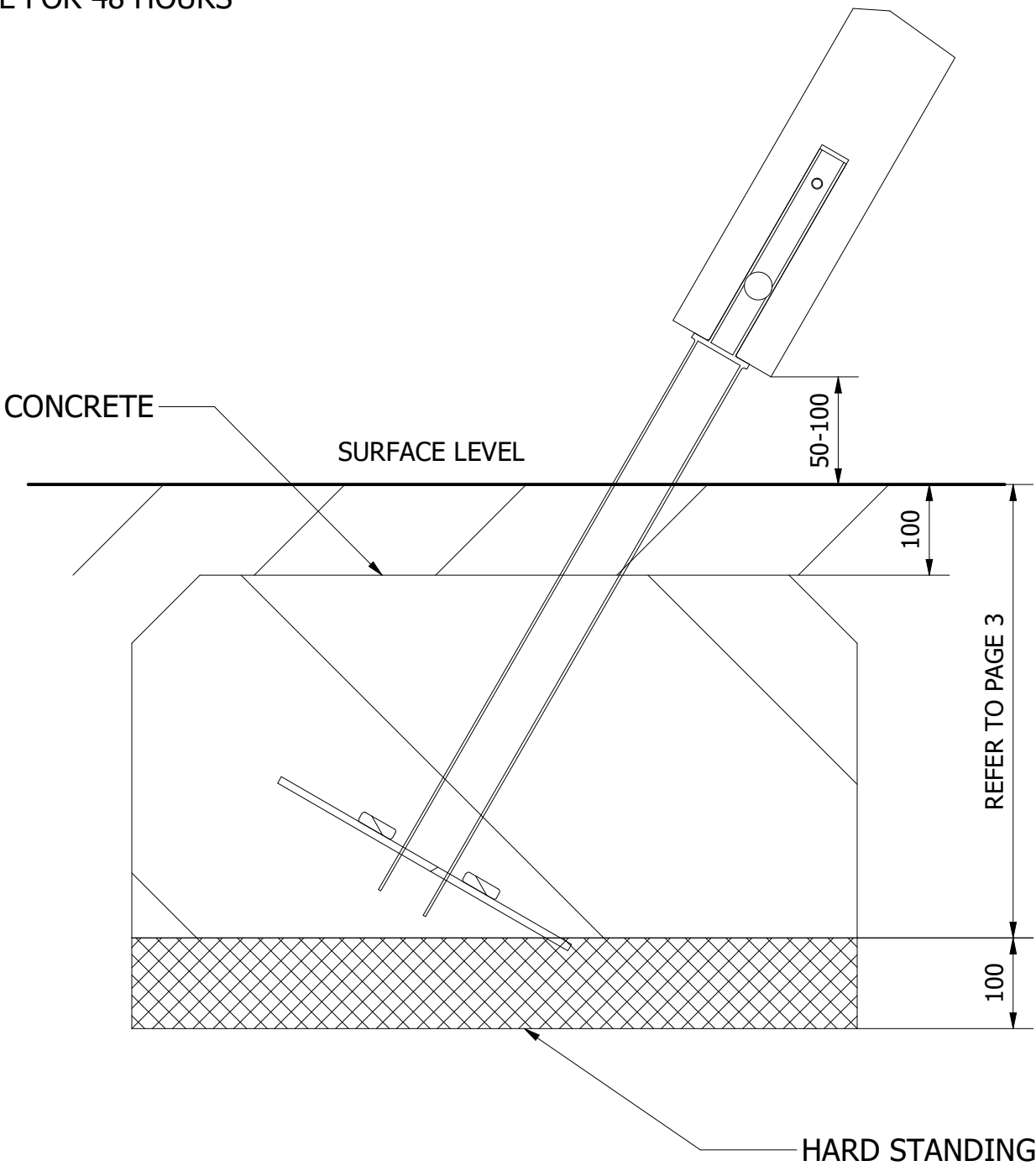

UNLESS OTHERWISE SPECIFIED:  
DIMENSIONS ARE IN MILLIMETERS  
TOLERANCES:  
LINEAR:  $\pm 2\text{MM}$   
1 DECIMAL PLACE:  $\pm 0.5\text{MM}$   
ANGULAR:  $\pm 1^\circ$

**PROPRIETARY AND CONFIDENTIAL**  
THE INFORMATION CONTAINED IN THIS  
DRAWING IS THE SOLE PROPERTY OF  
FENLAND LEISURE PRODUCTS. ANY  
REPRODUCTION IN PART OR AS A WHOLE  
WITHOUT THE WRITTEN PERMISSION  
OF FENLAND  
LEISURE PRODUCTS IS PROHIBITED.

Title: PRO-500-127 BASKET & FLAT SEAT SWING (MLF25)

Product Range: PLAYGROUND EQUIPMENT

Date:  
16/08/2019

Page: 5

DO NOT SCALE FROM DRAWING

Tel: 01354 638359 www.onlineplaygrounds.co.uk

