

PARTS LIST				
ITEM	QTY	PART NUMBER	STOCK NUMBER	DESCRIPTION
1	2	TB-200-475	COMTIMSAW0007	FRONT LEGS (550X95X45)
2	2	TB-200-476	COMTIMSAW0007	BACK LEGS (1035X95X45)
3	2	TB-200-477	COMTIMSAW0006	UNDER STORAGE SUPPORTS (600X45X55)
4	1	TB-200-478	COMTIMSAW0005	FRONT PANEL (1200X145X45)
5	2	TB-200-479	COMTIMSAW0004	SIDE PANELS (600X195X45)
6	1	TB-200-480	COMTIMSAW0004	BACK PANEL (1200X195X45)
7	5	TB-200-481	COMTIMSAW0017	STORAGE DECK & COUNTER TOP FRONT (1105X120X33)
8	2	TB-200-485	COMTIMSAW0017	COUNTERTOP SUPPORT (600X45X55)
9	1	TB-200-486	COMTIMSAW0017	COUNTERTOP BACK WITH CUTOUTS (1105X120X33)
10	2	TB-200-487	COMTIMSAW0017	BACK TOP PANELS (1200X120X33)
11	2	TB-200-488	COMTIMSAW0007	SINK BRACE (600X20X45)
12	2	TB-200-490	COMTIMSAW0017	COUNTERTOP BACK ARCH CUTOUT (1105X120X33)
13	1	TB-200-491	COMTIMSAW0017	COUNTERTOP CENTRAL SPLIT SHORT (1105X120X33)
14	1	TB-200-492	COMTIMSAW0017	COUNTERTOP CENTRAL SPLIT LONG (1105X120X33)
15	1	TB-200-494	COMTIMSAW0005	SHELF (400X145X45)
16	2	TB-200-708	COMTIMSAW0007	SHELF SUPPORT (95x95x45)
17	1	PE-400-037	COMPOL0032	HDPE GRAY/BLACK/GRAY HOB PANEL (390X390X12.5)
18	3	PE-400-038	COMPOL0006	HDPE RED/YELLOW/RED HOB RINGS (124 DIA X 12.5)
19	1	PE-400-039	COMPOL0013	WHITE/BLACK/WHITE HOB KNOB (52.5X35X19)
20	1	PE-400-040	COMPOL0017	HDPE BLACK/WHITE/BLACK CHALK BOARD (400X300X12.5)
21	1	MOD-600-059		HDPE NUMBER SLIDER
22	3		COMA2WH8X50	M8 X 50MM WASHER SCREW
23	38		COMA2WS6X70	M6 X 70MM TORX WOODSCREW
24	20		COMA2WS6X40	M6x40 Torx Woodscrew A2 Stainless Steel
25	14		COMA2WS4X70	M4x70 Torx Woodscrew A2 Stainless Steel
26	4		COMA2WS4x50	M4x50 Torx Woodscrew A2 Stainless Steel
27	1		COMA2CSMSM6X35	M6 x 35mm Counter Sunk Socket
28	1		COMHARNUT0020	M6 X 12 PIN TORX BUTTON BARREL
29	2		COMA2FWM8	M8 WASHER (DIN 125)
30	3		COMA2FWM10	M10 WASHER (DIN 125)
31	1		COMPLACAP0035	2 PART CAP (BLUE)
32	1		COMPLACAP0027	2 PART CAP (YELLOW)
33	1		COMPLACAP0009	2 PART CAP (RED)
34	1		COMSTEMIS0024	Stainless Steel Bowl 340 DIA

ANCILLARY PARTS				
ITEM	QTY	PART NUMBER	STOCK NUMBER	DESCRIPTION
35	1		COMMISC027	Chalk Pen Pack (8 PACK)

<p>UNLESS OTHERWISE SPECIFIED: DIMENSIONS ARE IN MILLIMETERS</p> <p>TOLERANCES:</p> <p>LINEAR: ±2MM</p> <p>1 DECIMAL PLACE: ±0.5MM</p> <p>ANGULAR: ±1°</p>	<p>PROPRIETARY AND CONFIDENTIAL</p> <p>THE INFORMATION CONTAINED IN THIS DRAWING IS THE SOLE PROPERTY OF FENLAND LEISURE PRODUCTS. ANY REPRODUCTION IN PART OR AS A WHOLE WITHOUT THE WRITTEN PERMISSION OF FENLAND LEISURE PRODUCTS IS PROHIBITED.</p>	<p>Title: PRO-500-069 Mud Kitchen</p>
	<p>Product Range: Playground Equipment</p>	<p>Date: 02/03/2020</p>
	<p>N/A FFH</p>	<p>Page: A3</p>
	<p>DO NOT SCALE FROM DRAWING</p>	<p>Tel: 01354 638359 Fax: 01354 638464 www.fenlandleisure.co.uk</p>



1. SECURE THE FRONT PANEL TO THE FRONT LEGS AS ILLUSTRATED BELOW TO CREATE THE FRONT FRAME.

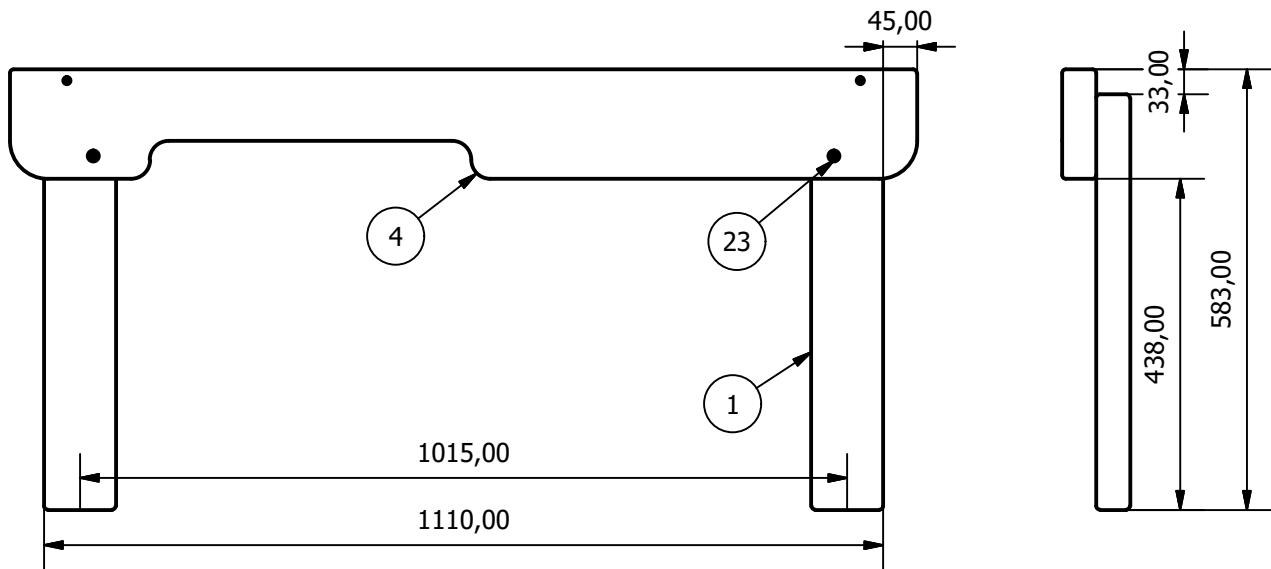

2. SECURE THE BACK PANEL AND BACK TOP PANELS TO THE BACK LEGS AS ILLUSTRATE BELOW TO CREATE THE BACK FRAME.

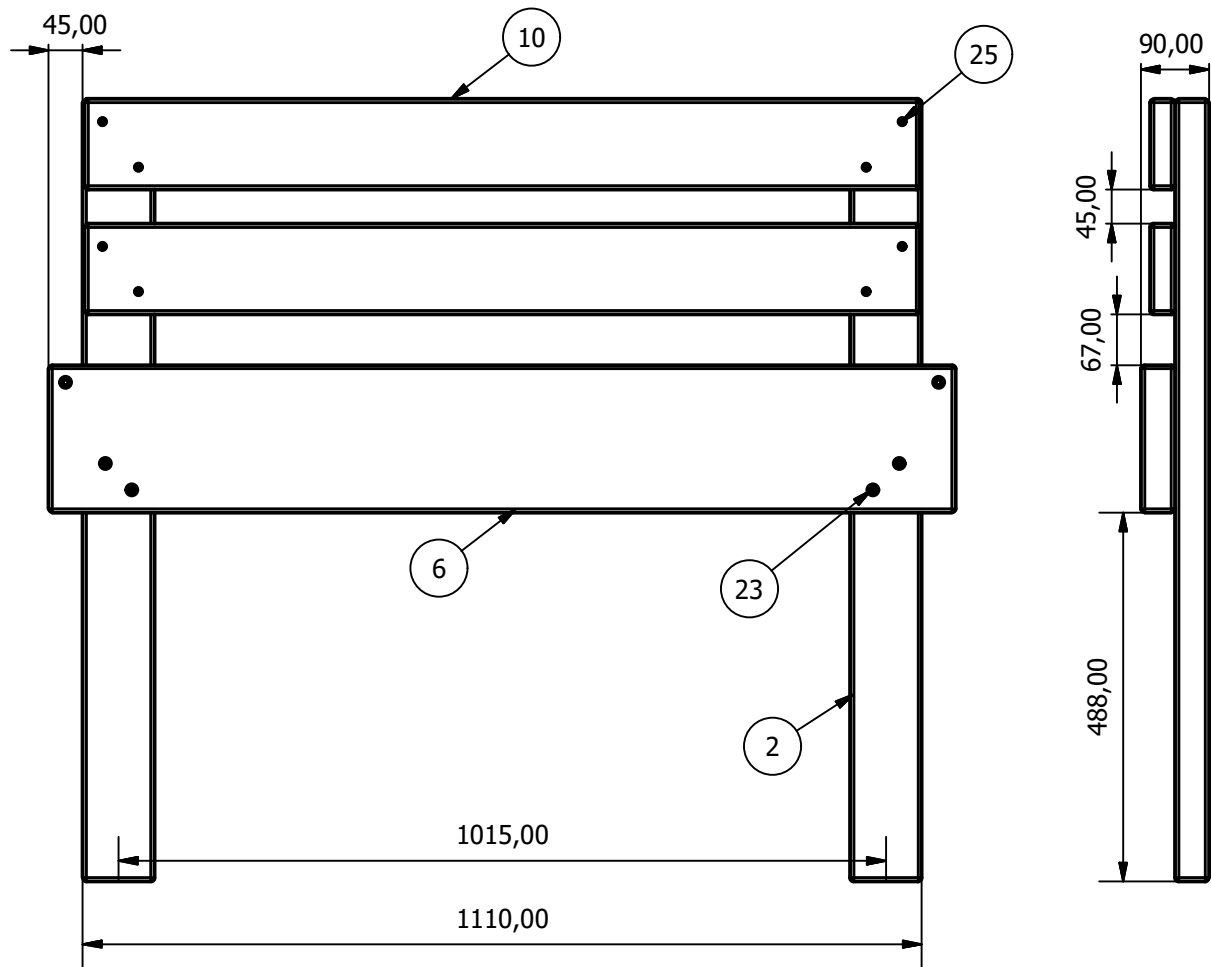

3. AS ILLUSTRATED, SECURE THE FRONT AND BACK FRAMES USING THE SIDE PANELS AND FIXINGS PROVIDED.

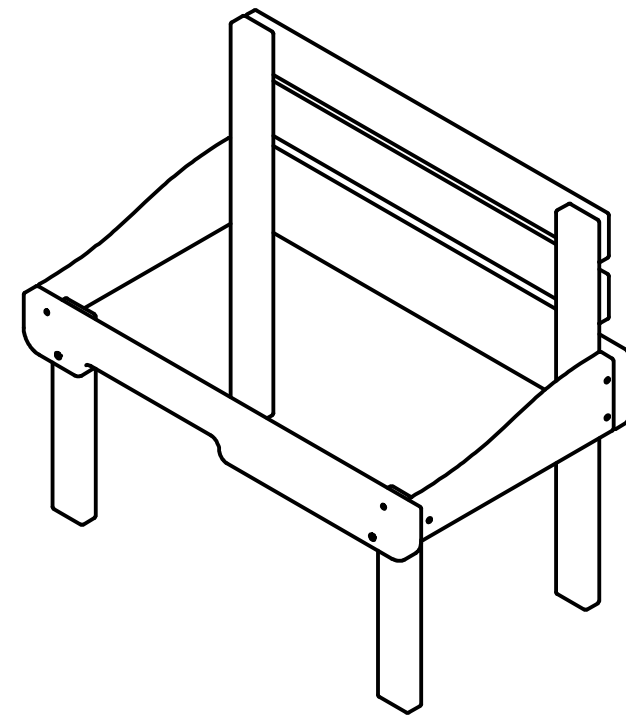
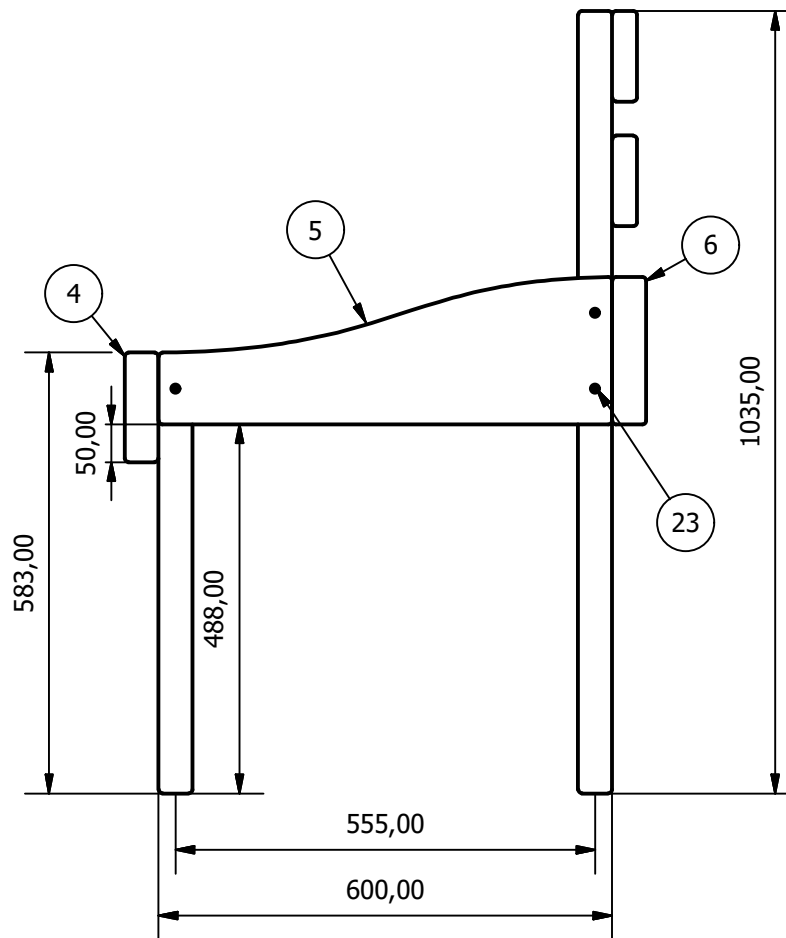

UNLESS OTHERWISE SPECIFIED:
DIMENSIONS ARE IN MILLIMETERS
TOLERANCES:
LINEAR: $\pm 2\text{MM}$
1 DECIMAL PLACE: $\pm 0.5\text{MM}$
ANGULAR: $\pm 1^\circ$

PROPRIETARY AND CONFIDENTIAL
THE INFORMATION CONTAINED IN THIS
DRAWING IS THE SOLE PROPERTY OF
FENLAND LEISURE PRODUCTS. ANY
REPRODUCTION IN PART OR AS A WHOLE
WITHOUT THE WRITTEN PERMISSION
OF FENLAND
LEISURE PRODUCTS IS PROHIBITED.

Title: PRO-500-069 Mud Kitchen

Product Range: Playground Equipment

Date:
02/03/2020

Page:

A3

DO NOT SCALE FROM DRAWING

Tel: 01354 638359 Fax: 01354 638464 www.fenandleisure.co.uk



4. AS ILLUSTRATED BELOW SECURE THE UNDER STORAGE SUPPORTS AND THE COUNTERTOP SUPPORTS USING THE FIXINGS PROVIDED.

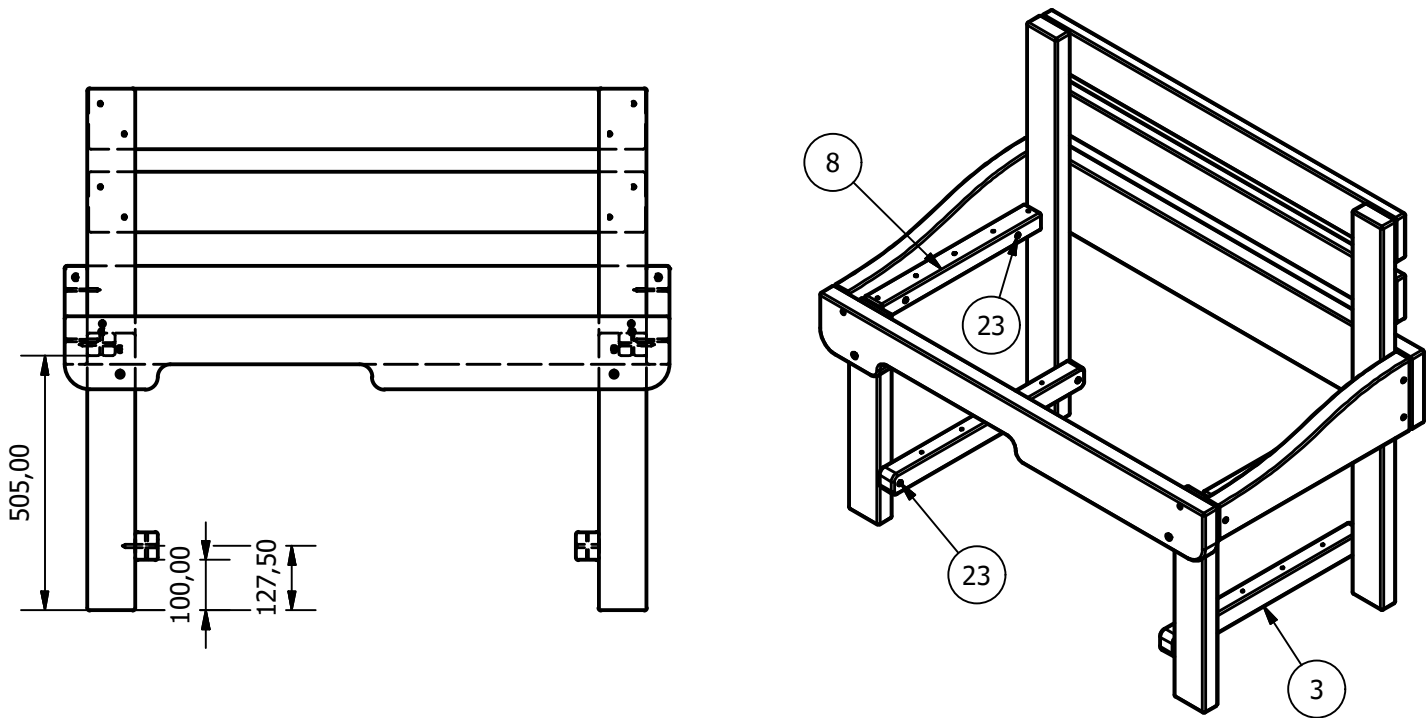

5. WITH THE SUPPORTS SECURE POSITION AND SECURE THE COUNTERTOP AND UNDERSTORAGE AS ILLUSTRATED BELOW.

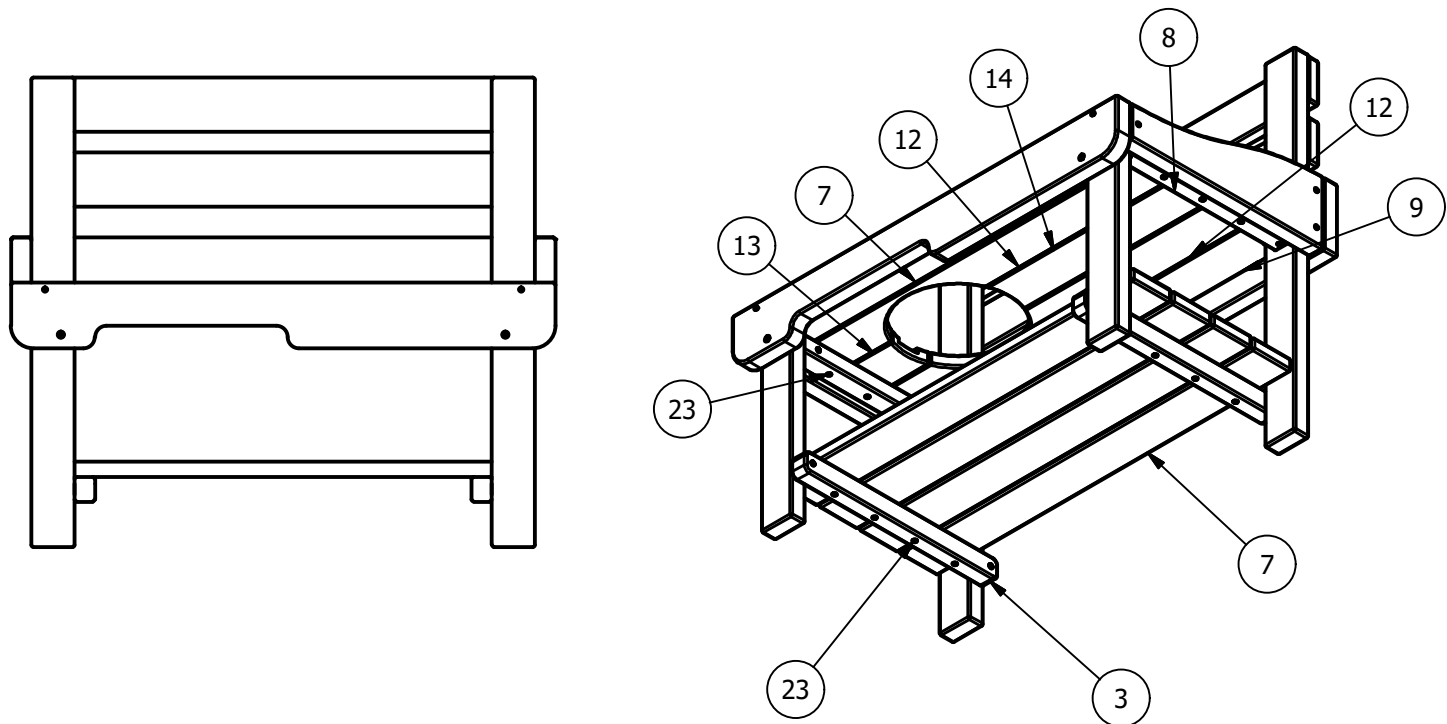

6. WITH THE COUNTER TOP TIMBERS SECURED IN POSITION, SECURE THE SINK BRACES AS SHOWN BELOW.

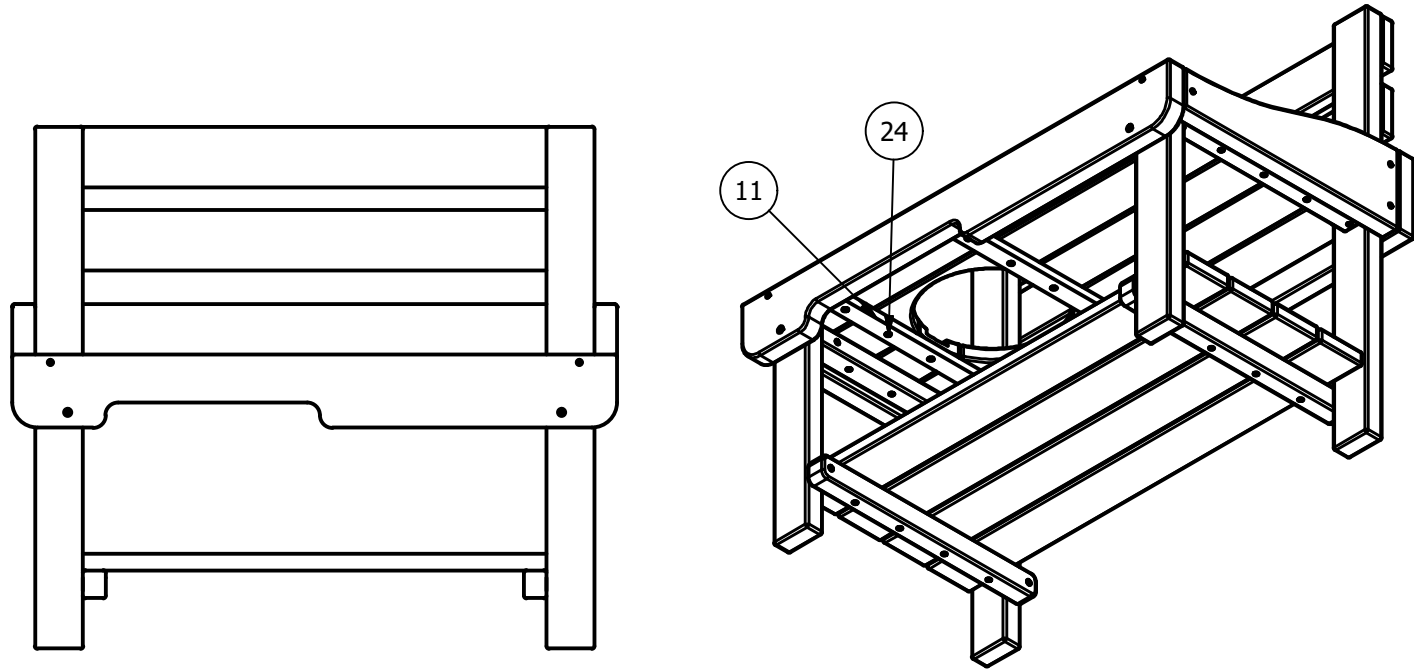

7. REMOVE THE OP BACK PANEL AND POSITION THE SHELF AS ILLUSTRATED BELOW. SECURE THE SHELF USING THE FIXINGS PROVIDED AND THEN RECONNECT THE TOP BACK PANEL.

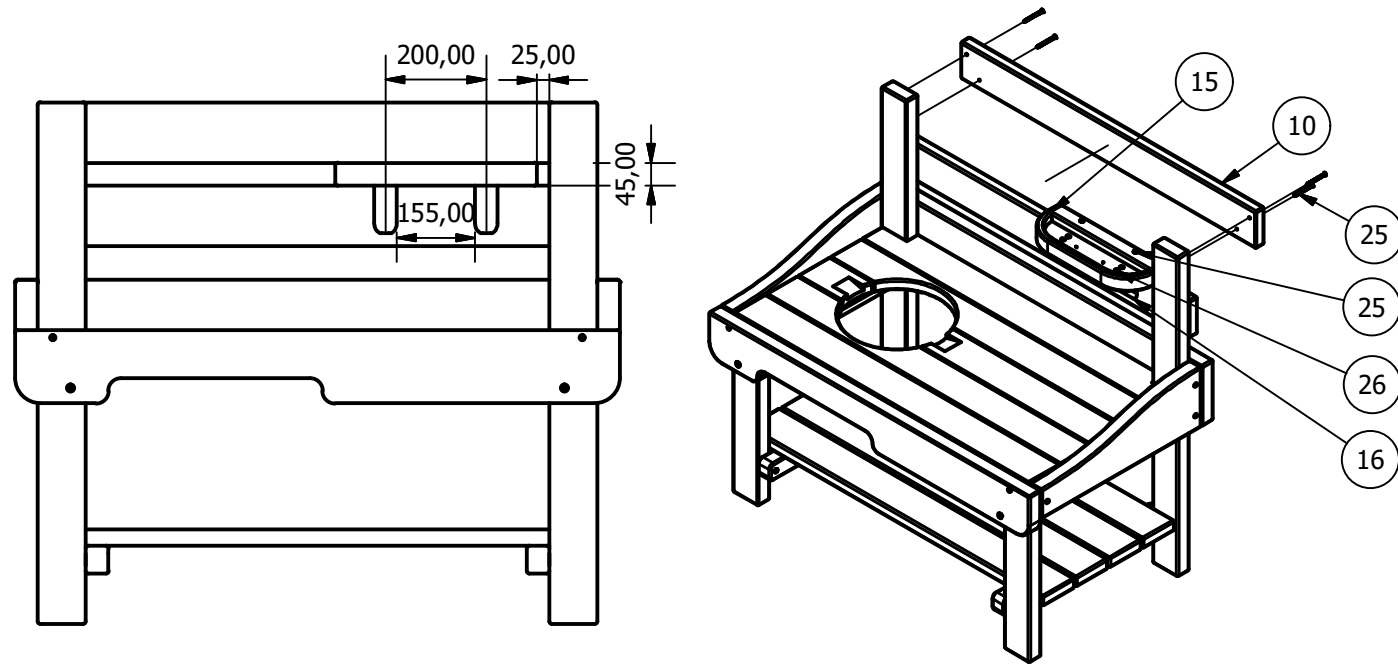

UNLESS OTHERWISE SPECIFIED:
DIMENSIONS ARE IN MILLIMETERS
TOLERANCES:
LINEAR: $\pm 2\text{MM}$
1 DECIMAL PLACE: $\pm 0.5\text{MM}$
ANGULAR: $\pm 1^\circ$

PROPRIETARY AND CONFIDENTIAL

THE INFORMATION CONTAINED IN THIS
DRAWING IS THE SOLE PROPERTY OF
FENLAND LEISURE PRODUCTS. ANY
REPRODUCTION IN PART OR AS A WHOLE
WITHOUT THE WRITTEN PERMISSION
OF FENLAND
LEISURE PRODUCTS IS PROHIBITED.

Title: PRO-500-069 Mud Kitchen

Product Range: Playground Equipment

Date:
02/03/2020

Page:

A3

DO NOT SCALE FROM DRAWING

Tel: 01354 638359 Fax: 01354 638464 www.fenandleisure.co.uk



8. POSITION THE HDPE CHALK BOARD AS SHOWN BELOW AND SECURE USING THE FIXINGS PROVIDED.

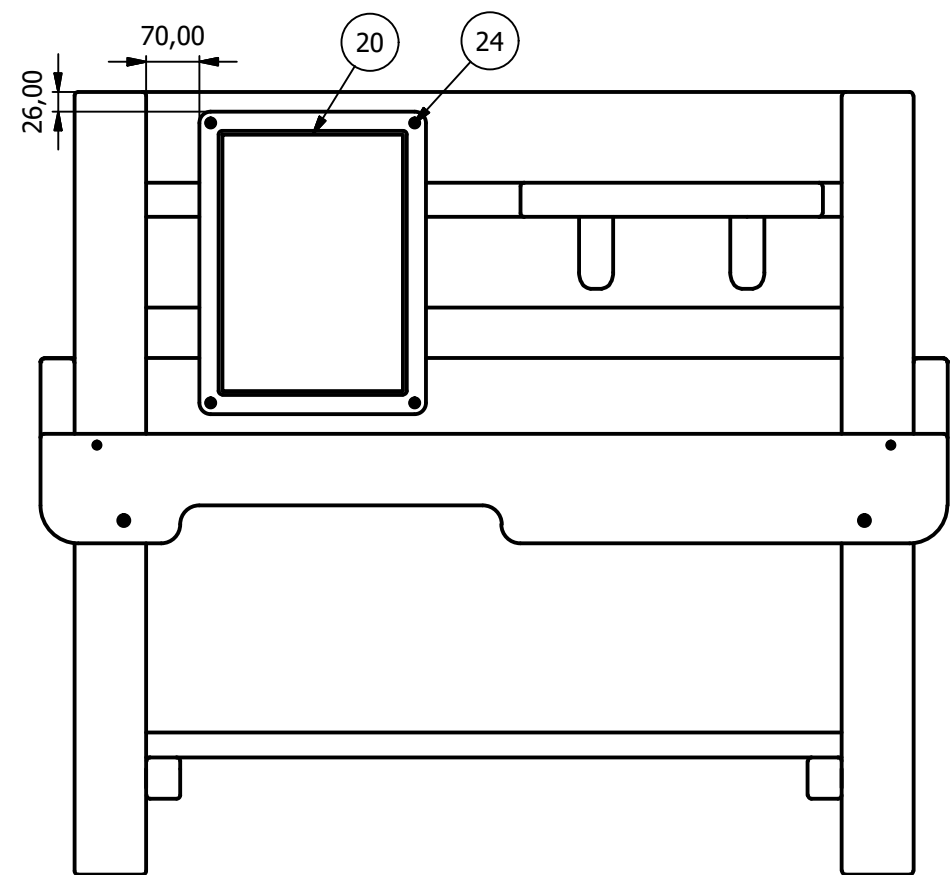

9. POSITION THE HOB AS SHOWN BELOW AND SECURE USING THE FIXINGS PROVIDED. ENSURE THE HOB KNOB FIXINGS HAVE ENOUGH SPACE BEHIND THE HDPE PANEL. A COUNTER BOAR HOLE MAY BE REQUIRED.

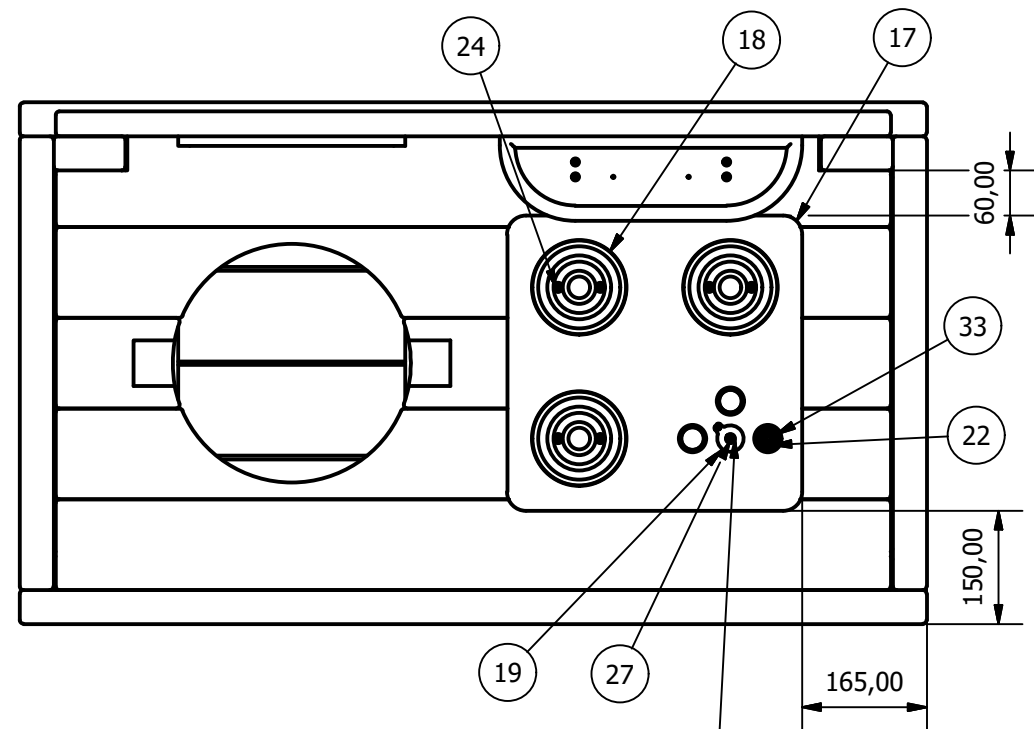

LOCK TIGHT REQUIRED TO ENSURE PARTS STAY CONNECTED WHILE IN USE.

10. POSITION THE HDPE NUMBER SLIDER ON THE FRONT PANEL AS SHOWN BELOW AND SECURE USING THE FIXINGS PROVIDED.

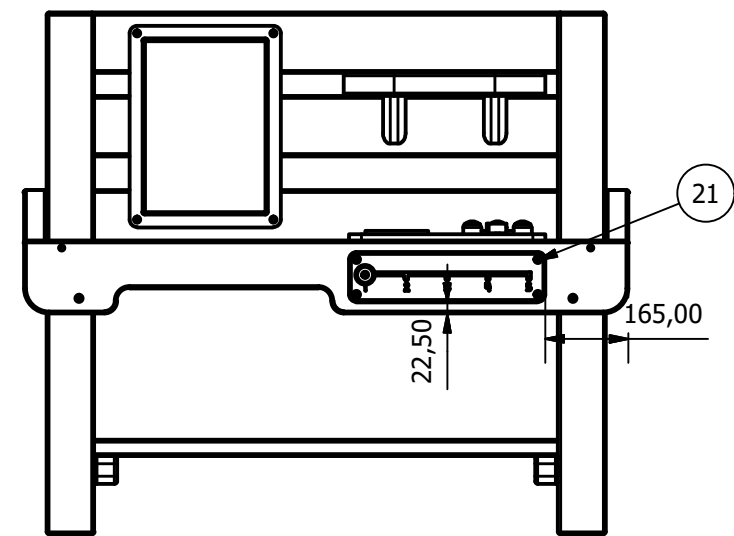

11. INSERT THE STAINLESS STEEL BOWL INTO THE SINK OPENING. ENSURE ALL SCREWS ARE SECURE AND NOT SITTING PROUD. ENSURE THE LEGS SIT LEVEL AND THE UNIT STANDS STABLE. FINALLY ENSURE ALL MOVING PARTS CAN MOVE AND ARE FREE FROM OBSTRUCTION.

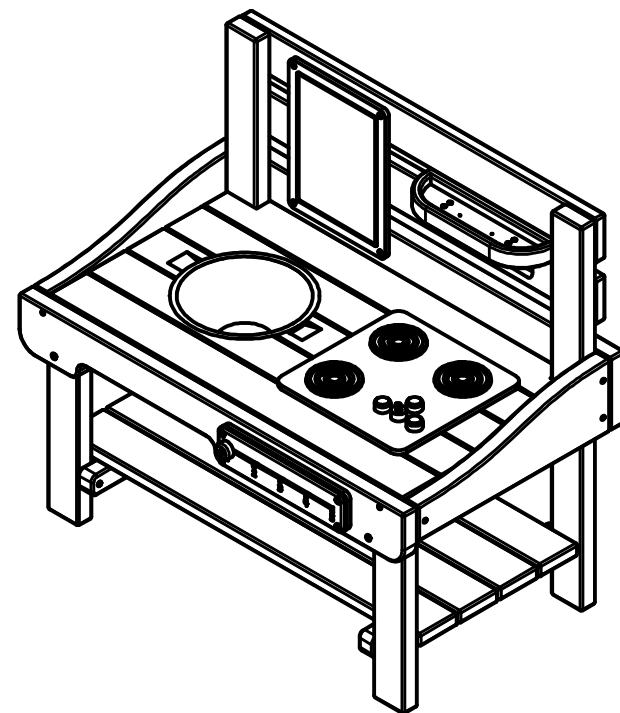

<div>UNLESS OTHERWISE SPECIFIED: DIMENSIONS ARE IN MILLIMETERS TOLERANCES: LINEAR: ±2MM 1 DECIMAL PLACE: ±0.5MM ANGULAR: ±1°</div> <div> imagination comes to life fenland leisure products</div>	PROPRIETARY AND CONFIDENTIAL THE INFORMATION CONTAINED IN THIS DRAWING IS THE SOLE PROPERTY OF FENLAND LEISURE PRODUCTS. ANY REPRODUCTION IN PART OR AS A WHOLE WITHOUT THE WRITTEN PERMISSION OF FENLAND LEISURE PRODUCTS IS PROHIBITED.		Title: PRO-500-069 Mud Kitchen	
	Product Range: Playground Equipment		Date: 02/03/2020	
	DO NOT SCALE FROM DRAWING		Page: A3	
	Tel: 01354 638359 Fax: 01354 638464 www.fenandleisure.co.uk			